

# 05015SS

## DC Axial Fan Sleeve Bearing

50<sup>□</sup>X15<sup>L</sup>

DC FAN

General purpose

Industrial

Server

Refrigerator

Blower

### General Specifications

Motor Protection : Auto Restart / Polarity Protection

Insulation Resistance : 10MΩ or over with a DC500V Megger

Dielectric Withstand Voltage : AC700V 1s

Allowable Ambient : -10°C ~ +70°C (Operating)

Temperature Range : -40°C ~ +70°C (Storage)  
non-condensing environment



### Outline

### Expected Life

※ Failure Rate: 10% (L10 Life)

40°C 40,000 (Hours)

### Panel Out-cuts

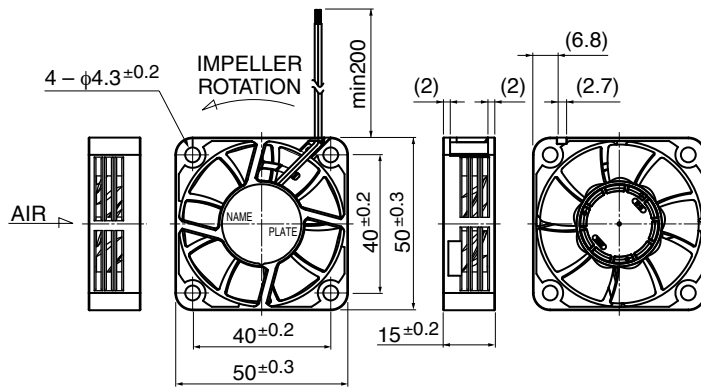

(Outlet Side)

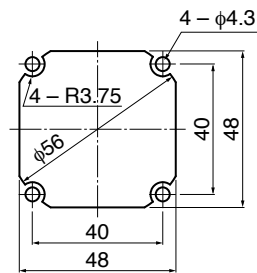

### Characteristic Curves

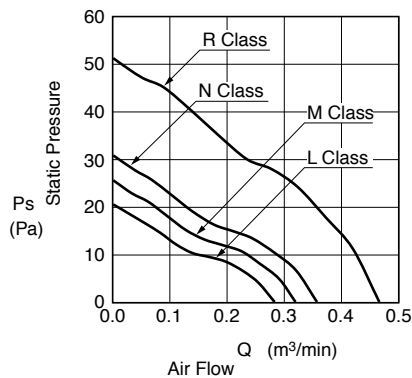

### Material

Casing : Plastic (Black) UL94V-0  
Impeller : Plastic (Black) UL94V-0  
Bearing : Sleeve Bearing  
Lead Wire : UL1061 AWG26 + : Red, - : Black

### Specifications

Model	Product No.	Rating Voltage	Operating Voltage	Current	Input Power	Speed	Max. Air Flow		Max. Static Pressure		Noise	Mass
		(V)	(V)	(A)*1	(W)*1	(min <sup>-1</sup> )*1	(m <sup>3</sup> /min)*1	(CFM)*1	(Pa)*1	(In H <sub>2</sub> O)*1	(dB)*1	(g)
05015SS-12L-WA-	D0	12	6.0 ~ 13.8	0.05	0.60	4050	0.25	8.8	20.0	0.08	22.0	25
05015SS-12M-WA-	D0			0.06	0.72	4550	0.28	9.9	25.0	0.10	25.0	
05015SS-12N-WA-	D0			0.07	0.84	5050	0.31	10.9	31.0	0.12	27.5	
05015SS-12R-WA-	D0			0.14	1.68	6550	0.42	14.8	51.0	0.20	35.5	
05015SS-24L-WA-	D0	24	12.0 ~ 26.4	0.035	0.84	4050	0.25	8.8	20.0	0.08	22.0	
05015SS-24M-WA-	D0			0.04	0.96	4550	0.28	9.9	25.0	0.10	25.0	
05015SS-24N-WA-	D0			0.05	1.20	5050	0.31	10.9	31.0	0.12	27.5	
05015SS-24R-WA-	D0			0.09	2.16	6550	0.42	14.8	51.0	0.20	35.5	

Rotation: Counter clockwise as seen from the label side  
Airflow Outlet: Label side

\*1: Average Values in Free Air