

INNER WALLS ARE CONED OVER BASE AND COVER FOR EXCELLENT RIGIDITY

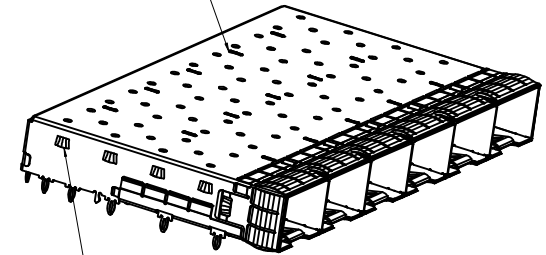

TABS USED TO MOUNT LIGHT PIPE COVER

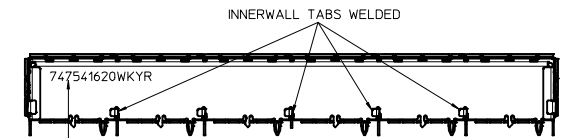
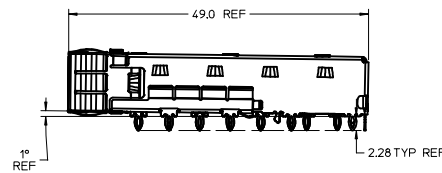
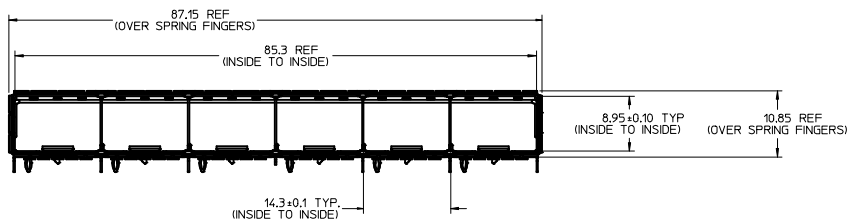

PART NO. AND WEEK/YEAR DATE CODE TO BE PRINTED IN APPROXIMATE AREA SHOWN:
 DATE CODE:
 WK = WEEK OF THE YEAR 01 THROUGH 52 (OR 53)
 YR = LAST TWO DIGITS OF THE YEAR (EXAMPLE 2013 = 13)

NOTES:

- MATERIAL:
 CAGE: NICKEL PLATED COPPER ALLOY, THICKNESS 0.25mm
 SPRING FINGERS: NICKEL PLATED COPPER ALLOY, THICKNESS 0.10mm
- PRESS FIT LEGS 2.28mm [.090 INCH] LONG
 1.57mm [.062 INCH] MINIMUM PCB THICKNESS FOR SINGLE SIDED USE
 2.28mm [.090 INCH] MINIMUM PCB THICKNESS FOR BELLY TO BELLY USE
- OPTIONAL LIGHT PIPE ASSEMBLY AVAILABLE
- PORTS ARE DESIGNED FOR SFP+ TRANSCEIVERS AND ARE COMPATIBLE WITH SFP TRANSCEIVERS
- RoHS COMPLIANT, NO EXEMPTIONS.
- WELD SPOTS MAY SHOW SLIGHT MATERIAL DISCOLORATION

| | | | | | | |
|---|-----------------|--|------------------------|------------------|---|------------------------|
| SEE REVISION TABLE IEC NO: CPG2013-2925 DRAWN BY: DRWNSYANG16 CHECKED BY: CHYKORCHEN08 APPROVED BY: APPR:KLLOYD DATE: 2013/03/22 DATE: 2013/04/09 DATE: 2013/04/15 | QUALITY SYMBOLS | GENERAL TOLERANCES (UNLESS SPECIFIED) | DIMENSION STYLE | SCALE | DESIGN UNITS | THIRD ANGLE PROJECTION |
| | ▽=0 | mm INCH | MM ONLY | 2.5:1 | METRIC | |
| | ▽=0 | 4 PLACES ± --- ± --- | | | | |
| | ▽=0 | 3 PLACES ± --- ± --- | | | | |
| | | ANGULAR ± 1 ° | DRAWN BY: RCHEN08 | DATE: 2013/01/25 | TITLE: SFP+ 1X6 GANGED PCI CAGE W/ .090" PRESS-FIT LEGS, SPR FINGERS, LT PIPE OPT | |
| | | DRAFT WHERE APPLICABLE MUST REMAIN WITHIN DIMENSIONS | CHECKED BY: MAJOHNSTON | DATE: 2013/01/30 | DOCUMENT NO: SD-74754-1620 | |
| | | | APPROVED BY: KLLOYD | DATE: 2013/01/30 | SHEET NO: 1 OF 5 | |
| | | | MATERIAL NO: 747541620 | | THIS DRAWING CONTAINS INFORMATION THAT IS PROPRIETARY TO MOLEX INCORPORATED AND SHOULD NOT BE USED WITHOUT WRITTEN PERMISSION | |

PCB LAYOUT FOR SINGLE SIDE MOUNT

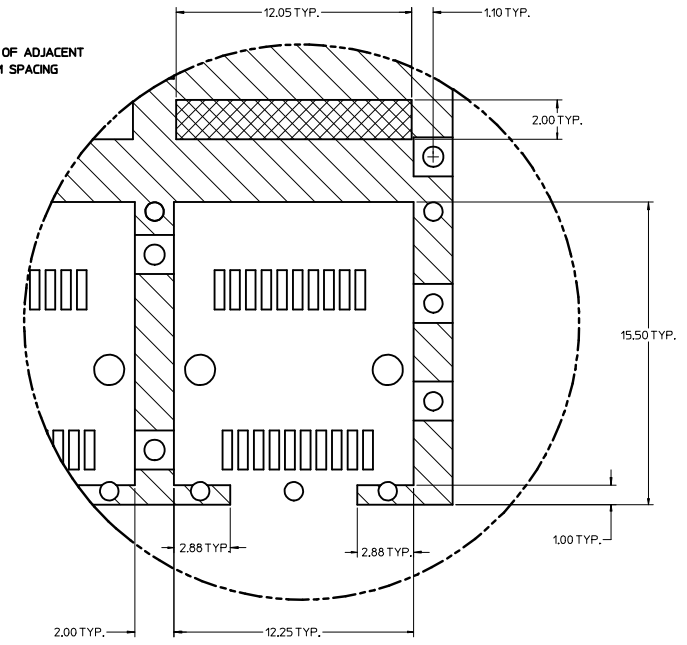
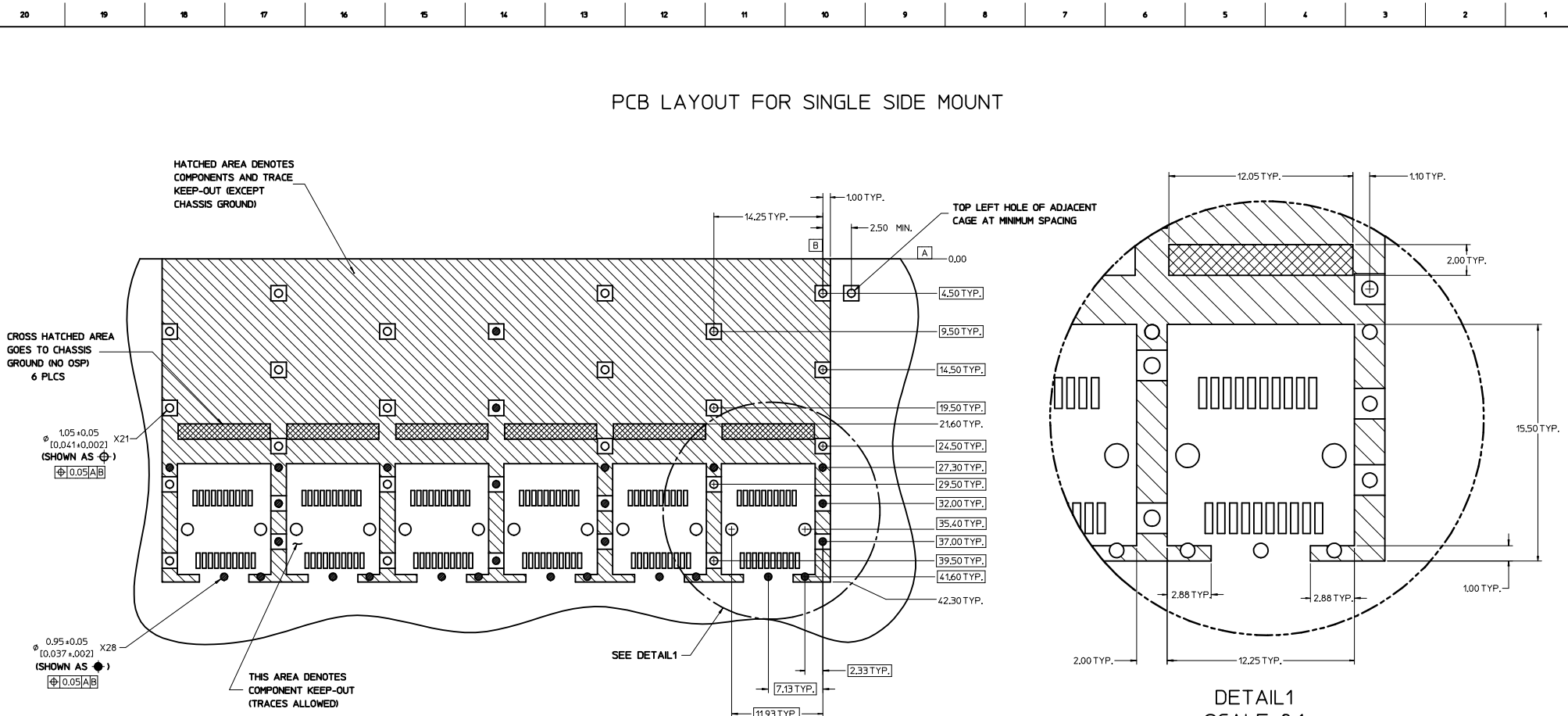

DETAIL 1
SCALE 8:1
HOST CONNECTOR DETAIL

NOTES:

1. PADS AND VIAS CONNECT TO CHASSIS GROUND (RECOMMEND PADS TO BE 2.00mm SQUARE)
2. RECOMMENDED THRU HOLE PLATING INCLUDES HASL, OSP, OR IMMERSION (GOLD, SILVER, OR TIN).
3. CONNECTOR PAD LAYOUT PER SFP+ MSA WILL ACCOMMODATE MOLEX CONNECTOR SERIES 74441 OR EQUIVALENT.
4. HOLE PATTERN REPEATS FOR EACH PORT. SPACING BETWEEN PORTS IS 14.25mm.

| | | | | | | |
|--|-----------------|--|---|---|------------------|------------------------|
| SEE REVISION TABLE IEC NO: CPG2013-2925 DRAWN BY: DRWNSYANG16 2013/03/22 CHECKED BY: CHYKORCHEN08 2013/04/09 APPR: KLLLOYD 2013/04/15 | QUALITY SYMBOLS | GENERAL TOLERANCES (UNLESS SPECIFIED) | DIMENSION STYLE | SCALE | DESIGN UNITS | THIRD ANGLE PROJECTION |
| | ▽=0 | mm INCH | MM ONLY | 1:1 | METRIC | ☉ |
| | ▽=0 | 4 PLACES ± --- ± --- | DRAWN BY: RCHEN08 DATE: 2013/01/25 | TITLE: SFP+ 1X6 GANGED PCI CAGE W/ .090" PRESS-FIT LEGS, SPR FINGERS, LT PIPE OPT | | |
| | ▽=0 | 3 PLACES ± --- ± --- | CHECKED BY: MAJOHNSTON DATE: 2013/01/30 | | | |
| | ANGULAR ± 1 ° | DRAFT WHERE APPLICABLE MUST REMAIN WITHIN DIMENSIONS | MATERIAL NO. 747541620 | DOCUMENT NO. SD-74754-1620 | SHEET NO. 2 OF 5 | |
| | | | THIS DRAWING CONTAINS INFORMATION THAT IS PROPRIETARY TO MOLEX INCORPORATED AND SHOULD NOT BE USED WITHOUT WRITTEN PERMISSION | | | |

PCB LAYOUT FOR BELLY TO BELLY MOUNTING

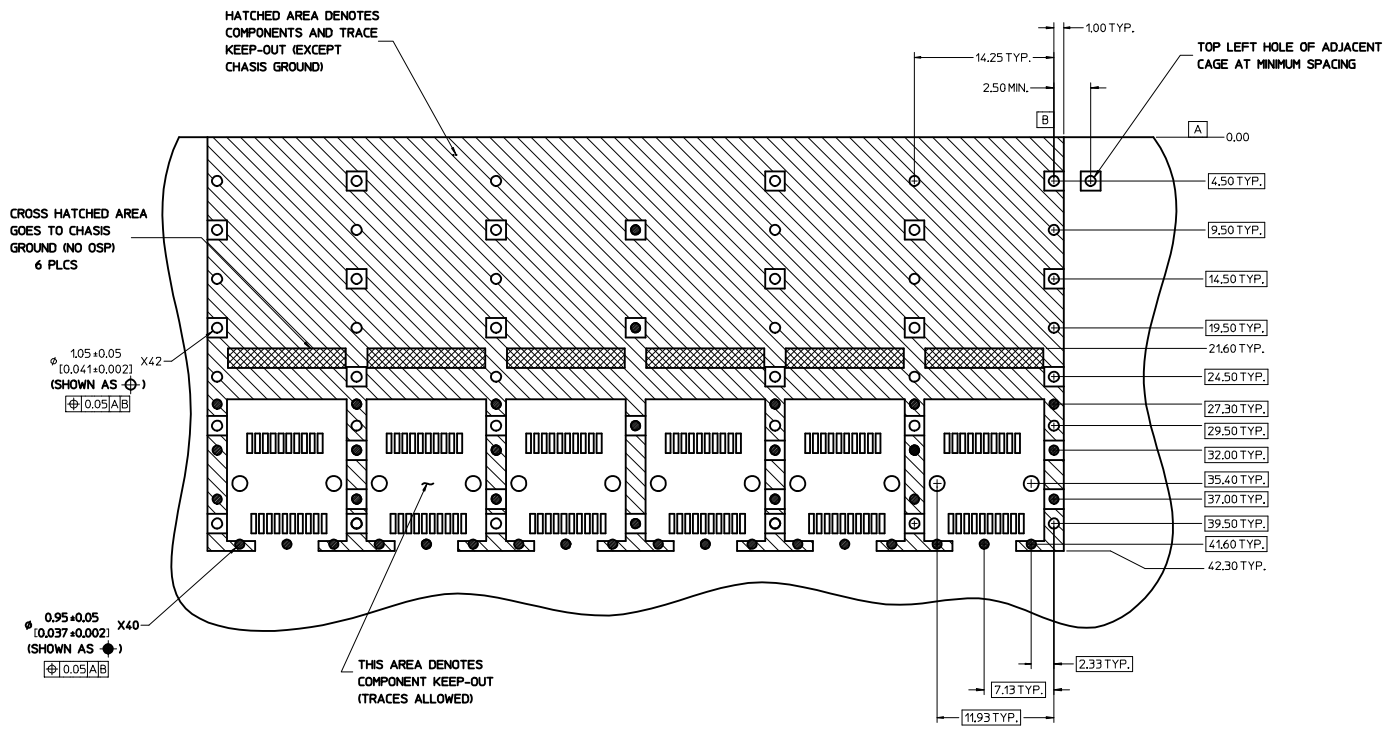

NOTE:
SEE SHEET 2 FOR
HOST CONNECTOR DETAIL

- NOTES:
1. PADS AND VIAS CONNECT TO CHASSIS GROUND (RECOMMEND PADS TO BE 2.00mm SQUARE)
 2. RECOMMENDED THRU HOLE PLATING INCLUDES HASL, OSP, OR IMMERSION (GOLD, SILVER, OR TIN).
 3. CONNECTOR PAD LAYOUT PER SFP+ MSA WILL ACCOMMODATE MOLEX CONNECTOR SERIES 74441 OR EQUIVALENT.
 4. HOLE PATTERN REPEATS FOR EACH PORT. SPACING BETWEEN PORTS IS 14.25mm.

| | | | | | | |
|--|----------------------|---------------------------------------|---|------------------------|---|------------------------|
| SEE REVISION TABLE IEC NO: CPG2013-2925 DRAWN BY: CHYKORCHEN08 CHECKED BY: APPR:KLLOYD DATE: 2013/03/22 DATE: 2013/04/09 DATE: 2013/04/15 | QUALITY SYMBOLS | GENERAL TOLERANCES (UNLESS SPECIFIED) | DIMENSION STYLE | SCALE | DESIGN UNITS | THIRD ANGLE PROJECTION |
| | ▽=0 | mm INCH | MM ONLY | 4:1 | METRIC | ☉ |
| | ▽=0 | 4 PLACES ± --- ± --- | DRAWN BY: RCHEN08 | DATE: 2013/01/25 | TITLE: SFP+ 1X6 GANGED PCI CAGE W/ .090" PRESS-FIT LEGS, SPR FINGERS, LT PIPE OPT | |
| | ▽=0 | 3 PLACES ± 0.15 ± --- | CHECKED BY: MAJOHNSTON | DATE: 2013/01/30 | molex | |
| | 1 PLACE ± 0.25 ± --- | APPROVED BY: KLLOYD | DATE: 2013/01/30 | MATERIAL NO: 747541620 | DOCUMENT NO: SD-74754-1620 | SHEET NO: 3 OF 5 |
| | 0 PLACE ± --- ± --- | ANGULAR ± 1° | THIS DRAWING CONTAINS INFORMATION THAT IS PROPRIETARY TO MOLEX INCORPORATED AND SHOULD NOT BE USED WITHOUT WRITTEN PERMISSION | | | |

BEZEL AND BOARD POSITION DIMENSIONS FOR SINGLE SIDE MOUNTING
(SPRING FINGER)

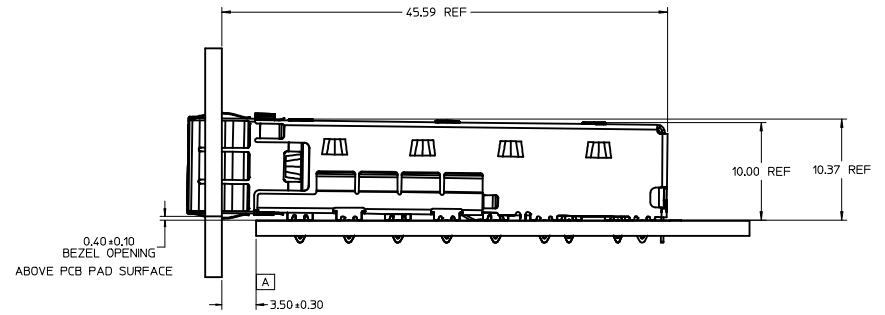
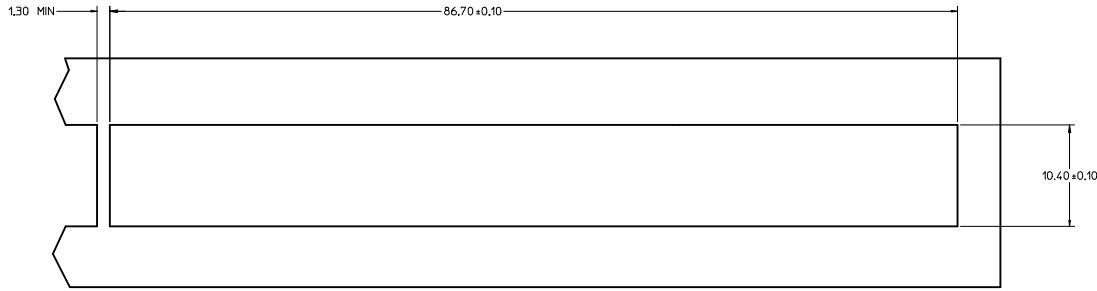

BEZEL AND BOARD POSITION DIMENSIONS FOR BELLY TO BELLY MOUNTING
(SPRING FINGER)

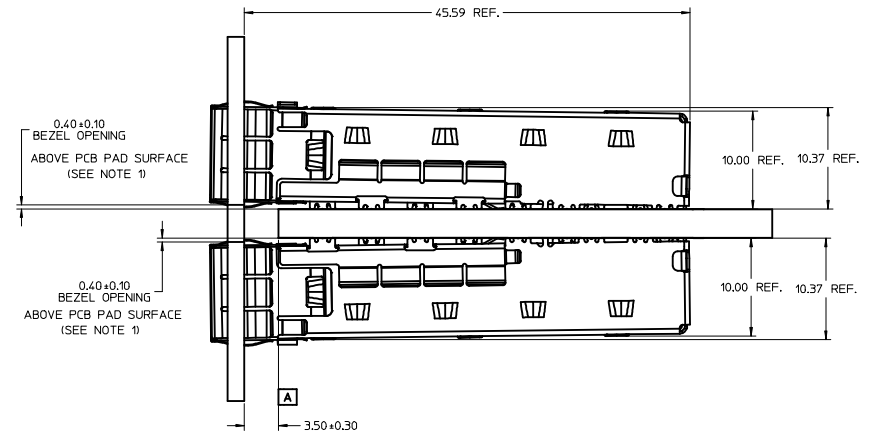
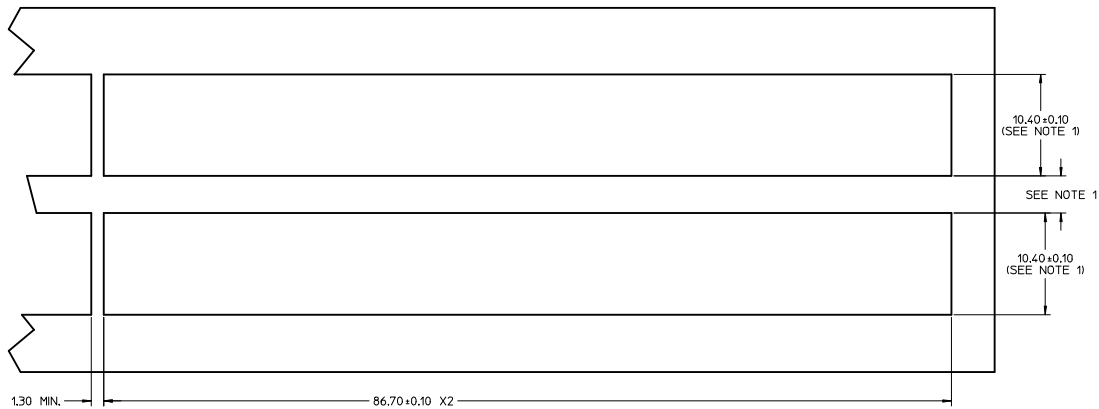

NOTES:

1. PCB THICKNESS VARIATION MUST BE CONSIDERED WHEN DETERMINING BEZEL OPENING, SIZE, AND LOCATION.

| SEE REVISION TABLE | | QUALITY SYMBOLS | | GENERAL TOLERANCES (UNLESS SPECIFIED) | | DIMENSION STYLE | | SCALE | | DESIGN UNITS | | THIRD ANGLE PROJECTION | |
|--------------------|------------------------|-----------------|---------|---|---------|---------------------------|------------|-------------------------------|--------|--|--|--|--|
| REV | DESCRIPTION | mm | INCH | mm | INCH | MM ONLY | DATE | 4:1 | METRIC | | | | |
| 1 | DRW:WYANG16 2013/03/22 | ± 0.15 | ± 0.005 | ± 0.15 | ± 0.005 | | 2013/01/25 | | | SFP+ 1X6 GANGED PCI CAGE W/ .090" PRESS-FIT LEGS, SPR FINGERS, LT PIPE OPT molex | | | |
| 2 | CHK:RCHEN08 2013/04/09 | ± 0.25 | ± 0.010 | ± 0.25 | ± 0.010 | | 2013/01/30 | | | | | | |
| 3 | APP:KLLLOYD 2013/04/15 | ± 0.25 | ± 0.010 | ± 0.25 | ± 0.010 | | 2013/01/30 | | | | | | |
| 4 | | ± 0.25 | ± 0.010 | ± 0.25 | ± 0.010 | | 2013/01/30 | | | | | | |
| | | ANGULAR ± 1 ° | | DRAFT WHERE APPLICABLE MUST REMAIN WITHIN DIMENSIONS | | MATERIAL NO. 747541620 | | DOCUMENT NO. SD-74754-1620 | | SHEET NO. 4 OF 5 | | THIS DRAWING CONTAINS INFORMATION THAT IS PROPRIETARY TO MOLEX INCORPORATED AND SHOULD NOT BE USED WITHOUT WRITTEN PERMISSION | |

| DATE | REV | REVISION HISTORY |
|------------|-----|--|
| 2013/01/30 | A | INITIAL RELEASE |
| 2013/02/04 | B | ADDING RECOMMENDED PCB THICKNESS OF 2.28mm MIN. FOR BELLY TO BELLY APPLICATION IN NOTE 2 ON SHEET 1. |
| 2013/03/22 | C | 1.ADJUSTED BASE HOLES' POSITIONS OF 2 ISO VIEWS ON SHEET 1. 2.CHANGED INNER WALLS OF LEFT ISO VIEW ON SHEET 1. 3.CHANGED NOTES'S DESCRIPTION FROM 'NO RoHS EXEMPTIONS' TO 'RoHS COMPLIANT, NO EXEMPTIONS.' ON SHEET 1. |
| | | |
| | | |

| | | | | | | |
|---|-----------------|--|---|---------------|--|------------------------|
| SEE REVISION TABLE IEC NO: CPG2013-2925 DRAWNSYANG16 2013/03/22 CHYKORCHEN08 2013/04/09 APPR:KLLOYD 2013/04/15 | QUALITY SYMBOLS | GENERAL TOLERANCES (UNLESS SPECIFIED) | DIMENSION STYLE | SCALE | DESIGN UNITS | THIRD ANGLE PROJECTION |
| | ▽=0 | 4 PLACES ± mm INCH | MM ONLY | 1:1 | METRIC | |
| | ▽=0 | 3 PLACES ± 0.15 | | | | |
| | ▽=0 | 2 PLACES ± 0.25 | | | | |
| | | ANGULAR ± 1 ° | DRAWN BY | DATE | TITLE | |
| | | DRAFT WHERE APPLICABLE MUST REMAIN WITHIN DIMENSIONS | RCHEN08 | 2013/01/25 | SFP+ 1X6 GANGED PCI CAGE W/ .090" PRESS-FIT LEGS, SPR FINGERS, LT PIPE OPT | |
| | | | CHECKED BY | DATE | | |
| | | | MA JOHNSTON | 2013/01/30 | | |
| | | | APPROVED BY | DATE | | |
| | | | KLLOYD | 2013/01/30 | | |
| | | | MATERIAL NO. | DOCUMENT NO. | SHEET NO. | |
| | | | 747541620 | SD-74754-1620 | 5 OF 5 | |
| | | | THIS DRAWING CONTAINS INFORMATION THAT IS PROPRIETARY TO MOLEX INCORPORATED AND SHOULD NOT BE USED WITHOUT WRITTEN PERMISSION | | | |

