

ARTESYN AVO240 SERIES

240 Watts



Advanced Energy's Artesyn AVO240 series eighth-brick isolated DC-DC converter is designed specifically to provide a regulated low noise 12 Vdc output for feeding downstream non-isolated point-of-load (POL) converters in systems with distributed power architectures (DPA). Rated at 240 watts, it can deliver up to 20 amps. The converter has a wide input range of 41 to 75 Vdc and is designed primarily for use with standard 48 V telecommunications equipment supplies.

DATA SHEET

Total Power:

240 Watts

Input Voltage:

41 - 75 V

of Outputs:

Single

SPECIAL FEATURES

- 2:1 wide input range
- Output voltage 12V
- Optimised for high density, small space applications
- Low ripple and noise
- Fixed switching frequency
- High efficiency
- High capacitive load capability
- Basic insulation system
- Open-frame structure

SAFETY

- TUV/CE 62368-1
- UL/cUL 60950-1



ELECTRICAL SPECIFICATIONS

Input	
Input range	41 - 75 Vdc
Efficiency ²	94% @ 12 Vo
Output	
Voltage tolerance	11.6 - 12.2 V
Line regulation	± 0.3%
Load regulation	± 0.5%
Noise/ripple	70 mV
Overvoltage protection Overtemperature protection	Auto-restart
Switching frequency	150 kHz
Temperature co-efficient	± 0.02/°C
Isolation	
I/O isolation	1500 Vdc min.

ENVIRONMENTAL SPECIFICATIONS

Operating ambient temperature	-40 °C to +85 °C
Storage temperature	-55 °C to +125 °C
Humidity	5% to 95% (non-condensing)
MTBF	1.5 Million hours
RoHS Compliant	

ORDERING INFORMATION

Model number	Input voltage	Output voltage	Power
AVO240-48S12-6L	41 - 75 Vin	12 V @ 20 A	240 W
AVO240-48S12B-6L	41 - 75 Vin	12 V @ 20 A	240 W
AVO240-48S12P-6L	41 - 75 Vin	12 V @ 20 A	240 W
AVO240-48S12PB-6L	41 - 75 Vin	12 V @ 20 A	240 W

Standard version is negative enable

"-6" = 3.8 mm pin length

"-4" = 4.8 mm pin length

"-P" = Positive enable

"-B" = baseplate

MECHANICAL DRAWINGS

AVO240-48S12-6L

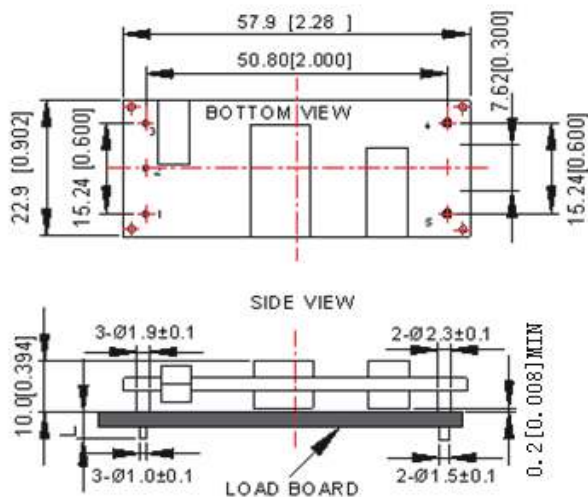

UNIT: mm[inch] BOTTOM VIEW: pin on upside

TOLERANCE: X.Xmm±0.5mm[X.X in.±0.02in.]
 X.XXmm±0.25mm[X.XX in.±0.01in.]

MECHANICAL DRAWINGS (CONTINUED)

AVO240-48S12B-6L

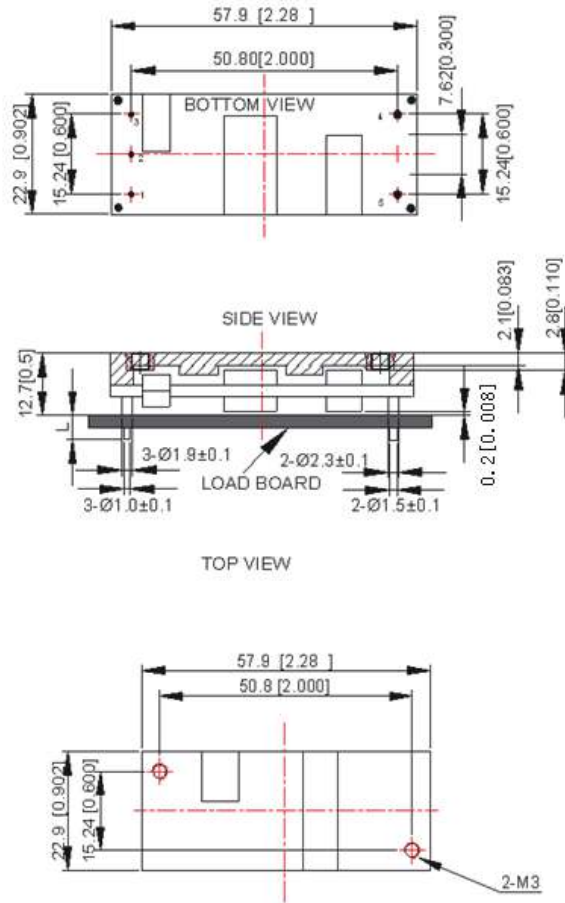

UNIT: mm[inch] BOTTOM VIEW: pin on upside

TOLERANCE: X.Xmm±0.5mm[X.X in ±0.02in.]
 X.XXmm±0.25mm[X.XX in ±0.01in.]

PIN LENGTH OPTIONS

Device code suffix	L
-4	4.8 mm ±0.2 mm
-6	3.8 mm ±0.2 mm
-8	2.8 mm ±0.2 mm
None	5.8 mm ±0.2 mm

PIN DESIGNATIONS

Pin No.	Name	Function
1	V_{in+}	Positive input voltage
2	Remote ON/OFF	Remote control
3	V_{in-}	Negative input voltage
4	V_o-	Negative output voltage
5	V_o+	Positive output voltage

Notes:

1. All specifications are subject to change without notice. Mechanical drawings are for reference only.
2. Warranty: 2 years
3. Label and logo appearance may vary from what is shown on mechanical drawings.



For international contact information,
visit advancedenergy.com.

powersales@aei.com (Sales Support)
productsupport.ep@aei.com (Technical Support)
+1 888 412 7832

ABOUT ADVANCED ENERGY

Advanced Energy (AE) has devoted more than three decades to perfecting power for its global customers. AE designs and manufactures highly engineered, precision power conversion, measurement and control solutions for mission-critical applications and processes.

Our products enable customer innovation in complex applications for a wide range of industries including semiconductor equipment, industrial, manufacturing, telecommunications, data center computing, and medical. With deep applications know-how and responsive service and support across the globe, we build collaborative partnerships to meet rapid technological developments, propel growth for our customers, and innovate the future of power.

PRECISION | POWER | PERFORMANCE

Specifications are subject to change without notice. Not responsible for errors or omissions. ©2020 Advanced Energy Industries, Inc. All rights reserved. Advanced Energy®, AE® and Artesyn™ are U.S. trademarks of Advanced Energy Industries, Inc.