

**Handle Series FG12-LH**

Compact functional handle with a three-coloured illuminatable handle ledge. The LED colours red, yellow and green can be used to display the current operating status of the machine for example.

**Material and surface:**

Handle shanks made of polyamide PA 6, black with a fine structure.  
Handle ledge made of extruded oval-profiled aluminium AlMgSi 0.5; glass ball blasted and anodized in natural colour.  
Illuminatable plastic insert made of translucent PMMA.

**Function elements:**

One push button, as a change-over contact.

**Connection:**

5 m connection cable leading out of the mounting surface of the handle shank.  
Version with an 8-pole connector on request.

**Protection class:**

IP 65.

**Note:**

Other handle lengths and switching element assignments, as well as white handle ledge lighting on request.



**VM-02**

Counter-handle without any electrical function elements, see page 35.



**Typ FG12-LH10**

**Connection**



**Typ FG12-LH11**

Typ		FG12-LH10	FG12-LH11
		without push button, with LED-illumination	with push button and with LED-illumination
A*	L	Order no.	Order no.
165	232	FG12-LH10.165.11	FG12-LH11.165.11

\* Other handle lengths on request



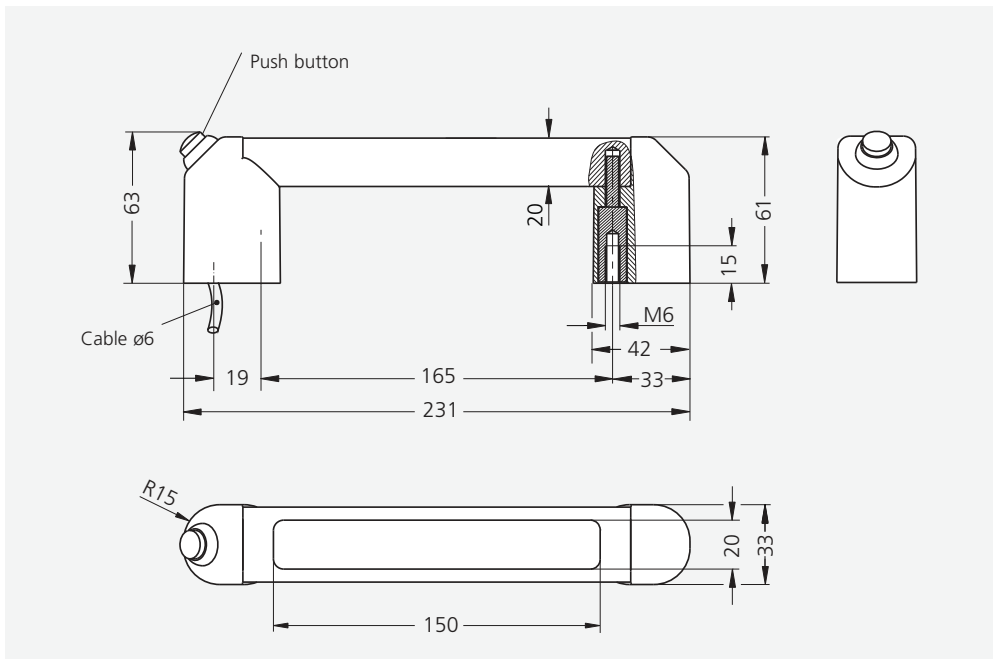

### Technical data

	FG12-LH10	FG12-LH11
<b>Typ</b>	without push button	with push button
<b>Push button</b> (1 change-over contact)	without	
<b>LED board</b>		
<b>Push button</b>	-	24 V AC/DC max. 1 A
<b>Operating voltage LED</b>	24 V DC (12 V DC optional)	
<b>Connection type</b>	cable 8-pole	
<b>Mounting cutout</b>		

All dimensions in mm.