

REVISIONS				
P	LTR	DESCRIPTION	DATE	OWN APVD
D		ECR-17-012802	06SEP2017	KG DW

△ MATERIAL: PROTECTIVE COVER: TPE, COLOR:BLACK, UL 94 HB. \*  
 FERRULE SUB ASSEMBLY: ZIRCONIA/METAL  
 COMPRESSION SPRING: STAINLESS STEEL.  
 CONNECTOR HOUSING: PBT, COLOR:BEIGE, UL 94 V-0. \*  
 PLUG BODY: PAS, COLOR: BEIGE, UL 94 V-0. \*  
 REAR BODY: METAL  
 BOOT: PP, COLOR:BEIGE, UL 94 V-0. \*  
 CRIMP EYELET/HEAT SHRINK ASSY: ALUM. ALLOY, HEAT SHRINK: POLYOLEFIN, UL VW-1.  
 \*RATED AT QUALIFYING THICKNESS.

△ BULK PACKAGED

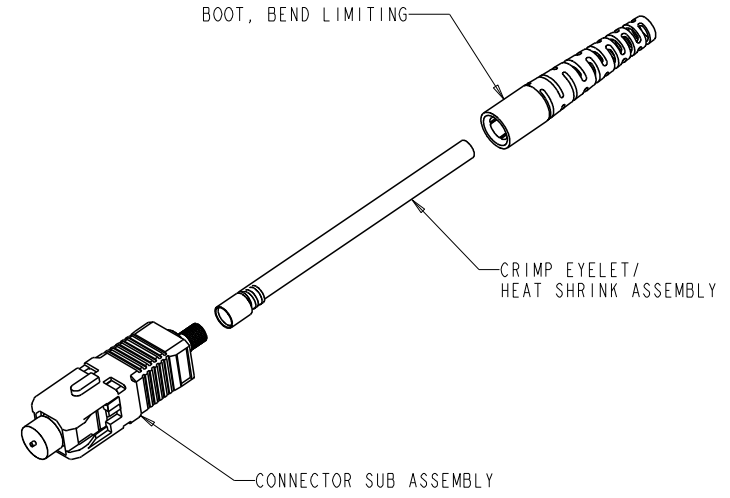
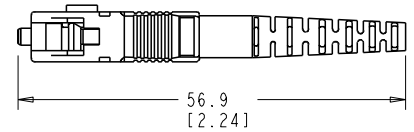
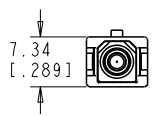
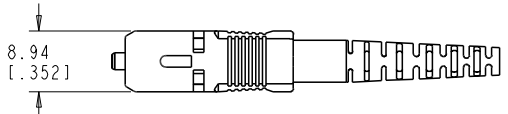

△	6828099-2
	6828099-1
	PART NUMBER

THIS DRAWING IS A CONTROLLED DOCUMENT.		OWN	T. HALEY	14OCT2005	TE Connectivity
DIMENSIONS: mm [ INCHES ]		CHK	D. ROHDE	14OCT2005	
TOLERANCES UNLESS OTHERWISE SPECIFIED:		APVD	D. ROHDE	14OCT2005	
0 PLC	±	PRODUCT SPEC		NAME	CONNECTOR KIT, SC, SIMPLEX
1 PLC	±0.1 [1.004]	APPLICATION SPEC		SIZE	MM, JUMPER, TIGHT JACKET
2 PLC	±0.01 [1.0004]	MATERIAL		WEIGHT	STYLE, 1.6-2.0mm
3 PLC	±	ANGLES		RESTRICTED TO	
4 PLC	±	FINISH		SCALE	
MATERIAL		CUSTOMER DRAWING		SIZE	A2
MATERIAL		CUSTOMER DRAWING		CAGE CODE	00779
MATERIAL		CUSTOMER DRAWING		DRAWING NO	6828099
MATERIAL		CUSTOMER DRAWING		SCALE	3:1
MATERIAL		CUSTOMER DRAWING		SHEET	1 OF 1
MATERIAL		CUSTOMER DRAWING		REV	D