

REVISIONS				
SYM	ZONE	ECN, ERN NO.	DATE	APPRD.
A		PROPOSAL	FEB. 20, 2012	L.CHAN

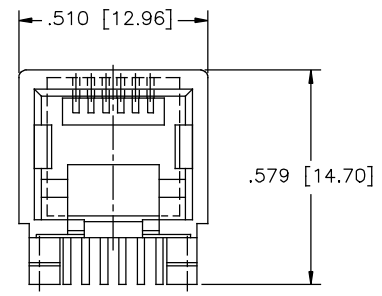

FRONT VIEW

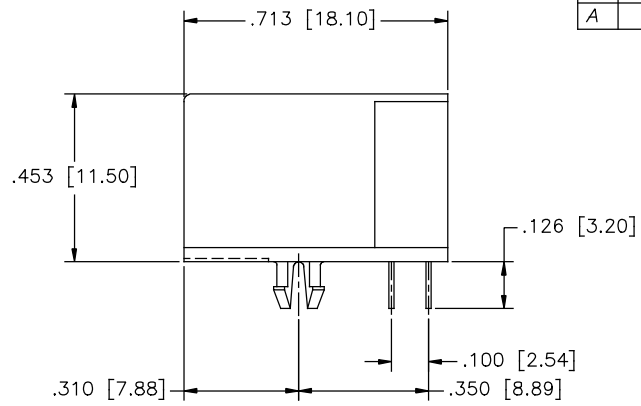

SIDE VIEW

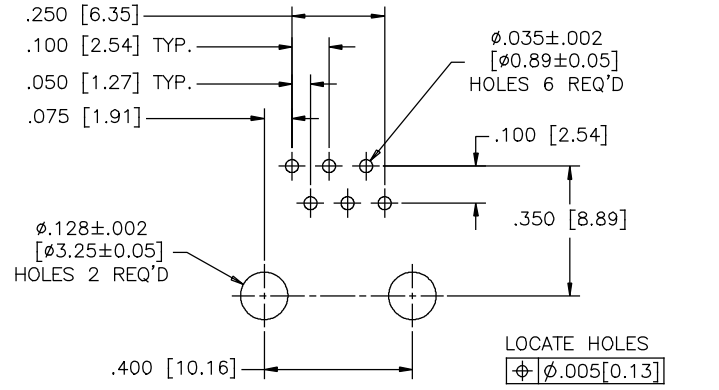

RECOMMENDED P.C.B. LAYOUT
(COMPONENT SIDE OF BOARD)

LOCATE HOLES
 $\phi \pm 0.005 [0.13]$
 POSITION DIMENSIONS
 ARE BASIC

MATERIALS:

PLASTIC HOUSING: HIGH TEMP. ENGINEERING THERMOPLASTIC
 FLAMMABILITY RATING UL94V-0
 COLOUR: REFER PART NUMBER.

CONTACTS:

PHOSPHOR BRONZE
 PLATING: REFER PART NUMBER FOR GOLD
 THICKNESS ON MATING SURFACES.
 50 μ " [1.27 MICRONS]
 MIN. NICKEL UNDERPLATE.
 100 μ " [2.54 MICRONS]
 MIN. MATTE-TIN OR GOLD FLASH ON
 CONTACT TAILS.

AMPHENOL PART NUMBER: RJE05-166-0XX0

GOLD PLATING	HOUSING COLOUR
1 = 6 μ "	1 = BLACK
2 = 15 μ "	7 = RED, 186C
3 = 30 μ "	8 = YELLOW, 114C
4 = 50 μ "	

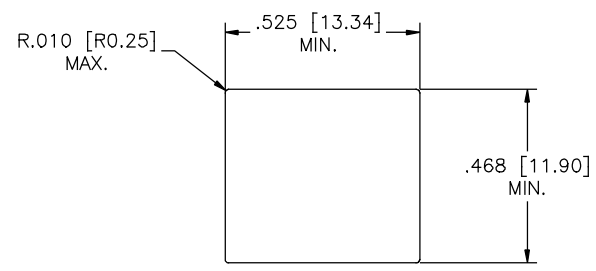

RECOMMENDED PANEL CUTOUT

DRAWN G.HSIA	DATE FEB. 20, 2012
DESIGNED	
CHECKED L.CHAN	DATE FEB. 20, 2012
I. E. APPRD.	
Q. A. APPRD.	
DWG. APPRD.	
ENG. REL. NO.	
REF.	
DIMENSIONS ARE IN	CODE ID. NO. 03554
mm	

Amphenol Canada Corp.

TITLE RJE05 SERIES MODULAR JACK,
 6 POSITION, 6 CONTACTS, UNSHIELDED,
 ULTRA LOW PROFILE - RoHS COMPLIANT

DWG DRAWING NO. P-RJE05-166-0XX0 REV. A

SCALE WT. SURF. SHEET 1 OF 1

THIS DOCUMENT CONTAINS PROPRIETARY INFORMATION AND SUCH INFORMATION
 MAY NOT BE DISCLOSED TO OTHERS FOR ANY PURPOSE OR USED FOR MANUFACTURING
 PURPOSES WITHOUT WRITTEN PERMISSION FROM AMPHENOL CANADA CORP.