

REVISIONS					
REV	DATE	DESCRIPTION	BY	CHK	APP'D
K3	21JUL2022	REVISED PER ECR-21-118222	JP	VS	

- 1 PARTS MUST COMPLY WITH AMP SOLDERABILITY SPEC 109-11-3.
- 2 CONTACT IS STAMPED FROM PRE-PLATED STOCK WHICH IS PLATED OVERALL WITH 0.00127 [.000050] NICKEL, THEN STRIPED WITH 0.00076 [.000030] GOLD IN CONTACT AREA INDICATED AND TIN-LEAD ON SOLDER TAIL END.
- 3 CIRCUIT IDENTIFICATION CHARACTERS ARE ADJACENT TO THE INDICATED CAVITIES, BUT LOCATION AND ORIENTATION MAY DIFFER FROM PRINT.
- 4 CONTACT IS PLATED OVERALL WITH 0.00127 [.000050] NICKEL, THEN 0.00076 [.000030] GOLD OVER CONTACT LENGTH INDICATED AND MATTE TIN ON SOLDER TAIL END.
- 5 SUPERSEDED BY 350834-4
- 6 DIMENSIONS SHOWN REPRESENT PRODUCT IN DRY CONDITION. ADDITIONAL 2% GROWTH DUE TO END USE LOCATION MOISTURE ABSORPTION MAY OCCUR AND SHOULD BE ACCOUNTED FOR.

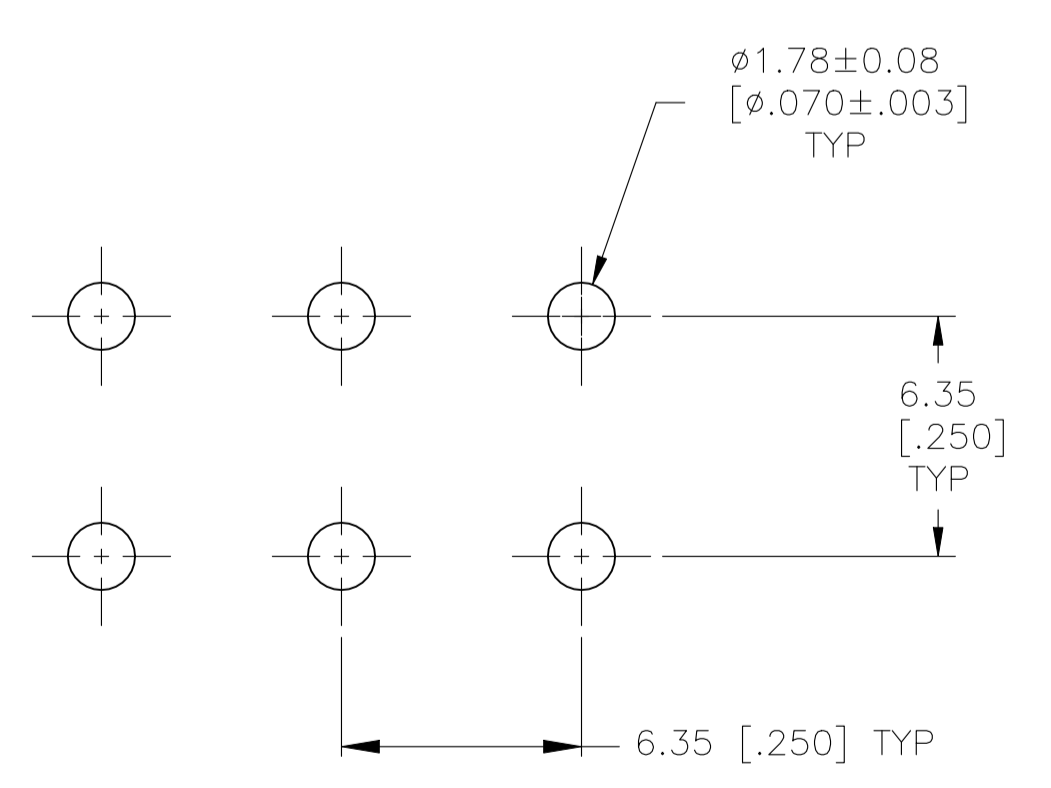
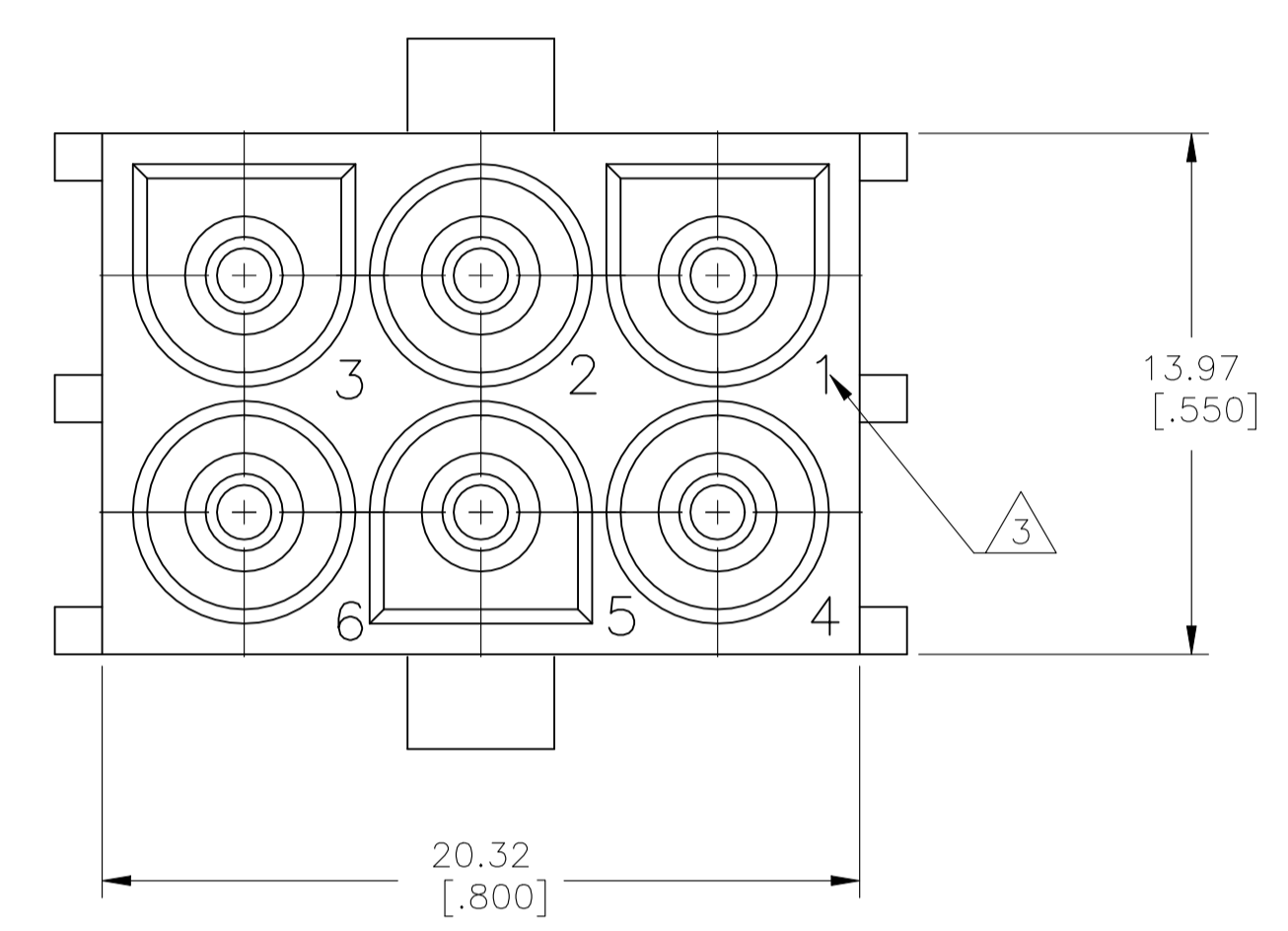
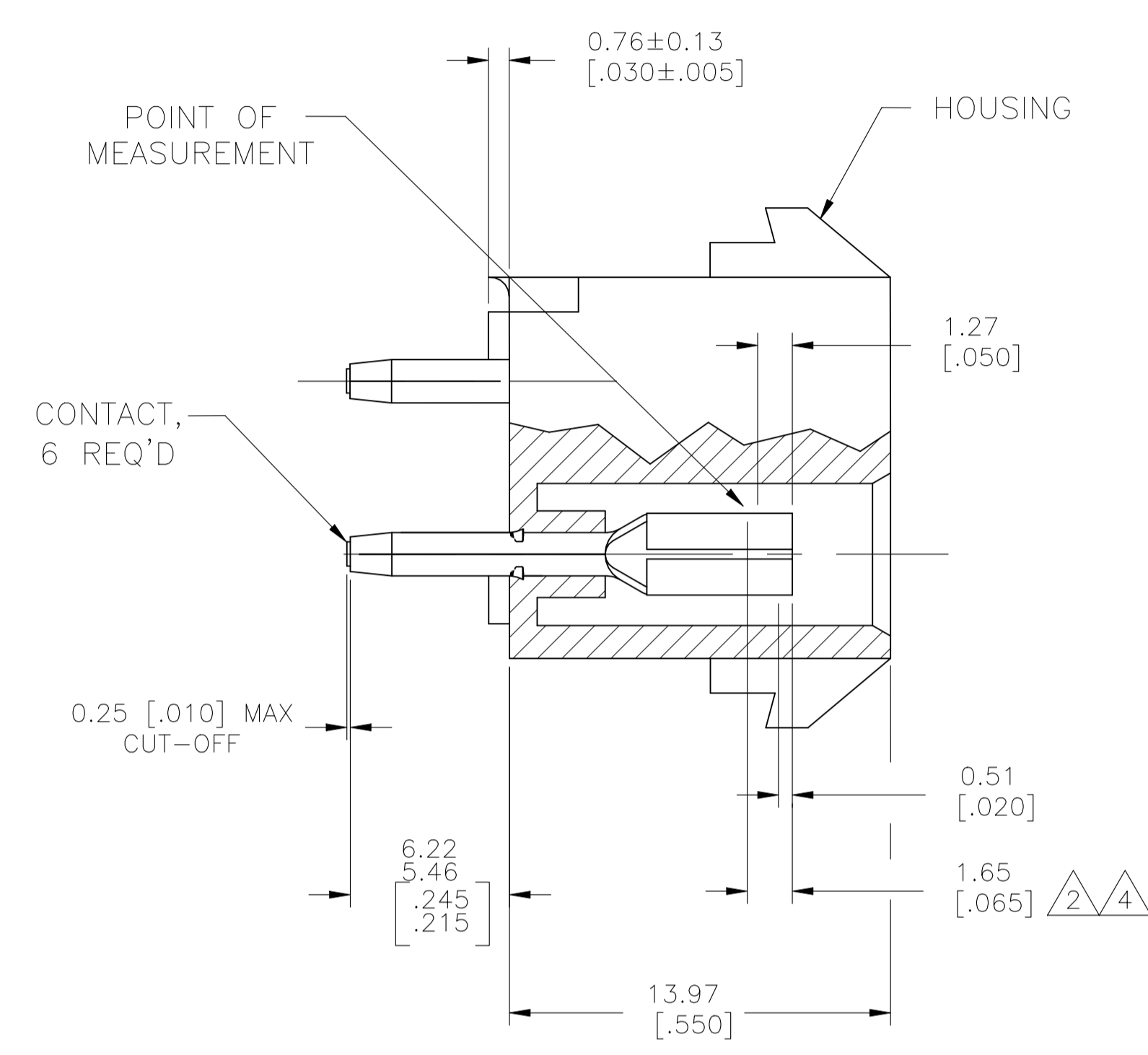
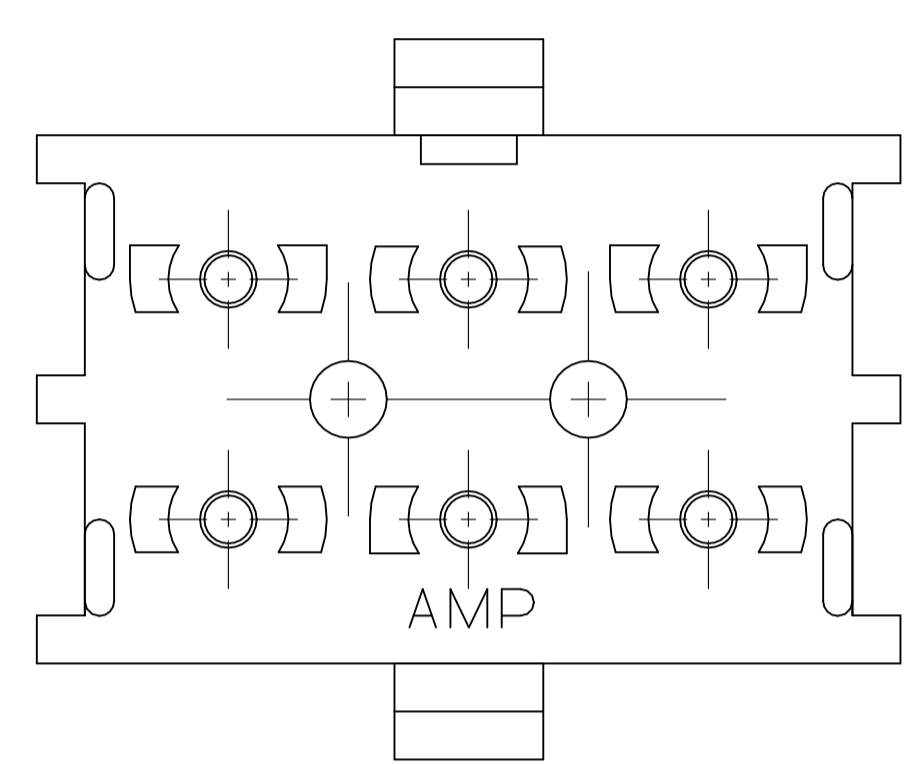

RECOMMENDED LAYOUT FOR 3.18 [.125] THICK PC BOARD

5	PH BRZ GOLD 4	NYLON,UL 94V-0	350834-4
	PH BRZ GOLD 2	NYLON,UL 94V-0	350834-2
	PH BRZ TIN	NYLON,UL 94V-0	350834-1
	CONTACT	HOUSING	PART NO

THIS DRAWING IS A CONTROLLED DOCUMENT.		DIN K. WHITAKER 11OCT2005		TE Connectivity	
DIMENSIONS: mm [INCHES]		TOLERANCES UNLESS OTHERWISE SPECIFIED:			
0. PLC ±		1. PLC ±		APPROVED S. RIDGILL 11OCT2005 NAME	
1. PLC ±		2. PLC ±		PRODUCT SPEC	
2. PLC ±		3. PLC ± 0.13 [.005]		APPLICATION SPEC	
3. PLC ±		4. PLC ±		SIZE CAGE CODE DRAWING NO	
4. PLC ±		ANGLES ±		WEIGHT	
MATERIAL SEE TABLE		FINISH SEE TABLE		A1 00779 C=350834	
		CUSTOMER DRAWING		SCALE 5:1 SHEET 1 OF 1 REV K3	