

MAT'L NO.	ENG. NO.	STUD SIZE	"S" ±.010 (0.25)	"W" MAX	"L" MAX	"T" REF
191640889	SD-656-08	#8	.173 (4.39)	.38 (9.7)	1.60 (40.6)	.045 (1.14)
191640080	SD-656-10	#10	.198 (5.03)			
191640081	SD-651-14	1/4	.265 (6.73)			
191640083	SD-651-56	5/16	.328 (8.33)	.60 (15.2)	1.79 (45.5)	
191640082	SD-652-38	3/8	.390 (9.91)	.82 (20.8)	2.05 (52.1)	.050 (1.27)
191640839	SD-652-76	7/16	.453 (11.51)			
191640457	SD-652-12	1/2	.515 (13.08)			

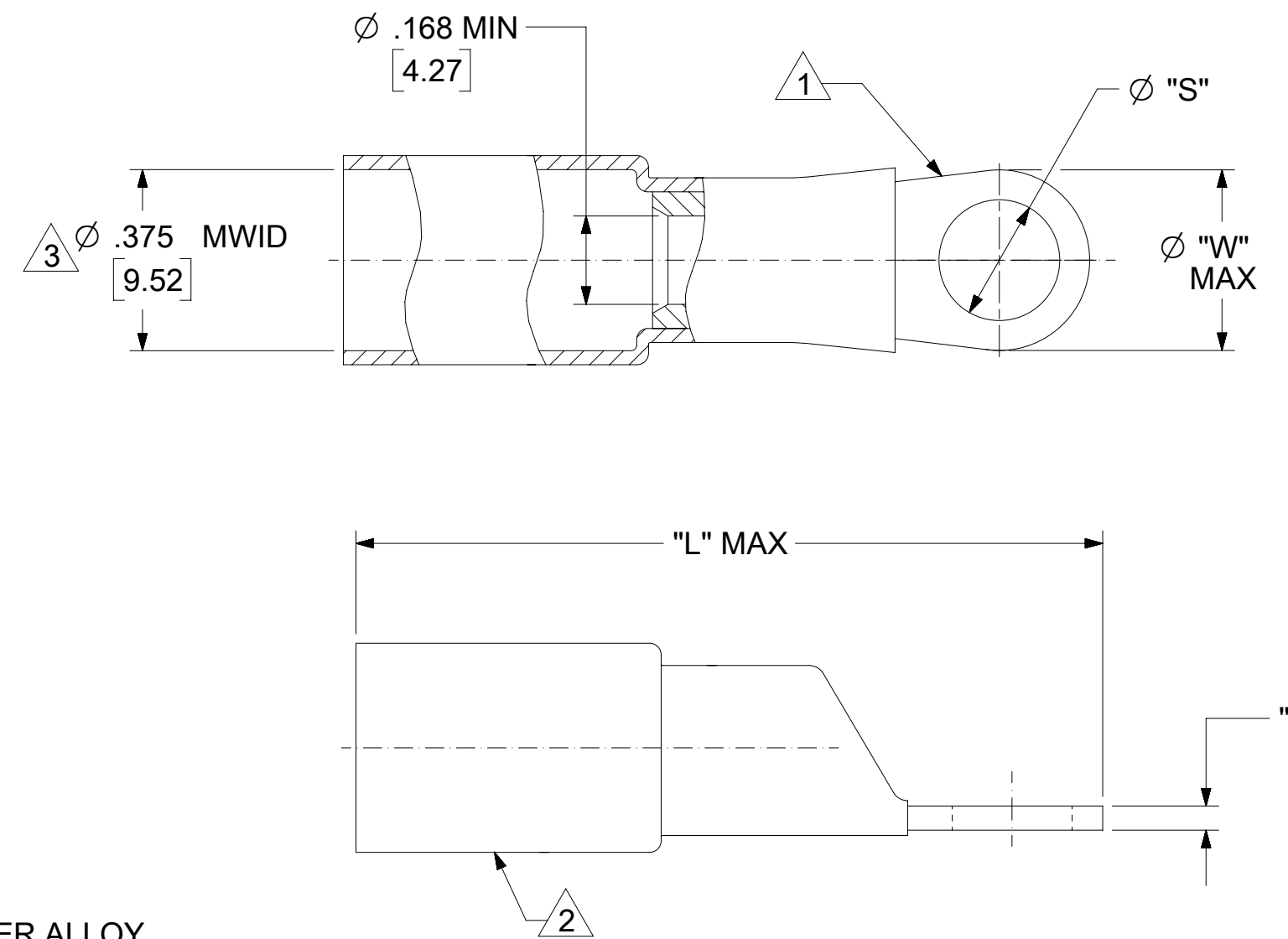

- NOTE(S):
- 1 TERMINAL MATERIAL: COPPER ALLOY
FINISH: ELECTRO-TIN PLATE
 - 2 INSUL. MATERIAL: HEAT SHRINKABLE TUBING WITH HOTMELT
ADHESIVE INNER LINER
COLOR: RED
 - 3 MWID = MAXIMUM WIRE INSULATION DIAMETER.
 - 4. ASSEMBLY IS RoHS COMPLIANT.

SYMBOLS		THIS DRAWING CONTAINS INFORMATION THAT IS PROPRIETARY TO MOLEX ELECTRONIC TECHNOLOGIES, LLC AND SHOULD NOT BE USED WITHOUT WRITTEN PERMISSION	
▽ = 0	DIMENSION UNITS	SCALE	CURRENT REV DESC: MIGRATE TO NX & UPDATE NOTES
▽ = 0	INCH/MM	NTS	
▽ = 0	GENERAL TOLERANCES (UNLESS SPECIFIED)		
▽ = 0		MM	INCH
▽ = 0	4 PLACES ±		
▽ = 0	3 PLACES ±		
▽ = 0	2 PLACES ±		
▽ = 0	1 PLACE ±		
▽ = 0	0 PLACES ±		
▽ = 0	ANGULAR TOL ± °		
■ = 0	DRAFT WHERE APPLICABLE MUST REMAIN WITHIN DIMENSIONS	THIRD ANGLE PROJECTION	DRAWING
▽ = 0			

EC NO: 632141	DRWN: DMYRICK	2020/02/12
CHK'D: JMACNEIL	2020/02/13	
APPR: JMACNEIL	2020/02/13	
INITIAL REVISION:		
DRWN: DBUNNELL	2000/09/06	
APPR: RDEROSS	2000/09/13	

molex		
RING TONGUE TERMINAL PERMA-SEAL SD-600-SERIES 8 AWG		
PRODUCT CUSTOMER DRAWING		
DOCUMENT NUMBER	DOC TYPE	DOC PART
SD-19164-023	PSD	001
REVISION	H2	
MATERIAL NUMBER	CUSTOMER	SHEET NUMBER
SEE CHART	GENERAL MARKET	1 OF 1