

MTG. EAR NOT SHOWN FOR CKT. I.D. CLARITY

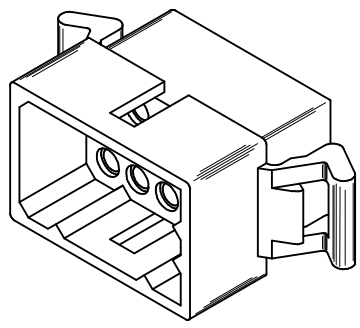

PLUG HOUSING

<b>PK SPEC</b> EC NO: UCP2015-0466 DRWN: JDOX CHKD: MKIPPER APPR: FSMITH	2014/08/05 2014/08/05 2014/08/14	DESCRIPTION REV	QUALITY SYMBOLS	GENERAL TOLERANCES (UNLESS SPECIFIED)	DIMENSION STYLE	SCALE	DESIGN UNITS	THIRD ANGLE PROJECTION
			$\nabla = 0$ $\nabla = 0$ $\nabla = 0$	IN/MM ± --- ± --- ± .010 ± .014 ± 0.25 ± .035 ± --- ± ---	INCH ± --- ± --- ± .010 ± .014 ± 0.25 ± .035 ± --- ± ---	DRAWN BY JDOX	DATE 2014/08/05	TITLE .062 HOUSING, PLUG AND RECEPTACLE, 15 CIRCUIT, .145 CENTERS
			CHECKED BY MKIPPER	DATE 2014/08/05	APPROVED BY FSMITH	DATE 2014/08/14	MATERIAL NO. SEE CHART	DOCUMENT NO. SD-1625-15*
			ANGULAR ±1/2° DRAFT WHERE APPLICABLE MUST REMAIN WITHIN DIMENSIONS	SIZE C	SHEET NO. 1 OF 3	THIS DRAWING CONTAINS INFORMATION THAT IS PROPRIETARY TO MOLEX INCORPORATED AND SHOULD NOT BE USED WITHOUT WRITTEN PERMISSION		

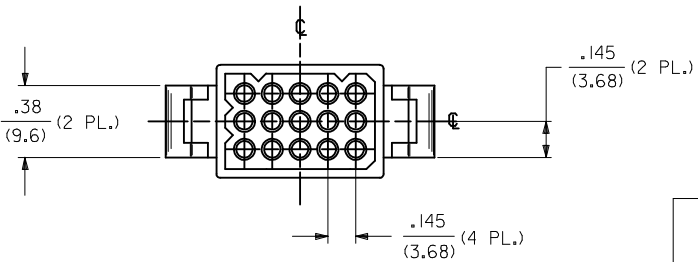
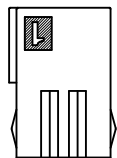
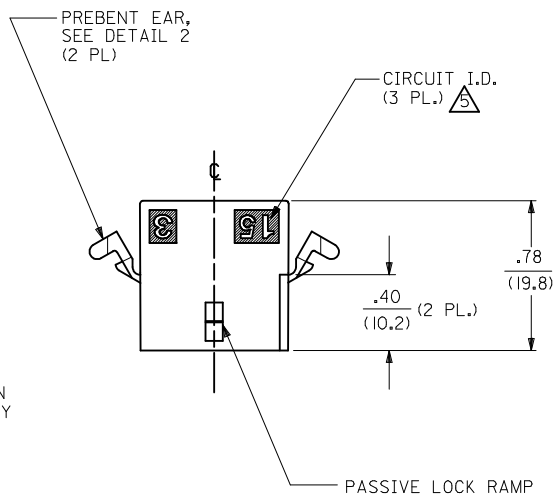
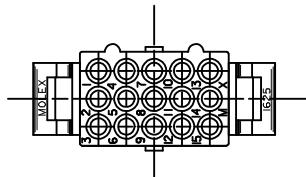

MTG. EAR NOT SHOWN FOR CKT. I.D. CLARITY

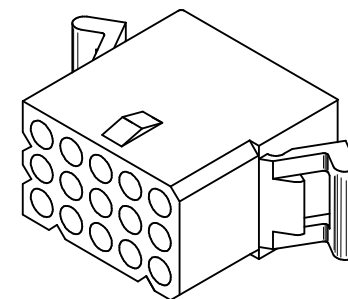
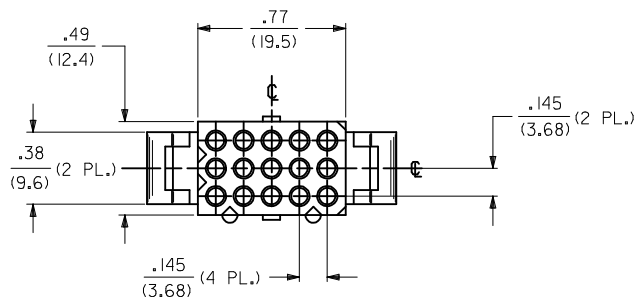

RECEPTACLE HOUSING

<b>SEE SHEET 1</b> IEC NO: UCP2015-0466 2014/08/05 DRWN:JDFOX 2014/08/05 CHKD:MKIPPER 2014/08/14 APPR:FSMITH	DESCRIPTION REV Q3	QUALITY SYMBOLS	GENERAL TOLERANCES (UNLESS SPECIFIED)	DIMENSION STYLE	SCALE	DESIGN UNITS	THIRD ANGLE PROJECTION																		
		$\nabla = 0$ $\nabla = 0$ $\nabla = 0$	<table border="1"> <thead> <tr> <th></th> <th>mm</th> <th>INCH</th> </tr> </thead> <tbody> <tr> <td>4 PLACES</td> <td>± .010</td> <td>± .0004</td> </tr> <tr> <td>3 PLACES</td> <td>± .010</td> <td>± .0004</td> </tr> <tr> <td>2 PLACES</td> <td>± 0.25</td> <td>± .010</td> </tr> <tr> <td>1 PLACE</td> <td>± 0.35</td> <td>± .014</td> </tr> <tr> <td>0 PLACE</td> <td>± .010</td> <td>± .0004</td> </tr> </tbody> </table>		mm	INCH	4 PLACES	± .010	± .0004	3 PLACES	± .010	± .0004	2 PLACES	± 0.25	± .010	1 PLACE	± 0.35	± .014	0 PLACE	± .010	± .0004	IN/MM DRAWN BY: JDFOX DATE: 2014/08/05 CHECKED BY: MKIPPER DATE: 2014/08/05 APPROVED BY: FSMITH DATE: 2014/08/14	2:1	INCH	
			mm	INCH																					
		4 PLACES	± .010	± .0004																					
3 PLACES	± .010	± .0004																							
2 PLACES	± 0.25	± .010																							
1 PLACE	± 0.35	± .014																							
0 PLACE	± .010	± .0004																							
ANGULAR ±1/2° DRAFT WHERE APPLICABLE MUST REMAIN WITHIN DIMENSIONS	MATERIAL NO. <b>SEE CHART</b>	TITLE <b>.062 HOUSING, PLUG AND RECEPTACLE, 15 CIRCUIT, .145 CENTERS</b> 	DOCUMENT NO. <b>SD-1625-15*</b>	SHEET NO. <b>2 OF 3</b>																					
THIS DRAWING CONTAINS INFORMATION THAT IS PROPRIETARY TO MOLEX INCORPORATED AND SHOULD NOT BE USED WITHOUT WRITTEN PERMISSION																									

PLUG	
PART NO.	ENG. NO.
03-06-2151	1625-15P
03-06-7155	1625-15P IBN
03-06-7152	1625-15P IBK
03-06-2152	1625-15P I
03-06-7151	1625-15PBK
03-06-7153	1625-15PBN
03-06-7154	1625-15PBU

RECEPTACLE	
PART NO.	ENG. NO.
03-06-1152	1625-15R I
03-06-6152	1625-15R IBK
03-06-6155	1625-15R2
NOT TOOLED	1625-15R2BK

**RECEPTACLE LEGEND:**

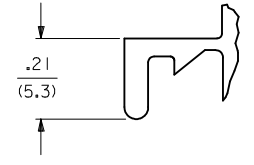
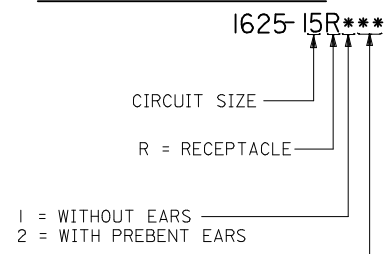

**DETAIL 1**  
STANDARD MOUNTING EAR  
SCALE 4:1

**PLUG LEGEND:**

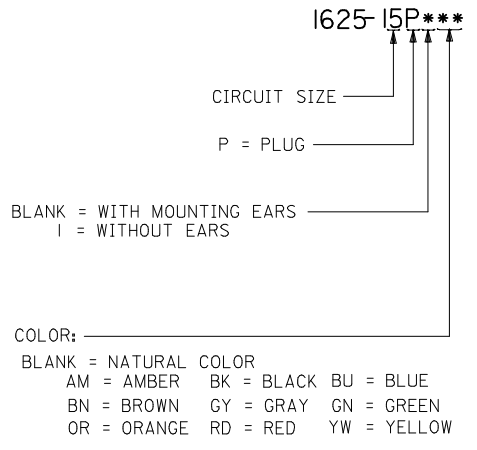

COLOR: \_\_\_\_\_  
 BLANK = NATURAL COLOR  
 AM = AMBER BK = BLACK BU = BLUE  
 BN = BROWN GY = GRAY GN = GREEN  
 OR = ORANGE RD = RED YW = YELLOW

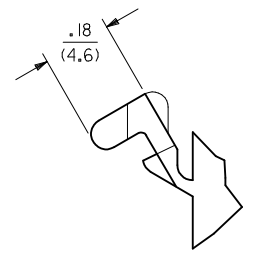
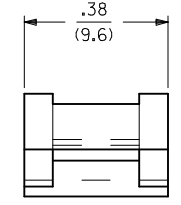
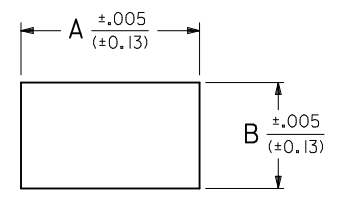
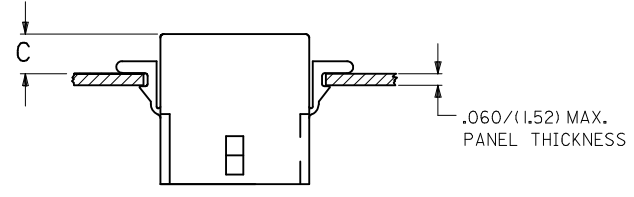

**DETAIL 2**  
.062/(1.57)PREBENT MOUNTING EAR  
(SCALE 4:1)

**RECOMMENDED HOLE PATTERN**

RECEP.	.930 (23.62)	.569 (14.45)		.22 (5.6)
PLUG	.1032 (26.21)	.620 (15.75)	.20 (5.1)	.21 (5.3)
PART	DIM. A	DIM. B	DIM. C (STANDARD EAR)	DIM. C (PREBENT EAR)

**NOTES:**

- MATERIAL: NYLON TYPE 6/6, UL94V-2, COLOR: SEE LEGEND
- FINISH: NONE
- THIS PART COMPLIES WITH MOLEX PRODUCT SPEC. PS-02-06.
- PACKAGING SPECIFICATION: PK-1625-003.
- CIRCUIT I.D. NUMBERS ON HOUSING APPEAR ON PART FROM TOOLS BUILT AFTER 1/15/94.
- THIS HOUSING FOR USE WITH .062/(1.57) DIA. TERMINALS.
- WHERE DENOTED IN CHART, TOOLS ARE BUILT WITH PREBENT MOUNTING EARS PER DETAIL 2 AND SUPERSEDE ALL TOOLS PREVIOUSLY BUILT WITH THE STANDARD MOUNTING EARS.
- PARTS CONFORM TO CLASS B REQUIREMENTS OF COSMETIC SPECIFICATION PS-45499-002.

<b>SEE SHEET 1</b> EC NO: UCP2015-0466 DRWN: JDFOX 2014/08/05 CHKD: MKIPPER 2014/08/05 APPR: FSMITH 2014/08/14 Q3	DESCRIPTION QUALITY SYMBOLS 	GENERAL TOLERANCES (UNLESS SPECIFIED)		DIMENSION STYLE <b>IN/MM</b>	SCALE <b>2:1</b>	DESIGN UNITS <b>INCH</b>	THIRD ANGLE PROJECTION		
		4 PLACES ± --- ± --- 3 PLACES ± --- ± .010 2 PLACES ± 0.25 ± .014 1 PLACE ± 0.35 ± --- 0 PLACE ± --- ± ---		DRAWN BY JDFOX	DATE 2014/08/05	TITLE <b>.062 HOUSING, PLUG AND RECEPTACLE, 15 CIRCUIT, .145 CENTERS</b>			
		ANGULAR ±1/2°		CHECKED BY MKIPPER	DATE 2014/08/05				
		DRAFT WHERE APPLICABLE MUST REMAIN WITHIN DIMENSIONS		APPROVED BY FSMITH	DATE 2014/08/14	MATERIAL NO. <b>SEE CHART</b>	DOCUMENT NO. <b>SD-1625-15*</b>	SHEET NO. <b>3 OF 3</b>	

THIS DRAWING CONTAINS INFORMATION THAT IS PROPRIETARY TO MOLEX INCORPORATED AND SHOULD NOT BE USED WITHOUT WRITTEN PERMISSION