

This document is the property of Amphenol Corporation and is delivered on the express condition that it is not to be disclosed, reproduced or used, in whole or in part, for manufacture or sale by anyone other than Amphenol Corporation without its prior consent, and that no right is granted to disclose or to use any information in this document.

The marking on this product doesn't contain environmental hazardous materials per Material Specification 55-00259 for Sony GP compliant or per directive 2011/65/EU for RoHS compliant.

**FOR REFERENCE ONLY**

REVISIONS				
SYM	ECN No.	DESCRIPTION	DATE	APPROVED
A	NE-15086	RELEASE TO PRODUCTION	07/27/2015	Roger Tsai
B	NE-17034	UPDATE PACKAGE	04/12/2017	Roger Tsai
CX1	-	ADD COPLANARITY	02/23/2021	Roger Tsai
CX2	EDSR#2209	ADD 24P	05/31/2022	Roger Tsai
CX3	-	UPDATE 20P DIM D & E	06/16/2022	Roger Tsai

PART NO. G880 XX 1 X 3 T4HR  
 NO. OF POSITIONS ——— CONTACT FINISH  
 1. 100u" MATTE TIN  
 2. GOLD FLASH  
 5: 15u" GOLD  
 6: 30u" GOLD

- NOTES:
- MATERIAL:  
 HOUSING: HIGH TEMPERATURE THERMAL PLASTIC, NYLON 9T, UL94V-0, COLOR: BLACK.  
 TERMINAL: COPPER ALLOY.  
 TAB: COPPER ALLOY.
  - FINISH:  
 TERMINAL:  
 CONTACT AREA: SELECTIVE GOLD OR MATTE TIN PLATING THICKNESS MIN.;  
 SOLDERING AREA: GOLD FLASH OR 100u" MATTE TIN PLATING.  
 UNDER PLATING: NICKEL PLATING 50 μ" THICKNESS MIN. OVERALL.  
 TAB:  
 MATTE TIN PLATING 100 μ" THICKNESS MIN.;  
 UNDER PLATING: NICKEL PLATING 50 μ" THICKNESS MIN. OVERALL.
  - PRODUCT SPECIFICATION REFER TO : PS-7534.
  - TEST REPORT REFER TO : TS-7534-001.
  - PACKING IS PER AMTA PACKING SPECIFICATION PKS-0001.
  - THIS PRODUCT DOESN'T CONTAIN ENVIRONMENTAL HAZARDOUS PER DIRECTIVE 2011/65/EU FOR RoHS COMPLIANT.

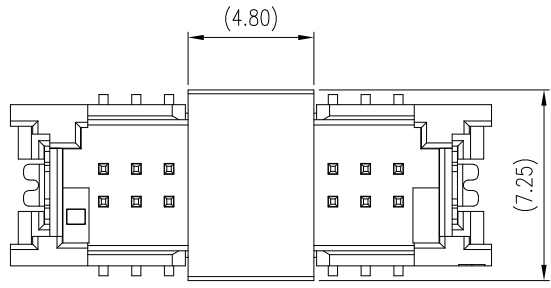
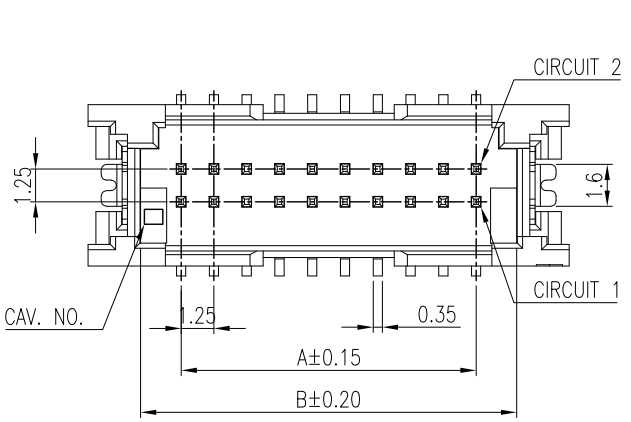
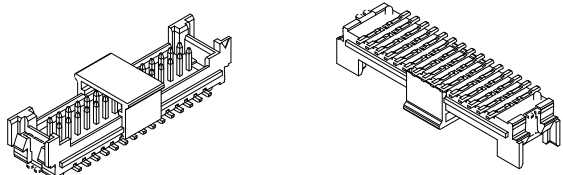

PICK AND PLACE AREA

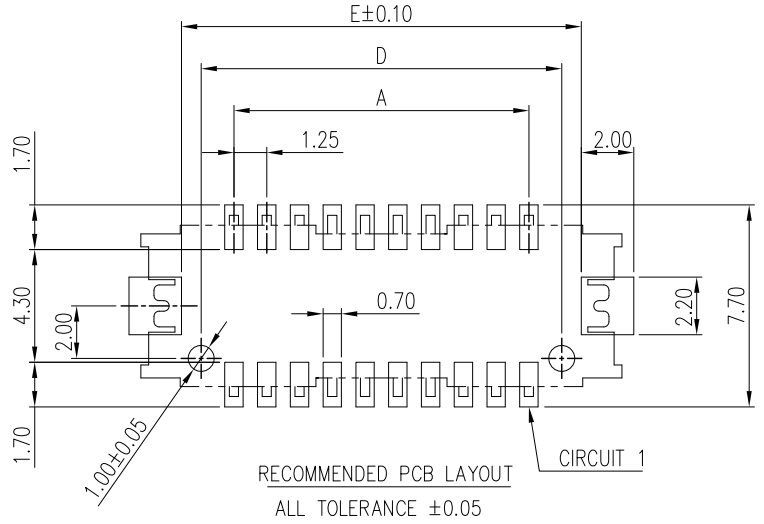
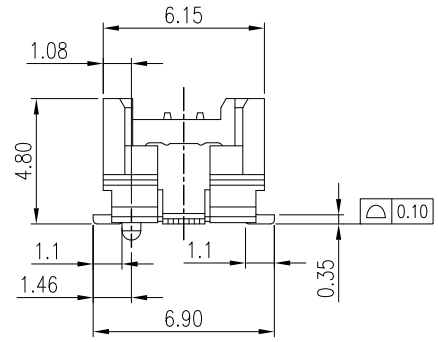
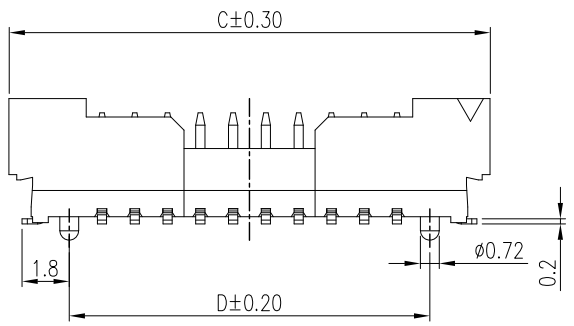

2X20=40	23.75	26.85	30.85	26.25	27.45
2X17=34	20.00	23.10	27.10	22.50	23.70
2X15=30	17.50	20.60	24.60	20.00	21.20
2X12=24	13.75	16.85	20.85	16.25	17.45
2X10=20	11.25	14.35	18.35	13.75	14.95
2X05=10	5.00	8.10	12.10	7.50	8.70
NO. OF POS.	A	B	C	D	E

TOLERANCE		APPROVALS		DATE	TITLE		Amphenol®			
X.		DRAWN Sandy Wu		06/16/2022	G880 SERIES, PROTECT HEADER		Amphenol Corporation Amphenol Taiwan Corporation			
X.X	±0.30	CHECKED Debby Hung		06/16/2022	1.25MM PITCH, VERTICAL					
X.XX	±0.20	APPROVED Roger Tsai		06/16/2022	SMT TYPE		PART No. G880XX1X3T4HR			
X.XXX	±0.10	DWG TYPE CUST DWG		PROJECT CODE PHD	UNIT mm		SIZE A3	DWG No. G880XX1X3T4HR		
ANGULAR	±1°	UNLESS OTHERWISE SPECIFIED			SCALE NA		SHEET 1 OF 3	REV. CX3		

# FOR REFERENCE ONLY

This document is the property of Amphenol Corporation and is delivered on the express condition that is not to be disclosed, reproduced or used, in whole or in part, for manufacture or sale by anyone other than Amphenol Corporation without its prior consent, and that no right is granted to disclose or to use any information in this document.

The marking on this product doesn't contain environmental hazardous materials per Material Specification SS-00259 for Sony GP compliant or per directive 2011/65/EU for RoHS compliant.

REVISIONS				
SYM	ECN No.	DESCRIPTION	DATE	APPROVED
A	NE-15086	RELEASE TO PRODUCTION	07/27/2015	Roger Tsai
B	NE-17034	UPDATE PACKAGE	04/12/2017	Roger Tsai
CX1	-	ADD COPLANARITY	02/23/2021	Roger Tsai
CX2	EDSR#2209	ADD 24P	05/31/2022	Roger Tsai
CX3	-	UPDATE 20P DIM D & E	06/16/2022	Roger Tsai

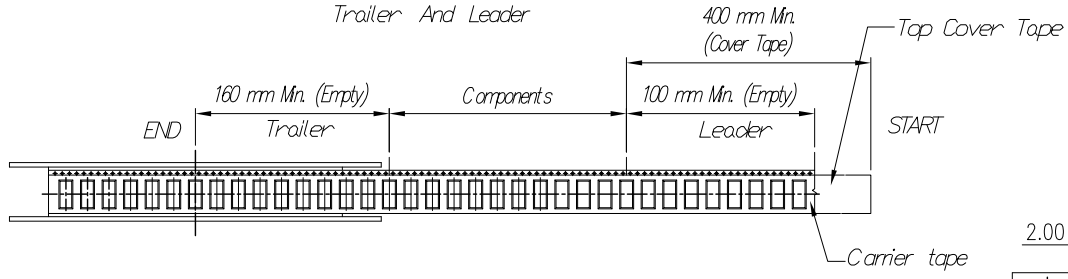

- NOTES:
- 10 SPROCKET HOLE PITCH CUMULATIVE TOLERANCE  $\pm 0.20$ .
  - CARRIER CAMBER IS WITHIN 1 mm IN 250 mm.
  - MATERIAL : TRANSPARENT CONDUCTIVE POLYSTYRENE ALLOY.(UP-5000)
  - ALL DIMENSIONS MEET EIA-481-C REQUIREMENTS.
  - THICKNESS :  $0.35 \pm 0.05$ mm.
  - COMPONENT LOAD PER 19" REEL: 900 PCS.

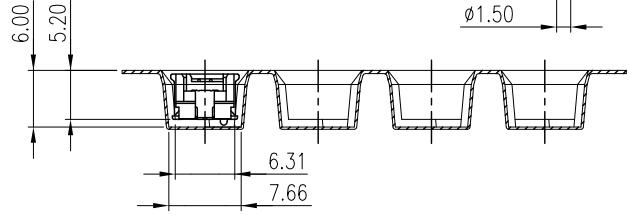
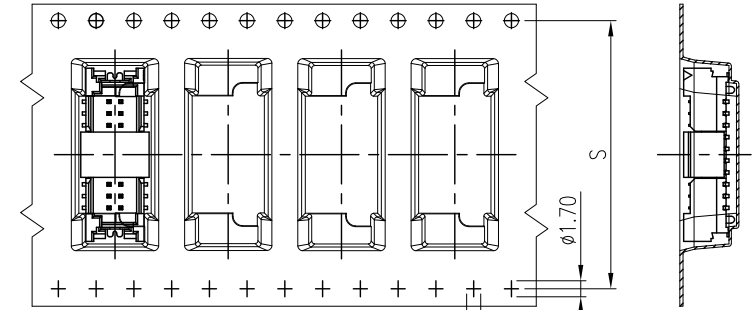
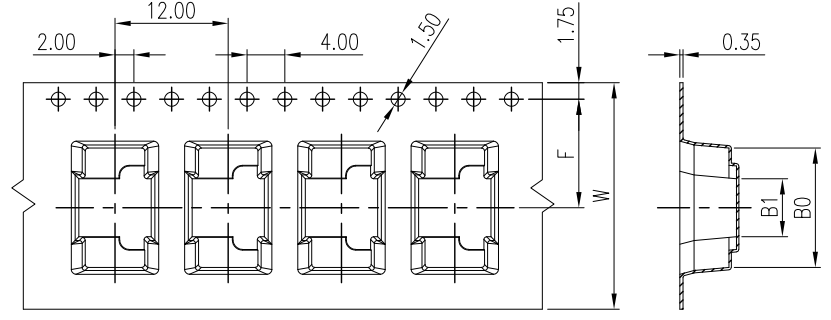
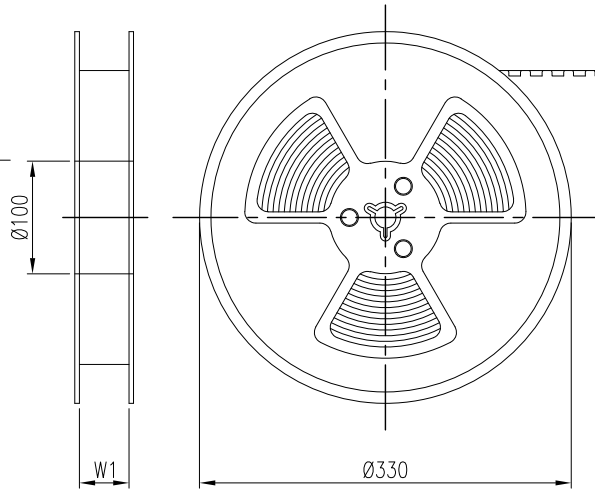
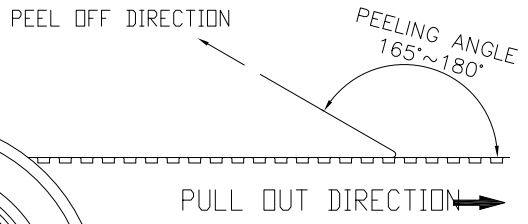

PIN	B0	B1	F	S	W	W1
2X05	12.65	5.85	11.50	--	24.00	24.50
2X10	18.90	12.40	14.20	28.40	32.00	32.50
2X12	21.40	14.90	14.20	28.40	32.00	32.50
2X15	25.15	18.65	20.20	40.40	44.00	44.50
2X17	27.65	21.15	20.20	40.40	44.00	44.50
2X20	31.40	24.90	20.20	40.40	44.00	44.50

TOLERANCE	APPROVALS	DATE	TITLE		PART No.	
X. ±0.30	DRAWN Sandy Wu	06/16/2022	G880 SERIES, PROTECT HEADER		Amphenol®	
X.X ±0.20	CHECKED Debby Hung	06/16/2022	1.25MM PITCH, VERTICAL		Amphenol Corporation	
X.XXX ±0.10	APPROVED Roger Tsai	06/16/2022	SMT TYPE		Amphenol Taiwan Corporation	
ANGULAR ±1°	DWG TYPE CUST DWG	PROJECT CODE PHD	UNIT mm	SIZE A3	PART No. G880XX1X3T4HR	
UNLESS OTHERWISE SPECIFIED			SCALE NA	SHEET 2 OF 3	DWG No. G880XX1X3T4HR	REV. CX3

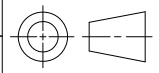

# FOR REFERENCE ONLY

This document is the property of Amphenol Corporation and is delivered on the express condition that is not to be disclosed, reproduced or used, in whole or in part, for manufacture or sale by anyone other than Amphenol Corporation without its prior consent, and that no right is granted to disclose or to use any information in this document.

The marking on this product doesn't contain environmental hazardous materials per Material Specification 55-00259 for Sony GP compliant or per directive 2011/65/EU for RoHS compliant.

REVISIONS				
SYM	ECN No.	DESCRIPTION	DATE	APPROVED
A	NE-15086	RELEASE TO PRODUCTION	07/27/2015	Roger Tsai
B	NE-17034	UPDATE PACKAGE	04/12/2017	Roger Tsai
CX1	-	ADD COPLANARITY	02/23/2021	Roger Tsai
CX2	EDSR#2209	ADD 24P	05/31/2022	Roger Tsai
CX3	-	UPDATE 20P DIM D & E	06/16/2022	Roger Tsai

PACKING CAPACITY	
PART NAME	DIM.(mm)
REEL	ø330X(W+0.5)
CARTON	350X350X340

PIN	PCS/RE	RE/BC	PCS/BC
2X05	900	9	8100
2X10	900	7	6300
2X12	900	7	6300
2X15	900	6	5400
2X17	900	6	5400
2X20	900	6	5400

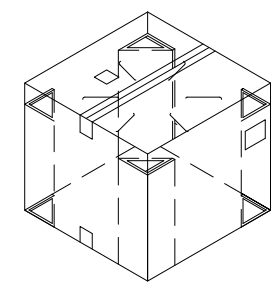
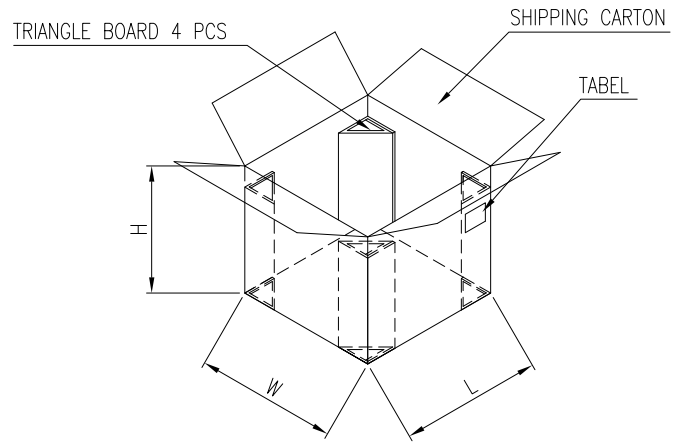
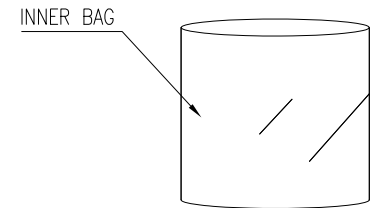
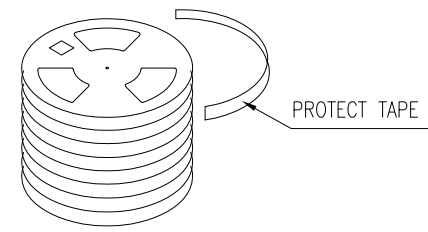
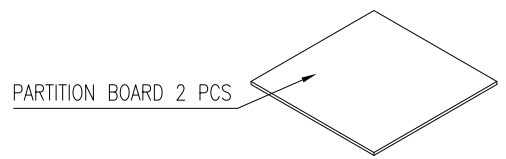

TOLERANCE		APPROVALS		DATE	TITLE			Amphenol®		
X.		DRAWN	Sandy Wu	06/16/2022	G880 SERIES, PROTECT HEADER			Amphenol Corporation Amphenol Taiwan Corporation		
X.X	±0.30	CHECKED	Debby Hung	06/16/2022	1.25MM PITCH, VERTICAL					
X.XX	±0.20	APPROVED	Roger Tsai	06/16/2022	SMT TYPE			PART No. G880XX1X3T4HR		
X.XXX	±0.10	DWG TYPE	CUST DWG	PROJECT CODE	PHD	UNIT mm		SIZE A3	DWG No. G880XX1X3T4HR	
ANGULAR	±1°	UNLESS OTHERWISE SPECIFIED		SCALE NA		SHEET 3 OF 3		REV. CX3		