

LOC	DIST	REVISIONS			
P	LTN	DESCRIPTION	DATE	DWN	APVD
A		PROPOSED	26MAR2012	WS	RP
B		REVISED PER ECO-19-009248	12JUL2019	AP	SY

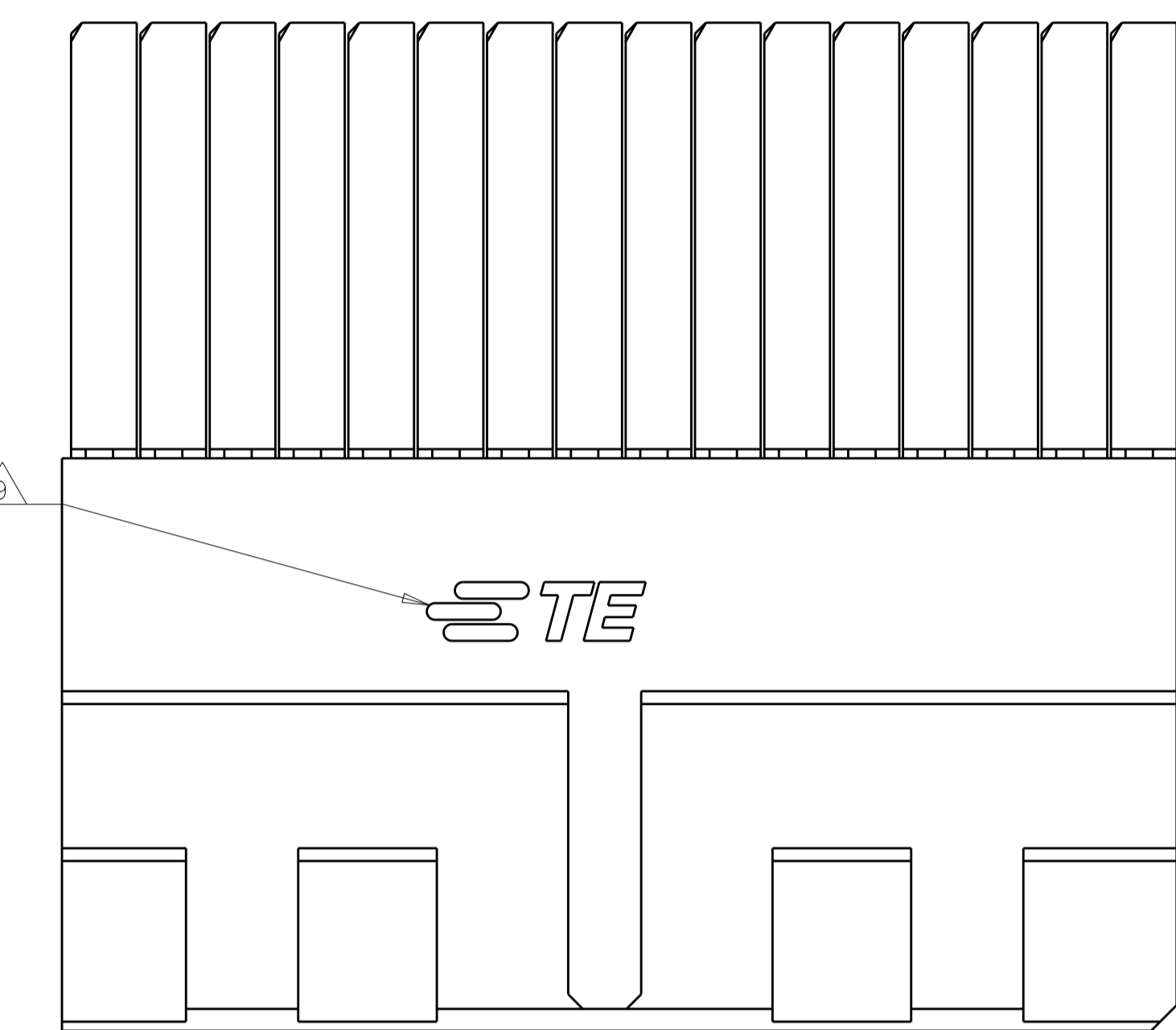

- △ MATERIAL:
 CONTACT AND SHIELD - PHOS BRONZE
 HOUSING AND CHICKLET - LCP, UL 94V-0, COLOR - BLACK
- △ FINISH:
 CONTACT: MATING AREA - 0.76µm MIN GOLD OVER 1.27µm MIN NICKEL
 COMPLIANT PIN AREA - 0.5µm MIN MATTE TIN OVER 1.27µm MIN NICKEL
 SHIELD: 1.27µm MIN NICKEL
- △ CONNECTOR MARKED ON EITHER SIDE OF HOUSING WITH PART NUMBER, DATE CODE AND STANDARD IN APPROXIMATE AREA SHOWN.
- △ DIMENSION APPLIES TO CENTERLINE OF THRU HOLE.
- △ DATUMS AND BASIC DIMENSIONS ESTABLISHED BY CUSTOMER.
- 6. CONTACT AREA LUBRICATED WITH BELLCORE APPROVED LUBRICANT. TECHNICAL REFERENCE: GR-1217-CORE, ISSUE 1, NOVEMBER 1995.
- △ REFERENCE APPLICATION SPEC 114-13202 FOR RECOMMENDED PLATED THRU HOLE DIAMETER AND PLATING THICKNESSES.
- △ THE GROUNDS IN EACH COLUMN ARE COMMONED.
- △ SHOWN LOGO OR OTHER TE OWNED LOGOS IN APPROXIMATE AREA.

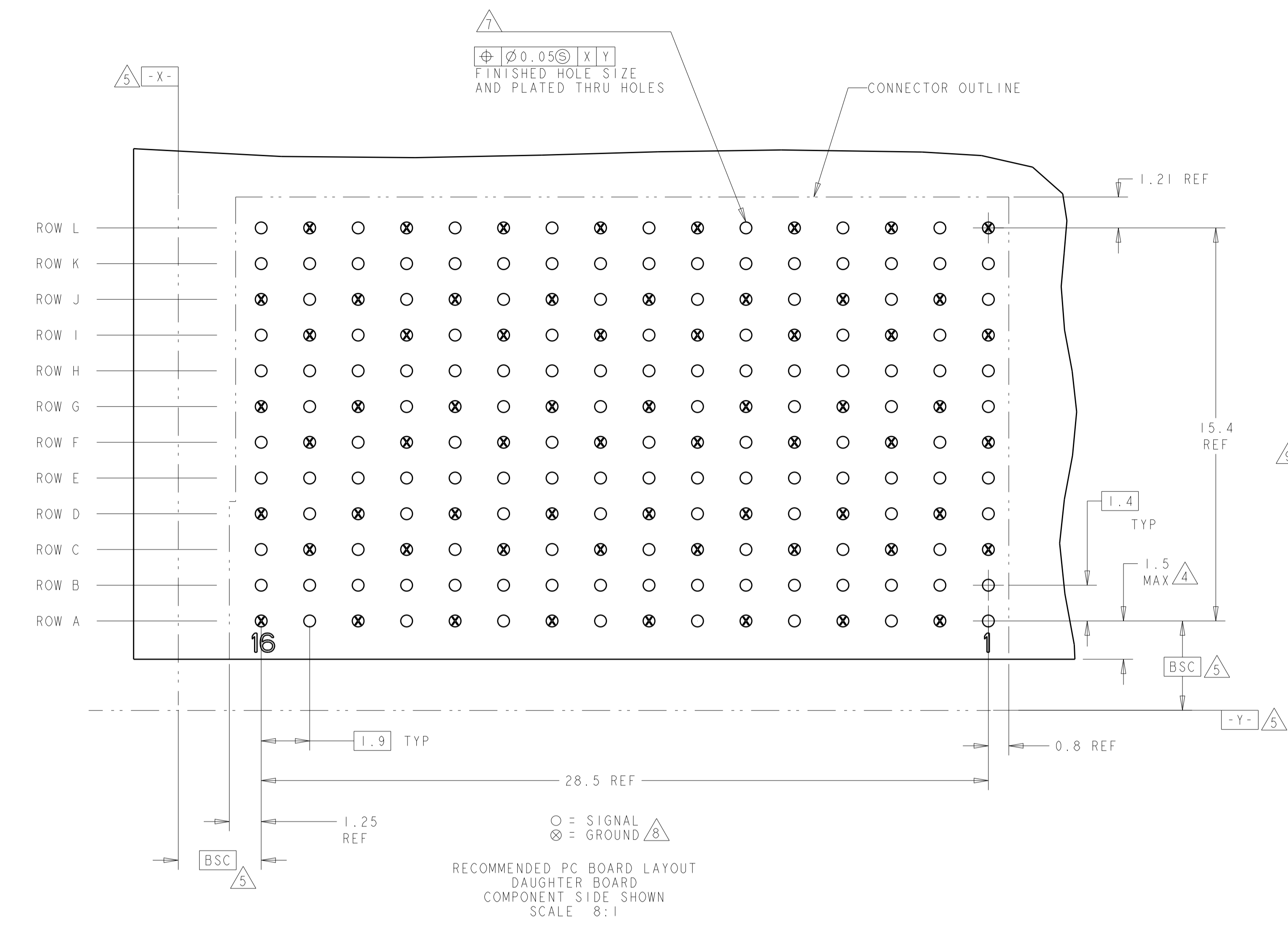
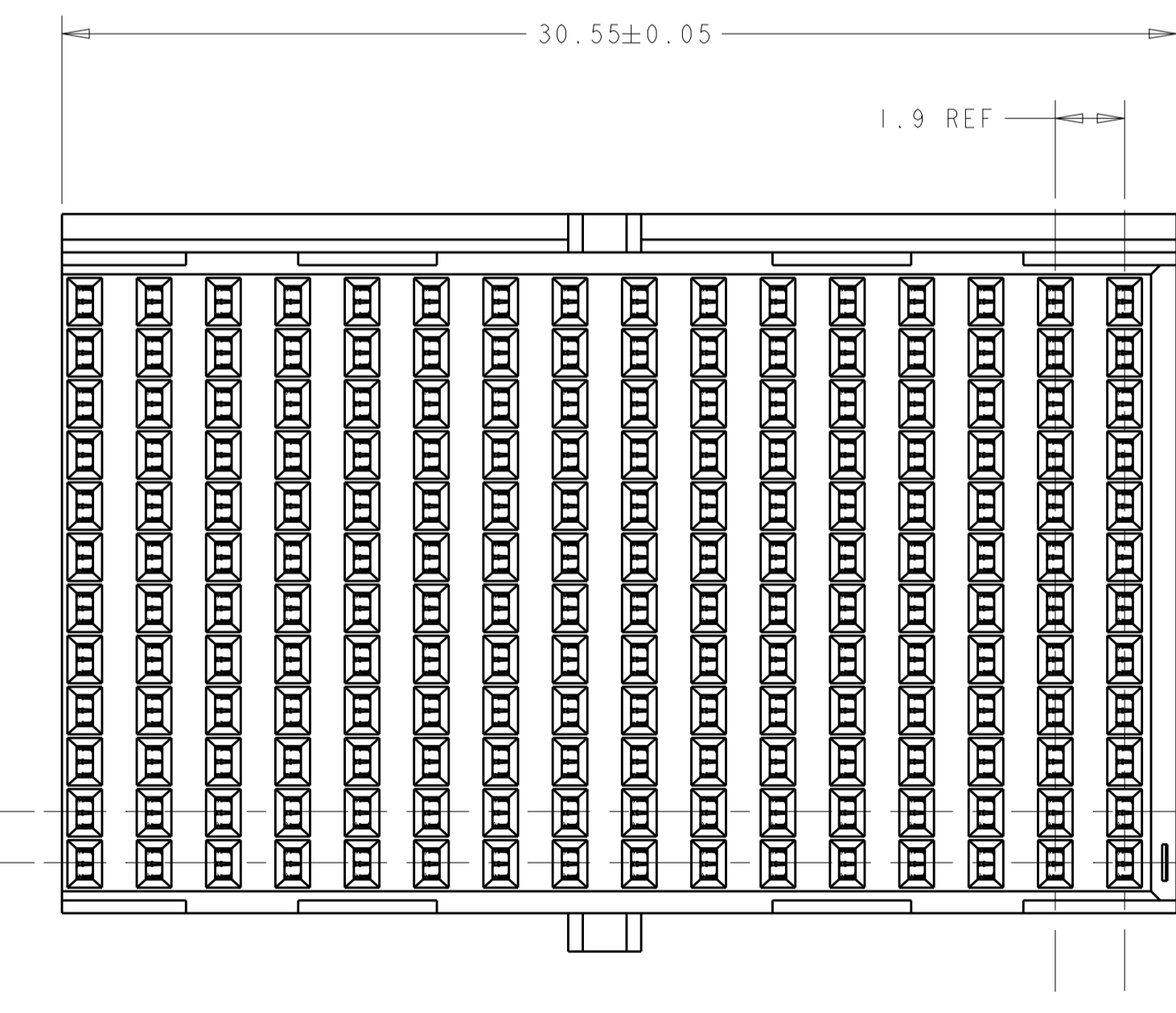
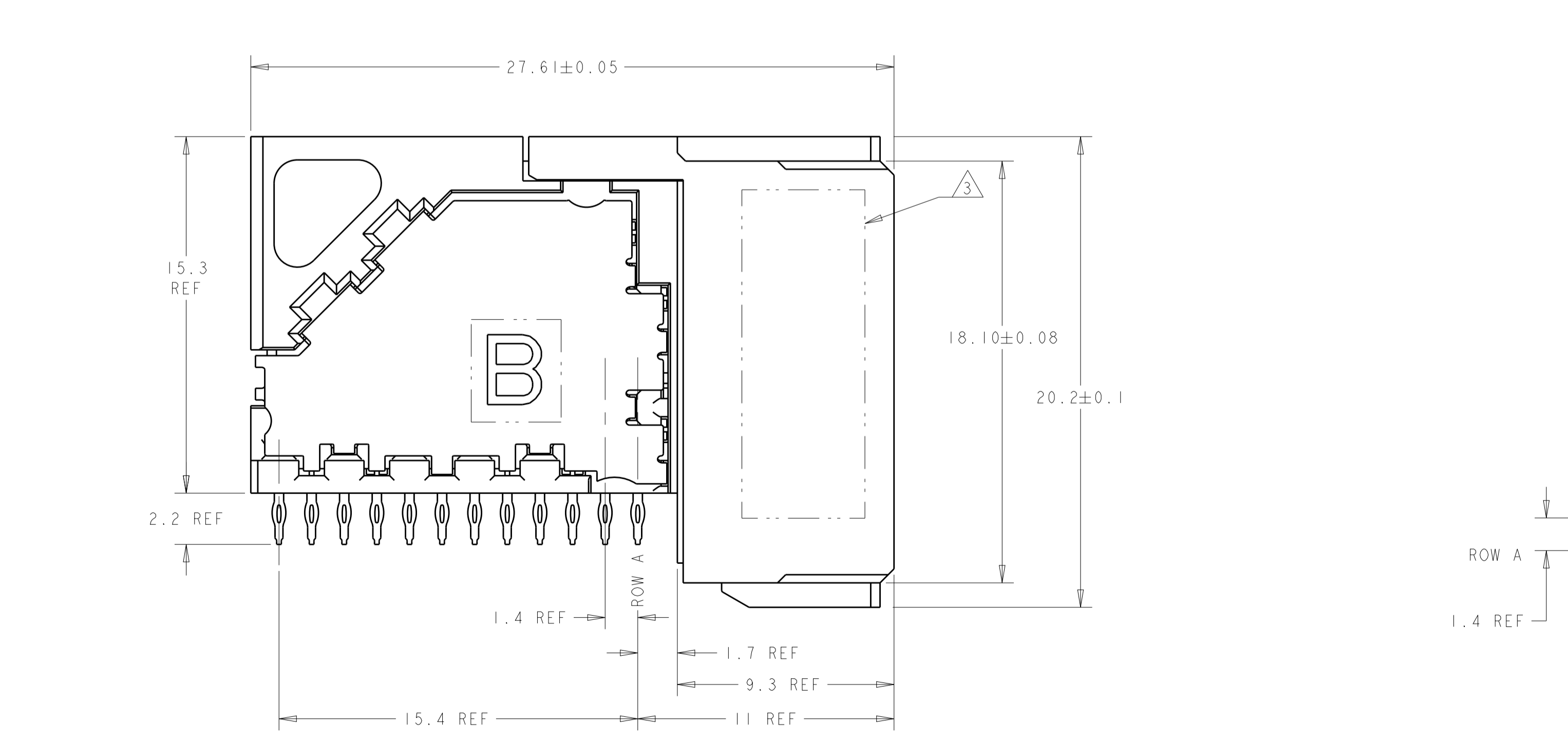

2187308-1
 PART NUMBER

THIS DRAWING IS A CONTROLLED DOCUMENT.		DWN: W. SOUBEER 26MAR2012	TE Connectivity	
DIMENSIONS: mm		CHK: R. PATTERSON 26MAR2012	RECEPTACLE ASSEMBLY, 4 PAIR, 16 COLUMN	
TOLERANCES UNLESS OTHERWISE SPECIFIED:		APVD: -	SIZE: A1	
0 PLC ±		PRODUCT SPEC	CAGE CODE: 100779	
1 PLC ±		APPLICATION SPEC	DRAWING NO: C=2187308	
2 PLC ±		WEIGHT	SCALE: 8:1	
3 PLC ±		CUSTOMER DRAWING	SHEET 1 OF 1	
4 PLC ±			REV B	
ANGLES				
FINISH				