

4

3

2

1

THIS DRAWING IS UNPUBLISHED. RELEASED FOR PUBLICATION  
 © COPYRIGHT BY TYCO ELECTRONICS CORPORATION. ALL RIGHTS RESERVED.

| LOC | DIST | REVISIONS   |                           |         |       |  |
|-----|------|-------------|---------------------------|---------|-------|--|
| P   | LTR  | DESCRIPTION | DATE                      | DWN     | APVD  |  |
| AF  | 50   | 0           | TRANSFERED TO TYCO FORMAT | 31MAR03 | MF EH |  |

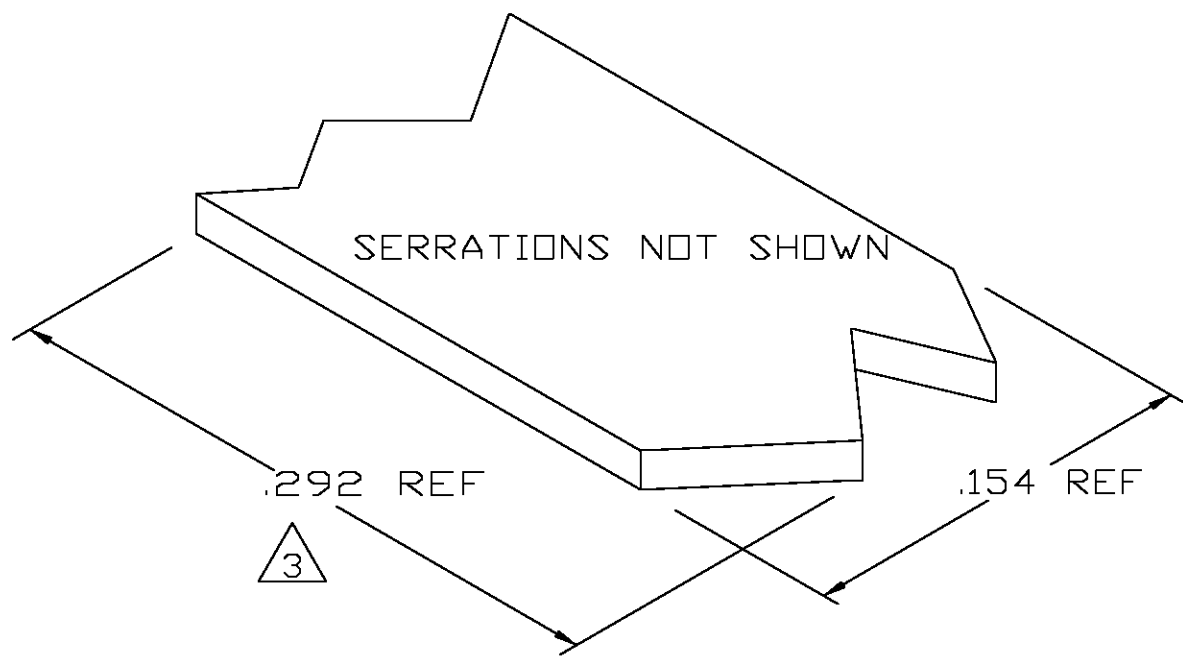

- 1 CRIMPBAND MATERIAL PROVIDED IN CONTINUOUS STRIP.
  - 2 REFERENCE DESCRIPTIVE PART NUMBER L0616R16B.
- 3 BLANK LENGTH DETERMINED BY 061 TOOLSET.

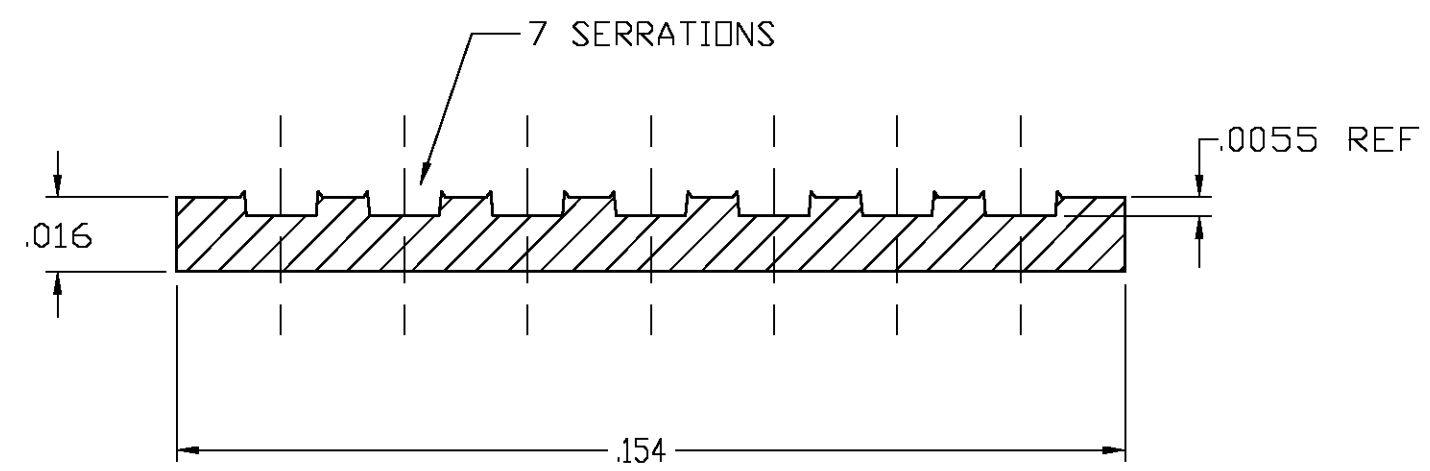

TYP. CROSS SECTION

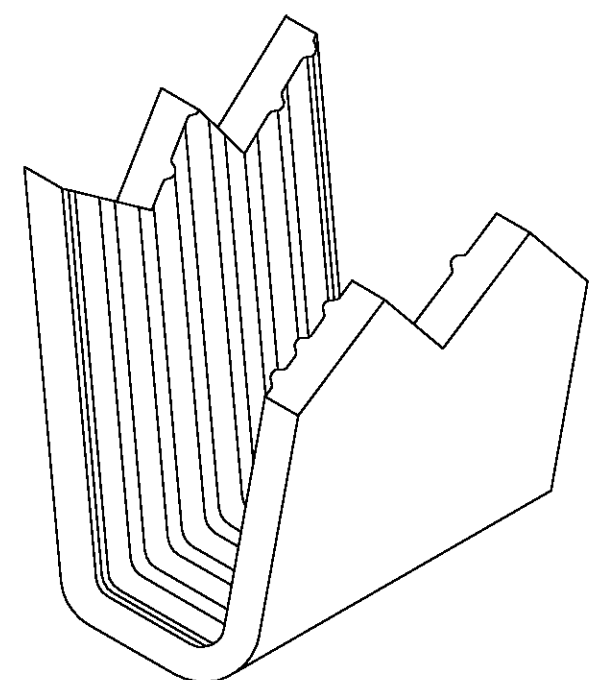

PARTIAL FORMED VIEW (REF)  
FORMED BY APPLICATION TOOLING

1601604-1  
PART NUMBER

|  |  |                                   |   |                    |
|--|--|-----------------------------------|---|--------------------|
| THIS DRAWING IS A CONTROLLED DOCUMENT.   |  | DWN 31MAR2003<br>MICHAEL S. FEHER | Tyco Electronics Corporation<br>Harrisburg, PA 17105-3608 |                    |
| DIMENSIONS:<br>INCHES  |  | CHK 31MAR2003<br>EDWARD HOWARD    |   |                    |
| TOLERANCES UNLESS OTHERWISE SPECIFIED:   |  | APVD 31MAR2003<br>EDWARD HOWARD   | NAME<br>-   |                    |
| 0 PLC ± -<br>1 PLC ± -<br>2 PLC ± -<br>3 PLC ± .005<br>4 PLC ± -<br>ANGLES ± - |  | PRODUCT SPEC<br>-                 | CRIMPBAND, MTM  |                    |
| MATERIAL<br>UNS C26000 BRASS   |  | FINISH<br>NONE                    | APPLICATION SPEC<br>-                                     | RESTRICTED TO<br>- |
|  |  | WEIGHT<br>-                       | SIZE<br>A3  | CAGE CODE<br>00779 |
|  |  | CUSTOMER DRAWING                  | DRAWING NO<br>1601604                                     | REV<br>0           |
|  |  | SCALE<br>1:1                      | SHEET<br>1 OF 1   |                    |