

RECOMMENDED PCB LAYOUT AND PART POSITIONING ONTO THE PCB

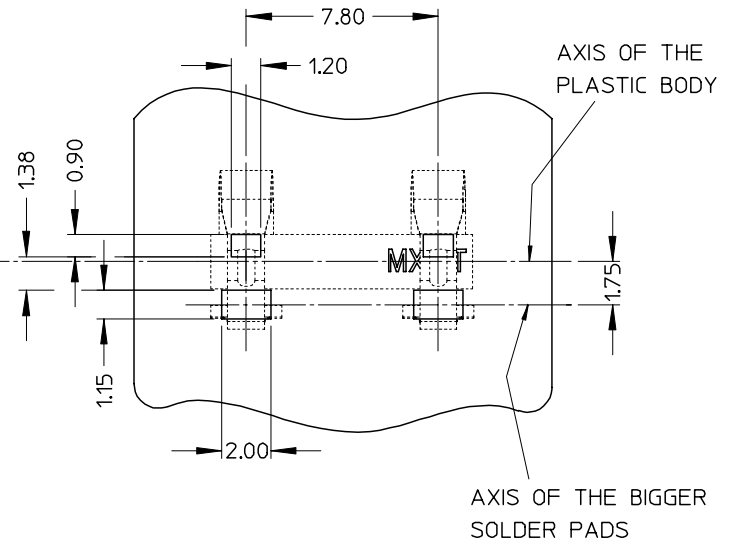
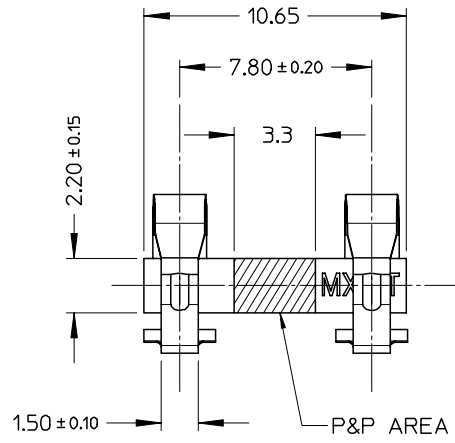

- NOTES:
- MATERIALS:
 - CONTACT: BeCu ALLOY 0.20 mm THICK
 - HOUSING: BLACK PA46, 30% G.F.
 - PLATING:
 - OVERALL: 1.27um Ni MIN
 - CONTACT AREA: 0.4um Au MIN
 - SOLDER TAIL AREA: 5-9um Sn
 - PACKAGING: TAPE & REEL. SPQ 15600 PCS (SEE DWG PK-94326-001)
 - MAX CONTACT DEFLECTION: @ 3.5mm FROM PCB
 - UNLESS OTHERWISE SPECIFIED, PRODUCT CHARACTERISTICS ARE ACCORDING TO PS-94326-001

STD. DESCR.: BATTERY CONN SMT 2 CKT

EC NO: Z2006-0086 DRWN: SBARBIE2006/02/06 CHKD: RSANDANO2006/02/08 APPR: FBISELLO 2006/02/09	QUALITY SYMBOLS	GENERAL TOLERANCES (UNLESS SPECIFIED)		SCALE 5:1	DESIGN UNITS METRIC	FIRST ANGLE PROJECTION	REVISE ON CAD ONLY		
	-0 -1	mm	INCH	DIMENSION STYLE MM ONLY		TITLE 2 CKT BATTERY CONNECTOR			
		4 PLACES	± ---	± ---	DRAWN BY	DATE			
		3 PLACES	± ---	± ---	SBARBIE	2005/08/24			
	2 PLACES	± 0.15	± ---	CHECKED BY	DATE				
	1 PLACE	± 0.3	± ---	FBISELLO	2005/08/30				
	ANGULAR		± 3 °	APPROVED BY		DATE	MATERIAL NO.	DOCUMENT NO.	SHEET NO.
	DRAFT WHERE APPLICABLE			RSANDANO	2005/08/30	94326-5002	SD-94326-001	1 OF 1	
MUST REMAIN WITHIN DIMENSIONS				THIS DRAWING CONTAINS INFORMATION THAT IS PROPRIETARY TO MOLEX INCORPORATED AND SHOULD NOT BE USED WITHOUT WRITTEN PERMISSION					