

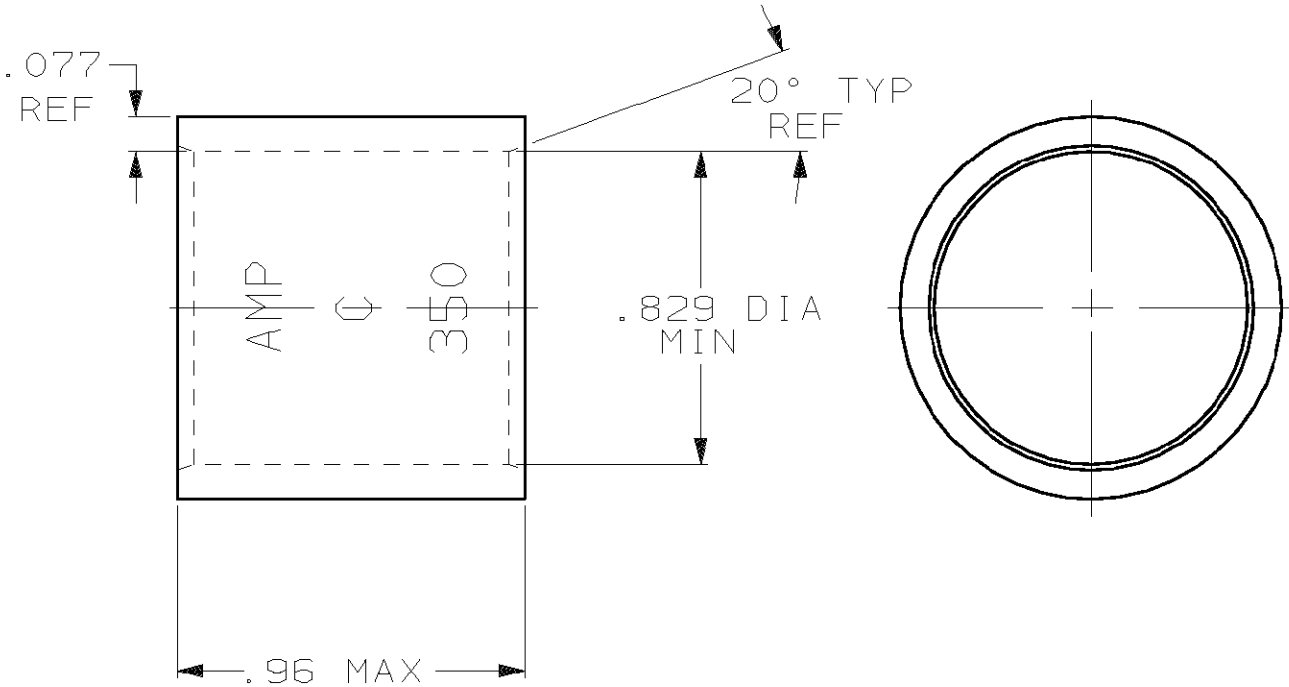

|          |            |     |   |                      |         |          |
|----------|------------|-----|---|----------------------|---------|----------|
| LOC<br>G | DIST<br>36 | P   | F | REVISIONS            |         |          |
|          |            | LTR |   | DESCRIPTION          | DATE    | APPROVED |
|          |            | E   |   | REV PER 0G3A-0637-01 | 030CT02 | JR/MS    |

- ① CLEANED, UNPLATED
- ② PREPRODUCTION - FASR REQ.



THIS DRAWING IS UNPUBLISHED. RELEASED FOR PUBLICATION BY AMP INCORPORATED. ALL INTERNATIONAL RIGHTS RESERVED. © COPYRIGHT 19

|                |  |              |
|----------------|--|--------------|
| 325-375<br>MCM | ①  | ② 1-324449-0 |
|                | TIN PL PER ASTM B 545<br>.000150 MIN THK |              |
| RANGE          | FINISH                                   | PART NO      |

|   |                             |   |                  |
|---|-----------------------------|---|------------------|
| DO NOT SCALE PRINT.<br>UNLESS SPECIFIED<br>DIMENSIONS IN INCHES<br>TOLERANCES ON:<br>2 PLC DEC ± -<br>3 PLC DEC ± -<br>ANGLES ± - | DR 1/16/89<br>P FORTNEY     | AMP INCORPORATED<br>Harrisburg, Pa. 17105                     |                  |
|   | CHK 6/20/89<br>MS FEHER     |   |                  |
|   | APPD 6/20/89<br>WJ VOCKROTH | NAME<br>WIRE SPLICE, PARALLEL,<br>AMPOWER, WIRE SIZE: 350 MCM |                  |
|   | APPD 6/20/89<br>R ADAMS     | SIZE<br><b>A</b>  | FSCM NO<br>00779 |
| MATERIAL<br>COPPER<br>ASTM-B-75<br>ANNEALED   | PRODUCT SPEC<br>-           | SCALE<br>2:1  |                  |
| FINISH<br>SEE TABLE   | APPLICATION SPEC<br>-       | SHEET<br>1 OF 1   |                  |
| WEIGHT .068 LB.   |                             |   |                  |

