

PAGE 1/2	ISSUE 07-04-15E	SERIES SMA	PART NUMBER 5919-9503-001
----------	-----------------	------------	---------------------------

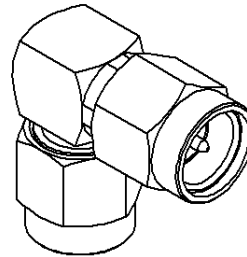

All dimensions are in mm.

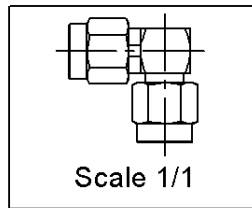
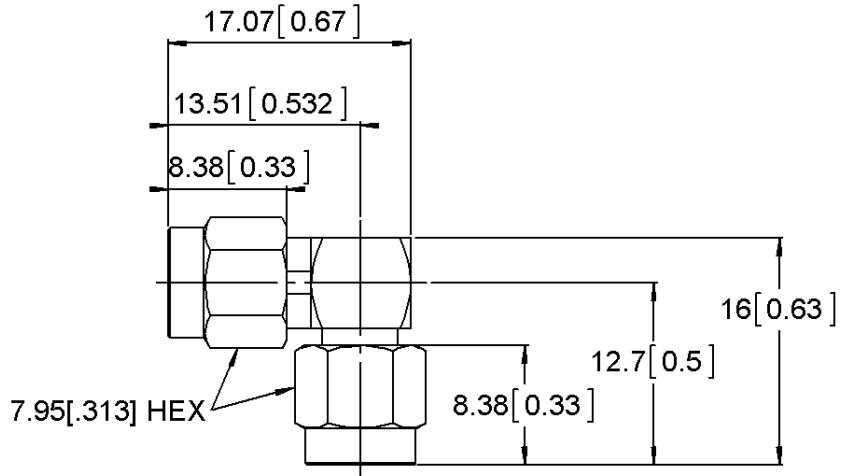
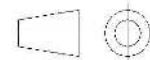

COMPONENTS	MATERIALS	PLATING (µm)
Body	STAINLESS STEEL	PASSIVATED
Center contact	BERYLLIUM COPPER, BRASS	GOLD 1.3 OVER NICKEL 2.5
Outer contact		
Insulator	PTFE	
Gasket	SILICONE RUBBER	
Others parts	BRASS, STAINLESS STEEL	PASSIVATED, NICKEL
-	-	-
-	-	-

PAGE 2/2	ISSUE 07-04-15E	SERIES SMA	PART NUMBER 5919-9503-001
-----------------	------------------------	-------------------	----------------------------------

PACKAGING

Standard	Unit	Other
100	Contact us	Contact us

ELECTRICAL CHARACTERISTICS

Impedance		50		Ω
Frequency		0-18		GHz
VSWR	*1.15	+	0.0050	x F(GHz) Maxi
Insertion loss			*.05	√F(GHz) dB Maxi
RF leakage	- (NA	- F(GHz) dB Maxi
Voltage rating			500	Veff Maxi
Dielectric withstanding voltage			1000	Veff mini
Insulation resistance			5000	MΩ mini

ENVIRONMENTAL

Operating	-65/+165	°C
Hermetic seal	NA	Atm.cm3/s
Panel leakage	NA	

MECHANICAL CHARACTERISTICS

Center contact retention				
Axial force – Mating End		27		N mini
Axial force – Opposite end		27		N mini
Torque		2.8		N.cm mini
Recommended torque				
Mating		90		N.cm
		90		N.cm
		0		N.cm
Panel nut		NA		N.cm
Mating life		500		Cycles mini
Weight	6.1800			g

SPECIFICATION

OTHER CHARACTERISTICS

***0-12.4 GHz**