

THIS DRAWING IS UNPUBLISHED. RELEASED FOR PUBLICATION  
 © COPYRIGHT - By - ALL RIGHTS RESERVED.

REVISIONS					
P	LTR	DESCRIPTION	DATE	DWN	APVD
A4		REVISED PER ECR-18-018655	11DEC2018	BW	SV

- 1 CONTINUOUS STRIP ON REELS WITH TERMINALS LOCATED ON 5.59±0.08 [.220±.003] CENTERS.
- 2 SLOT ACCEPTS A SINGLE OR DOUBLE 0.36-0.57mm [#27-#23] AWG COPPER MAGNET WIRE OR SLOT ACCEPTS A SINGLE OR DOUBLE 0.51-0.64mm [#24-#22] AWG ALUMINUM MAGNET WIRE. ALUMINUM WIRE RANGE APPLIES FOR POST-TIN PLATED VERSIONS ONLY.
- 3 AFTER INSERTION INTO PLASTIC HOLDER TAB PORTION MUST BE BENT OVER 45° TO 90° OR POTTED TO PREVENT PULL-OUT WHEN MATING RECEPTACLE IS DISCONNECTED.
- 4 PRELIMINARY - NOT FOR PRODUCTION.

IDENTIFICATION NUMBER 10 FOR MAGNET WIRE RANGE

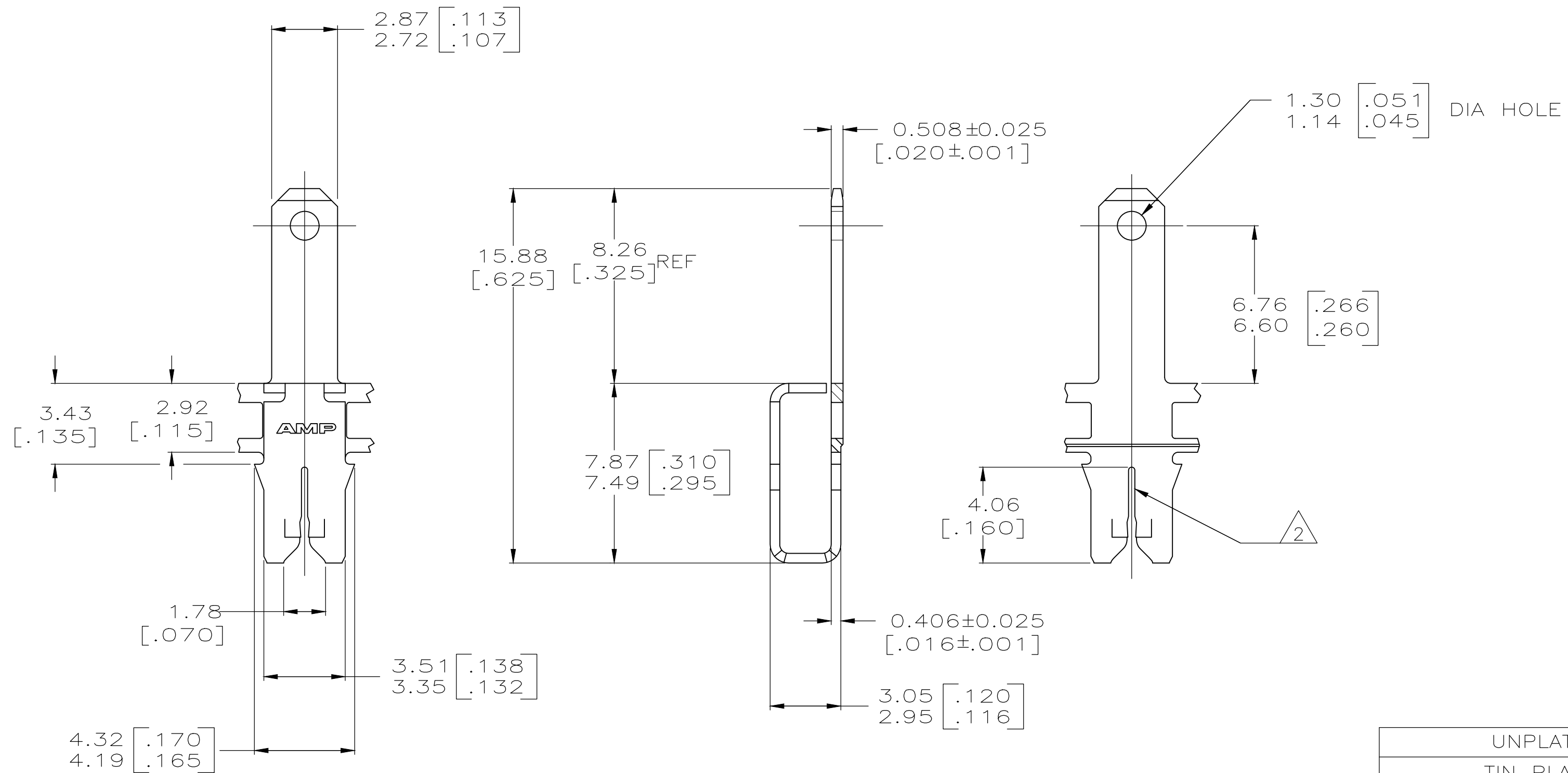
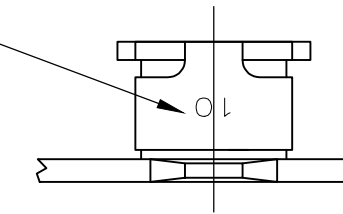

UNPLATED	4 63746-2
TIN PLATED	63746-1
FINISH	PART NO

THIS DRAWING IS A CONTROLLED DOCUMENT.		DWN 11/JAN/94 MICHAEL S. FEHER	TE Connectivity Ltd.	
DIMENSIONS: mm [INCHES]		CHK 13/JAN/94 PHILLIP M. FORTNEY		
TOLERANCES UNLESS OTHERWISE SPECIFIED:		APVD 14/JAN/94 NELSON E. NEFF	NAME TAB, 2.79 [.110] FASTON™ MAG-MATE™	
0 PLC ± -		PRODUCT SPEC 108-2012	SIZE CAGE CODE DRAWING NO RESTRICTED TO	
1 PLC ± -		APPLICATION SPEC 114-2046	A2 00779 C=63746	
2 PLC ± 0.25 [.010]		MATERIAL BRASS	SCALE 6:1 SHEET 1 OF 1 REV A4	
3 PLC ± -		FINISH SEE TABLE		
4 PLC ± -				
ANGLES ± -				
		CUSTOMER DRAWING		