



365 MHz LC Bandpass Filter

Part Number: AE365B6743



Electrical specifications

Center Frequency: 365 MHz
1dB Bandwidth: 38 MHz
Passband: 346-384 MHz
Insertion Loss: 2 dB Max
Return Loss: 14 dB Min
Ripple: 0.1 dB
Rejection: >20 dB @ 0-296 MHz
 >50 dB @ 692-1300 MHz
Power Handling: 10 W

Mechanical

Dimensions: 2.1 x 0.85 x 0.43 inches

Environmental

Operating Temperature: -55 to +85° C
Shock: 30 G. 11ms
Vibration: 10 G. 5 to 1000 Hz

Outline Drawing:

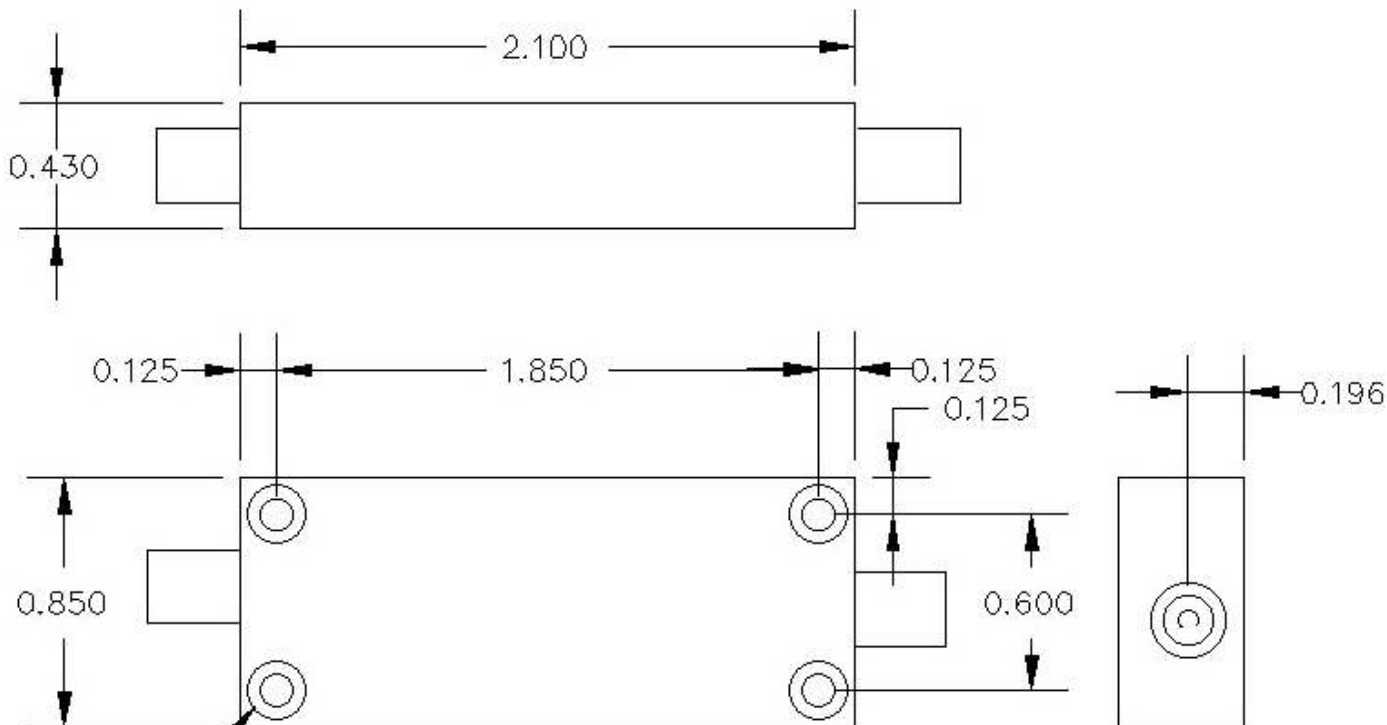

HOLE .106" DIA THRU,
C'BORE .204" DIA .079" DP 4PL

986991