

PC card drilling dimensions(after plating)  
(thickness 2.40±0.20mm)

LEAD FREE PART NUMBER

SHELL	A±0.38	B±0.12	C±0.10	D±0.25	E±0.07	PART NUMBER
09	30.81	24.99	16.96	16.21	10.96	D09S24B.PX00LF
15	39.14	33.32	25.18	24.54	19.18	D15S24B.PX00LF
25	53.03	47.04	39.12	38.25	33.12	D25S24B.PX00LF
37	69.32	63.50	55.68	54.71	49.68	D37S24B.PX00LF

Plating: 4 --> flash AU  
Plating: 6 --> 0.76µ AU

Notes:

1) The nut can protrude above the surface of insulator but maintaining the footprint dimension 6±0.15 mm.

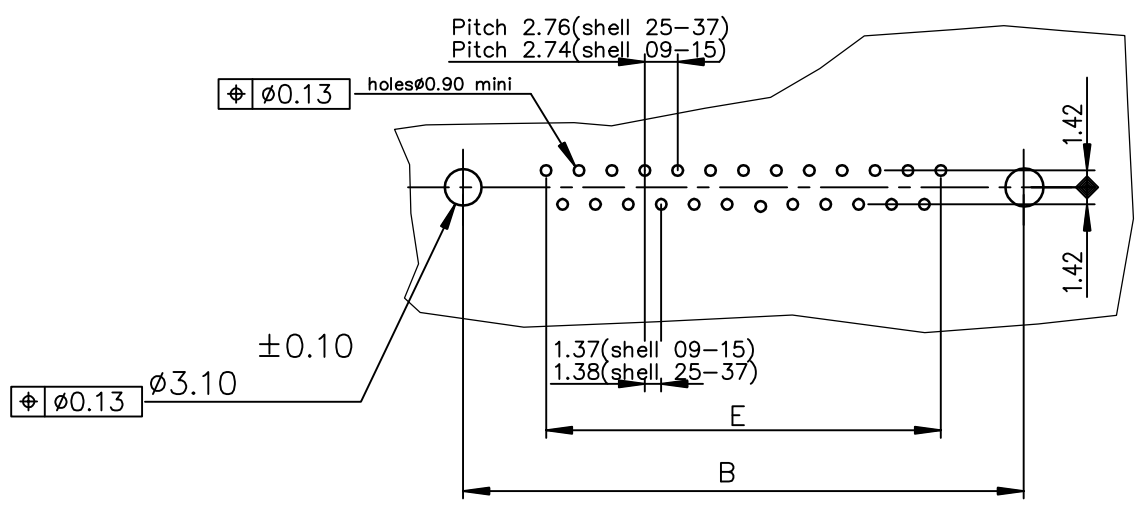

GENERAL CHARACTERISTICS AND ROHS INFORMATIONS:  
SEE DRAWING C01-8646-0000

mat'l. code		surface		tolerance		projection		product family	
-		ISO 1302 ✓		ISO 406 ISO 1101				D-SUB	
ltr		ecn no	dr	date		tolerances unless otherwise specified		title	
E	ELX-I-22878	AB	2015/01/06		angles linear 0°±2' .00±0.1 .000±0.1				FEMALE CONNECTOR DELTA-D STRAIGHT - SOLDER TYPE FOR PCB 2.4mm
dr		LELEON		1992/09/16		scale 2:1		dwg no	
enr		ALIAS BABU		2015/01/06				sheet 1 of 1	
chr		MITHUN PAUL		2015/01/06		C01-8646-0122		size	
app		BIJU K PAUL		2015/01/06		type Product Customer Drawing		A3	
sheet index	revision sheet	E	1						