



DC-18 GHz

## Coaxial Adapters Type N

- Low VSWR
- Stainless Steel Precision Connectors

### Specifications

Type N (M/F) to SMA (M/F) Gender Changing, DC to 18 GHz

| FREQUENCY RANGE<br>(GHz) | MODEL | VSWR (max.) | WEIGHT (max.) |     | CONNECTORS   |
|--------------------------|-------|-------------|---------------|-----|--------------|
|                          |       |             | oz.           | gr. |              |
| DC-18                    | 55    | 1.25        | 1.5           | 43  | SMA-F to N-M |
|                          | 56    | 1.25        | 2.0           | 57  | SMA-M to N-M |
|                          | 57    | 1.25        | 1.5           | 43  | SMA-M to N-F |
|                          | 58    | 1.25        | 1.0           | 28  | SMA-F to N-F |
|                          | 76    | 1.20        | 2.0           | 57  | N-M to N-M   |
|                          | 77    | 1.20        | 2.5           | 71  | N-F to N-F   |

# Adapters

## Outline Drawings

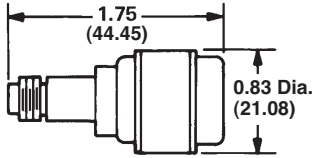

**Model 55**  
SMA-F to N-M

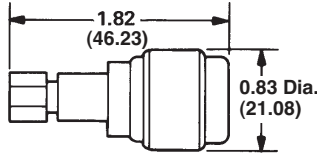

**Model 56**  
SMA-M to N-M

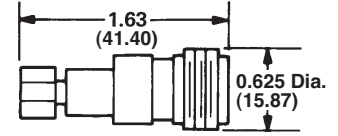

**Model 57**  
SMA-M to N-F

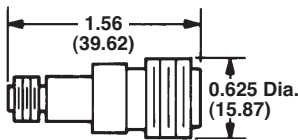

**Model 58**  
SMA-F to N-F

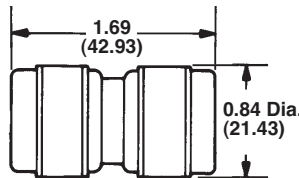

**Model 76**  
N-M to N-M

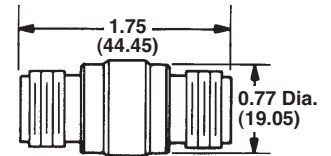

**Model 77**  
N-F to N-F

Dimensions in inches (mm in parentheses), unless otherwise specified.

