

# HIGH CURRENT CABLE CONNECTORS

A choice of 2 and 3 way high reliability Power Connectors with crimp and solder-bucket terminations.



- 10 Amp current rating
- Fully polarised housings
- Latching for strain-relief
- Back Potting for Sealing Protection Ratings of IP55, combined with "O" ring for IP67. Order Code K3605-00
- Supplied loose for customer assembly
- Standard colour grey. Contact Technical Sales for other colours and plating options
- For Tooling see below
- Wire size: 18 AWG

## MALE HOUSING

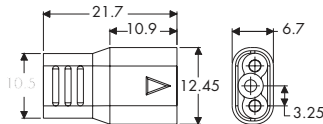

### Order Code

2 way K3600-91

3 way K3700-91

## FEMALE HOUSING

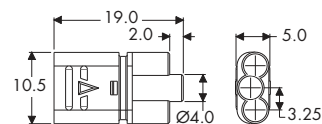

### Order Code

2 way K3601-91

3 way K3701-91

## CONTACTS

### MALE SOLDER BUCKET

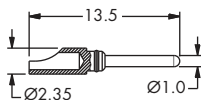

### Tin Plated Order Code

K3602-06

### FEMALE SOLDER BUCKET

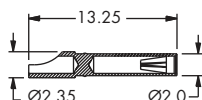

### Tin Shell, Tin Contact Order Code

K3603-T6

### MALE CRIMP CONTACT

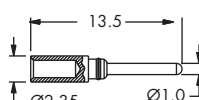

### Tin Plated Order Code

K3606-06

### FEMALE CRIMP CONTACT

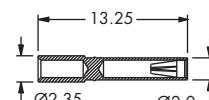

### Tin Shell, Tin Contact Order Code

K3607-T6

## CRIMP BARREL SIZE

| Wire Size (AWG) | Crimp Tool Setting | Pull-off Force (Newtons) |
|-----------------|--------------------|--------------------------|
| 18              | 8                  | 142N                     |

Insertion/Withdrawal Tool Order Code:  
**ZK3610-00**

Order Code:  
**M22520/2-01**  
(Use with Positioner)

Positioner Order Code:  
**ZK3609-00**  
(Use with Crimp Tool)

## WIRE STRIPPING DETAILS

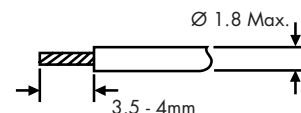

# TOOLING FOR POWERFIT SERIES

Extraction Tool Order Code: **ZKF-021**

## HAND CRIMP TOOL

Order Code: **ZKF-020**

## SEMI AUTOMATED TOOLING

Machine Order Code: **ZGP-PEO**

| Contact Order Code | AWG   | Mini Applicator | Spares  |
|--------------------|-------|-----------------|---------|
| KF-4400006         | 16-20 | ZKF-022         | ZKF-023 |
| KF-4410006         | 22-24 | ZKF-024         | ZKF-025 |
| KF-4600006         | 16-20 | ZKF-022         | ZKF-023 |
| KF-4610006         | 22-24 | ZKF-024         | ZKF-025 |
| KF-4620006         | 26-28 | ZKF-026         | ZKF-027 |