

PRODUCT NUMBER SEE SHEET 2

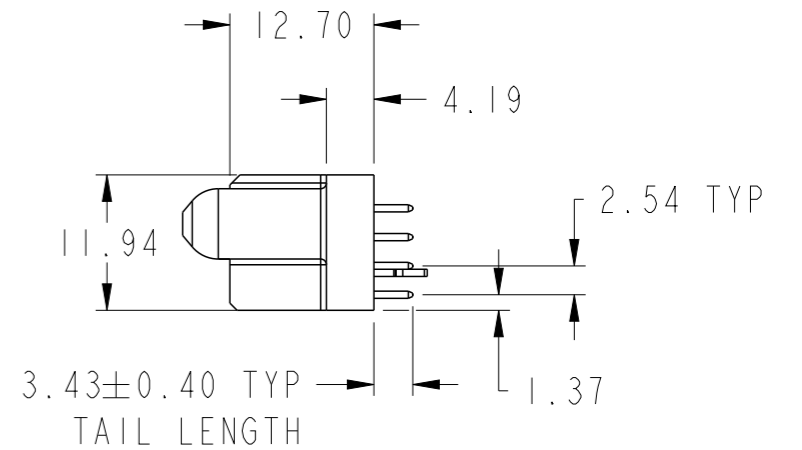
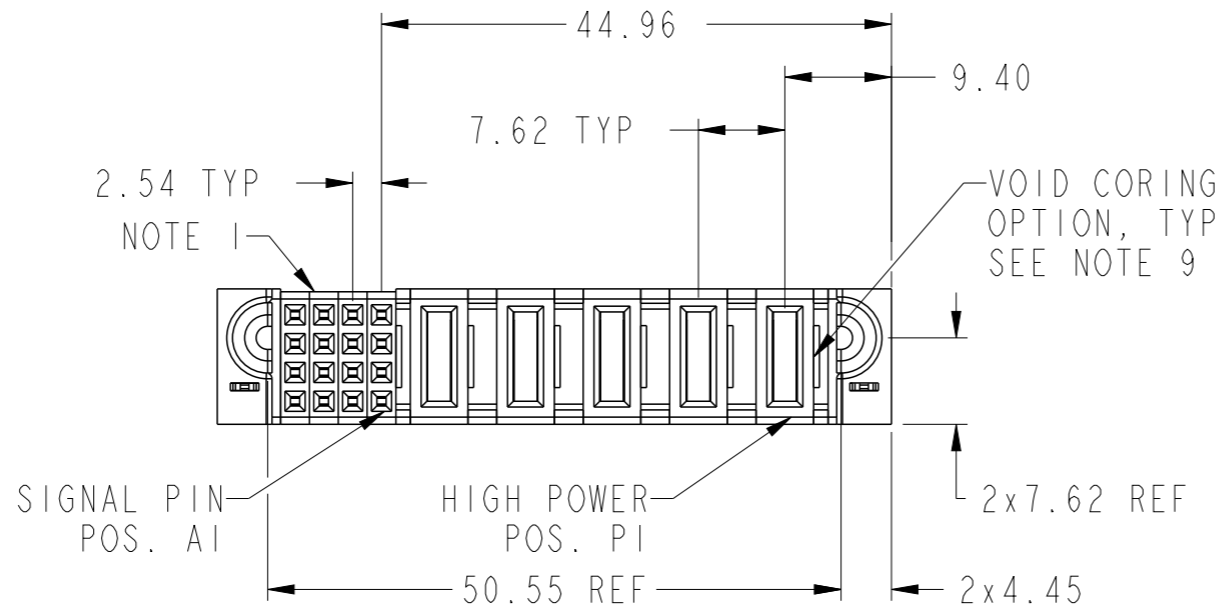
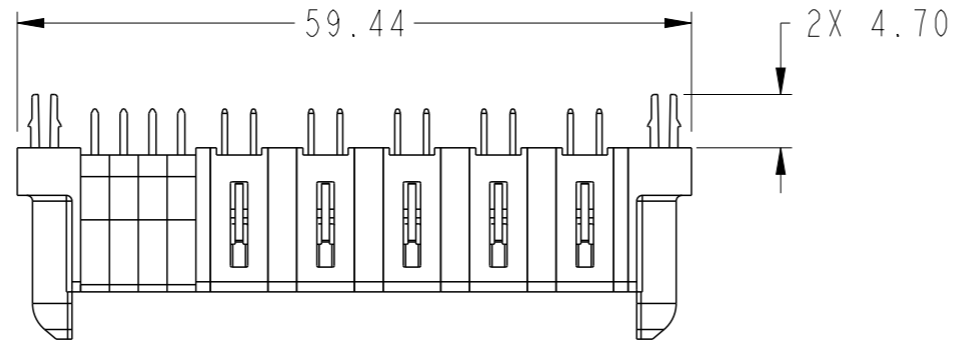
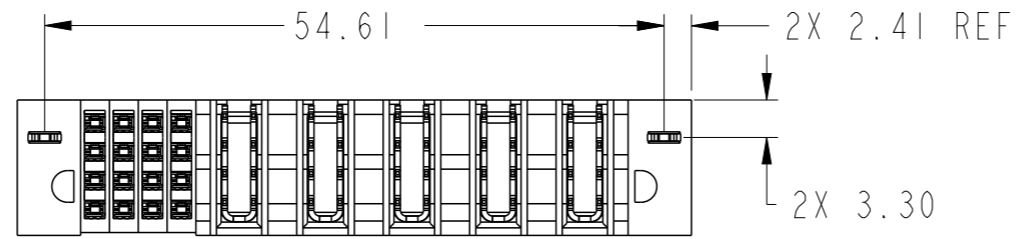

Amphenol  
FCi

© 2016 AFCI

spec ref		dr	Vicking Liu	2016/04/21	projection	MM	size	A3	scale	3:2
tolerance std ASME Y14.5		TOLERANCES UNLESS OTHERWISE SPECIFIED			eng	Vicking Liu	2016/05/25	ecn no		
		chr	Fancy Zhang	2016/05/25	product family		PowerBlade+	rel level		
		appr	Pei-Ming Zheng	2016/05/25				Released		
surface	linear	0.X	±0.50	Amphenol FCi	5ACP + 16S		dwg no	10106122-5004001		rev
		0.XX	±0.25		VT STB RECEPTACLE				A	
		0.XXX	±0.10							
ASME Y14.5	angular	0°	±2°	cat. no.	Product - Customer Drw			sheet 1 of 3		

PRODUCT NO.	ROWS	SIGNAL					HIGH POWER					E1	E2
		4	3	2	1	P5	P4	P3	P2	P1			
10106122-5004001LF	DCBA						H3	H3	H3	H3	H3	HA	HA

CODE	DESCRIPTION
E	STD SIGNAL CONTACT
H3	STD HIGH POWER CONTACT (3.43)
HA	METAL HOLD DOWN

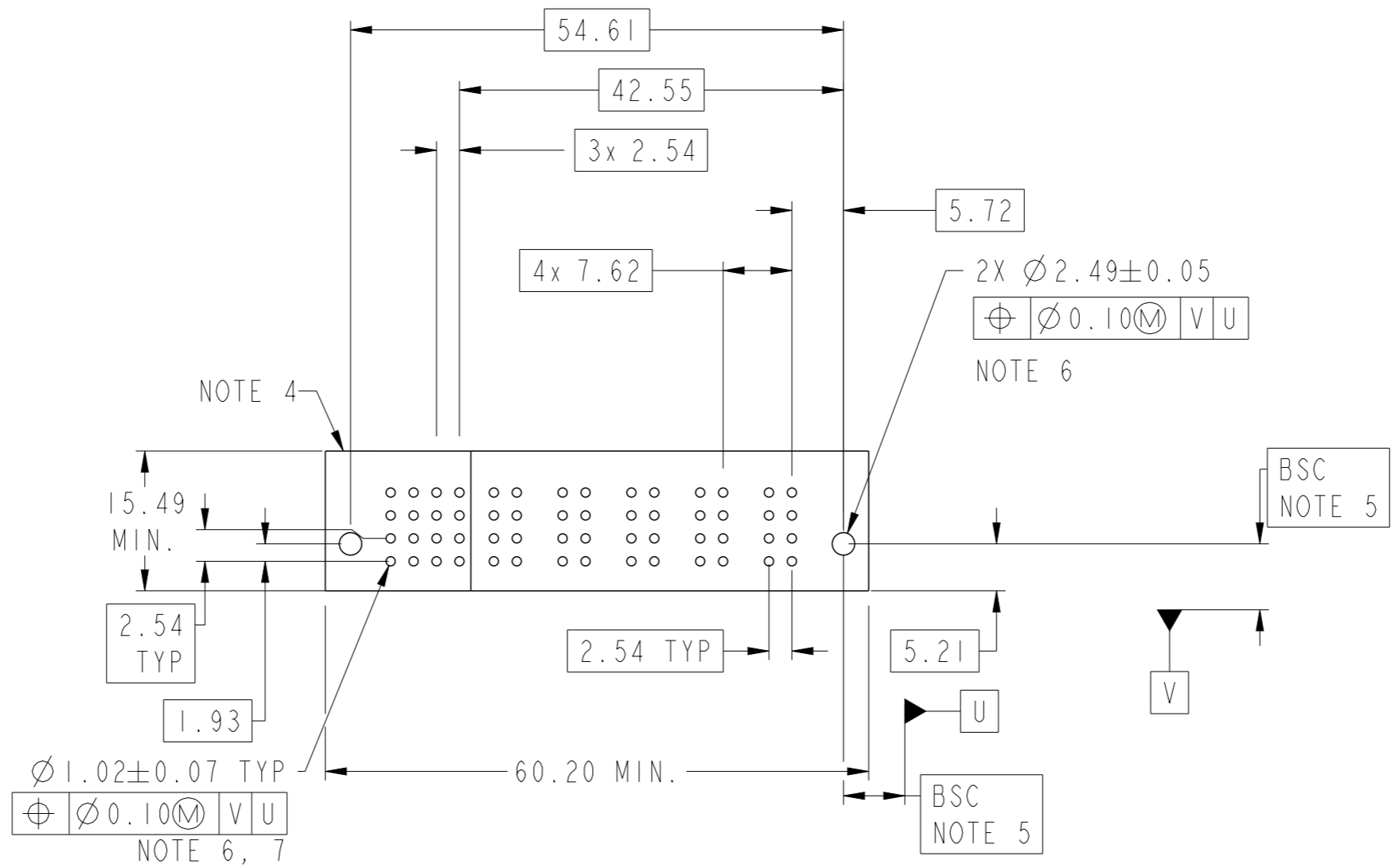

Amphenol  
FCi

© 2016 AFCI

spec ref	dr	Vicking Liu	2016/04/21	projection	MM	size	A3	scale	3:2
tolerance std	eng	Vicking Liu	2016/05/25			ecn no	-	rel level	Released
ASME Y14.5	chr	Fancy Zhang	2016/05/25						
TOLERANCES UNLESS OTHERWISE SPECIFIED				product family	PowerBlade+				
surface	linear	0.X	±0.50		5ACP + 16S VT STB RECEPTACLE	dwg no	10106122-5004001	rev	A
		0.XX	±0.25						
		0.XXX	±0.10						
ASME Y14.5	angular	0°	±2°	cat. no.	Product - Customer Drw	sheet 2 of 3			

A

B

C

D

A

B

C

D

NOTES:

- 1) "FCI", PART NUMBER AND DATE CODE TO BE MARKED ON THIS SURFACE.  
THE MARK CAN BE OMITTED IF THERE IS NOT ENOUGH SPACE ON THIS SURFACE.
- 2) MATERIALS:  
-HOUSING - GLASS FILLED WITH HIGH TEMP THERMOPLASTIC, UL94V-0.  
-SIGNAL CONTACT - COPPER ALLOY.  
-POWER CONTACT - HIGH CONDUCTIVITY COPPER ALLOY.
- 3) PLATING SPECIFICATION REFER TO FCI 10116351
- 4) DENOTES CONNECTOR KEEP OUT ZONE.
- 5) DATUM AND BASIC DIMENIONS WERE ESTABLISHED BY CUSTOMER.
- 6) ALL HOLE DIAMETERS ARE FINISHED HOLE SIZES.
- 7) 1.15 ± 0.025MM DRILLED HOLE PLATED WITH 0.00762MM MIN Sn  
OVER 0.0254-0.0762MM Cu PLATING TO ACHIEVE A 1.02 ± 0.07MM HOLE.
- 8) PRODUCT SPECIFICATION REFER TO FCI GS-12-658.  
APPLICATION SPECIFICATION REFER TO FCI GS-20-141.  
PRODUCT PACKAGED IN TRAYS, REFER TO FCI GS-14-1502.
- 9) THE VOID CORING IN BETWEEN POWER MODULES, SIGNAL  
MODULES AND END MODULES ARE OPTIONAL AND THE SHAPE  
MAY BE DIFFERENT FOR OPTIMIZE THE MOLDING PROCESS. THE  
VOID CORING WILL NOT EFFECT TO PRODUCT FUNCTION.

Amphenol  
FCi

© 2016 AFCI

spec ref		dr	Vicking Liu	2016/04/21	projection	MM	size	A3	scale	1:1
tolerance std	TOLERANCES UNLESS OTHERWISE SPECIFIED	eng	Vicking Liu	2016/05/25		←→	ecn no	-	rel level	Released
ASME Y14.5		chr	Fancy Zhang	2016/05/25						
		appr	Pei-Ming Zheng	2016/05/25						
surface	linear	0.X	±0.50	Amphenol FCi	5ACP + 16S VT STB RECEPTACLE	cat. no.	Product - Customer Drw	sheet 3 of 3	rev	A
ASME Y14.5	angular	0.XX	±0.25							
		0.XXX	±0.10							
		0°	±2°							