



Electrical specifications

Center Frequency: 1621 MHz
Bandwidth: 10 MHz
VSWR: 1.5:1
Input / Output Impedance: 50 Ohms
Passband: 1616-1626 MHz
Passband Insertion Loss: 2.0 dB max
Passband Ripple: 0.3 dB max
Rejection: 20 dB min at 1585 MHz
Rejection 2: 50 dB min at 2000 MHz
Power Handling: 3 watt max

Mechanical

Mounting Method: SMT
Dimensions: 14 x 13 x 4.5 mm

Environmental

Operating Temperature: -30°C to 80°C
Storage Temperature: -50°C to +90°C

This product is RoHs compliant.

Outline Drawing:

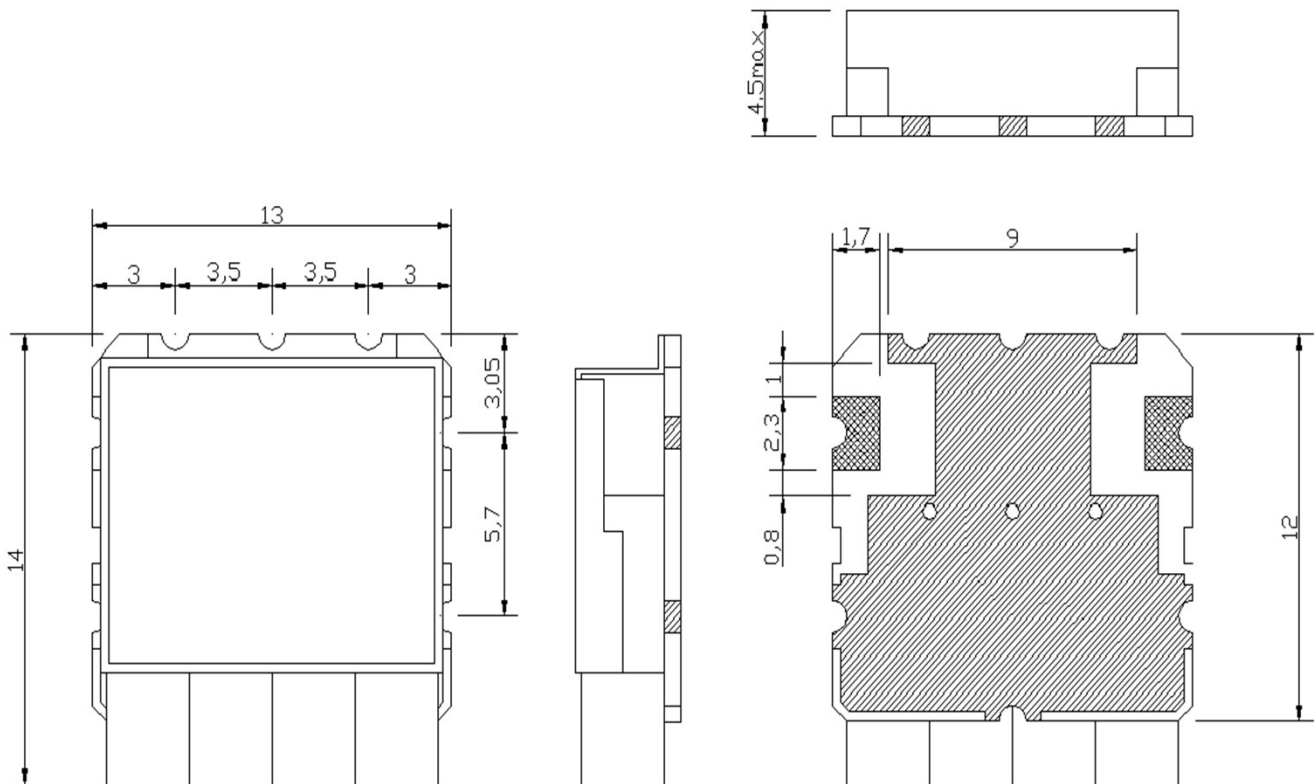

Unit:mm
Tolerance:±0,3



PCB Layout:

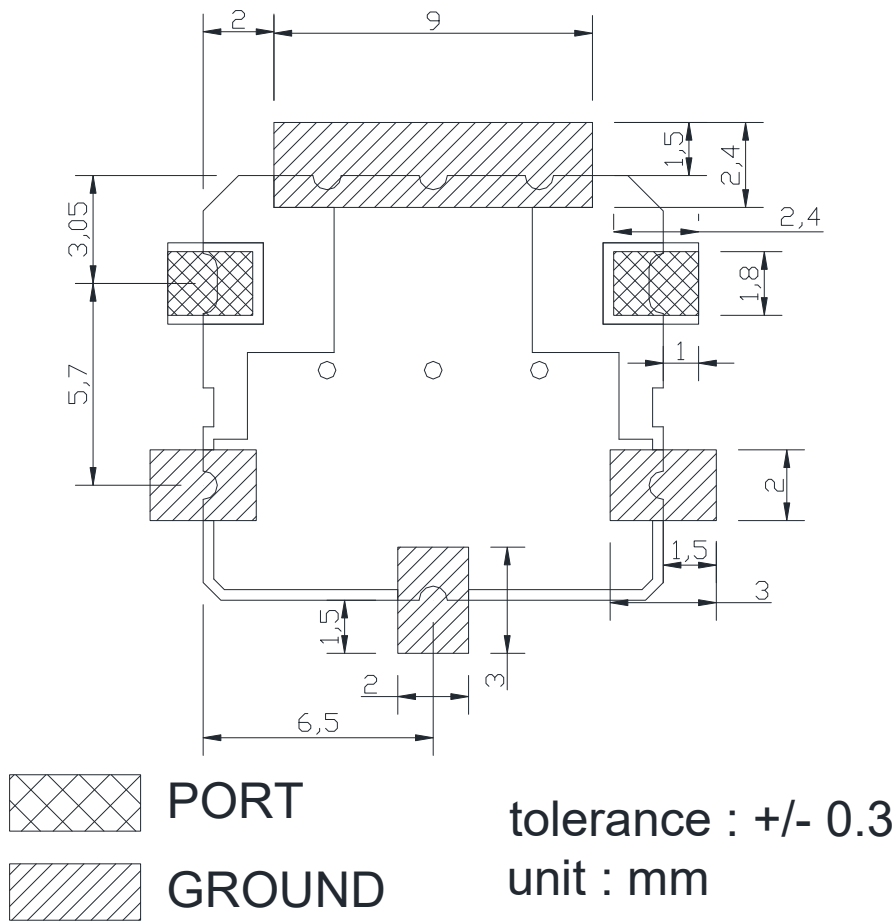



ANATECH ELECTRONICS INC
RF & Microwave Filters & Products

1621 MHz Ceramic Bandpass Filter

Part Number: AM1621B1261



Response Plot:

