

NOTES:

- MATERIALS:
 - HOUSING MATERIAL AND DRAIN HOLE OPTIONS:
 - 1=NYLON 6/6, UL94 V-2, COLOR: NATURAL, WITHOUT DRAIN HOLES
 - 2=NYLON 6/6, UL94 V-0, COLOR: NATURAL, WITHOUT DRAIN HOLES
 - 4=NYLON 6/6, UL94 V-0, COLOR: NATURAL, WITH DRAIN HOLES
 - TERMINAL:
 - COPPER ALLOY
- TERMINAL PLATING:
 - 1=.000100/(0.00254) MIN. MATTE TIN OVER .000050/(0.00127) MIN. NICKEL
- PRODUCT SPECIFICATION: PS-44476-001
- PACKAGING: TRAY PACKED PER PK-5566-002
- PART MATES WITH MINI-FIT JR. RECEPTACLE NO. 5557.
- PART IS NOT DESIGNED FOR CURRENT SHARING.
- PARTS ARE NOT TO BE MATED OR UN-MATED WHILE CIRCUITS ARE LIVE.
- PARTS PRODUCED AFTER JULY 1, 2004 WILL HAVE "HCS" MARKING INSTEAD OF BLACK STRIPE.
- PART CONFORMS TO CLASS "B" REQUIREMENTS OF COSMETIC SPECIFICATION PS-45499-002.

ITEM NO.	PLATING (SEE NOTE 2)	ASS'Y. OPT.
44472-0311		1
44472-0312		2
44472-0314		4

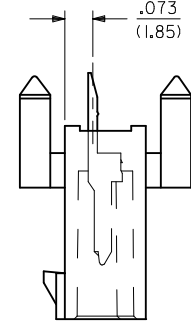
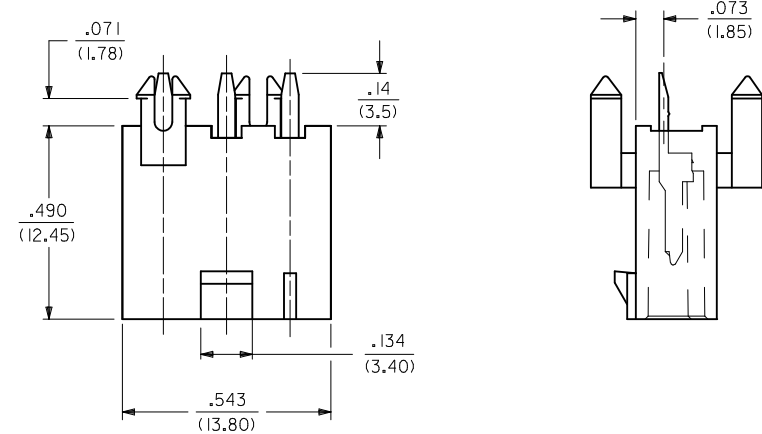

LEGEND

44472 - 03 * *

BASE NO. _____

CIRCUIT SIZE _____

PLATING (SEE NOTE 2) _____

HOUSING MAT'L. & OPTIONS _____

- 1 = 94V-2, W/O DRAIN HOLES
- 2 = 94V-0, W/O DRAIN HOLES
- 3 = 94V-2, WITH DRAIN HOLES
- 4 = 94V-0, WITH DRAIN HOLES

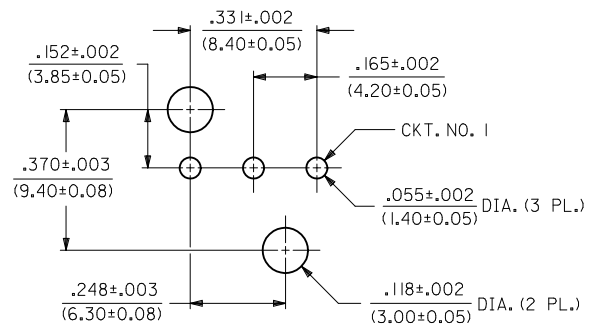
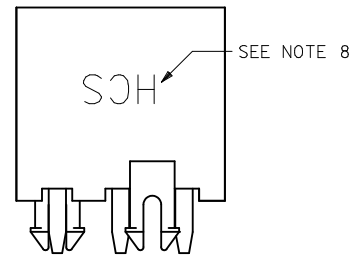
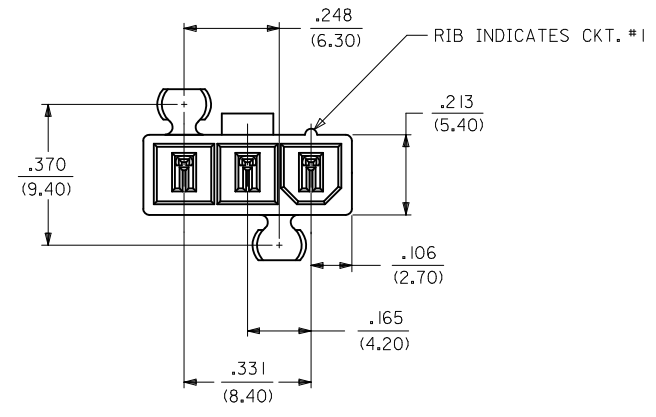

RECOMMENDED HOLE LAYOUT FOR .070/(1.78) MAX. THICK P. C. BOARD

CHANGE PLATING EC NO: UCP2012-1560 DRAWN: NGUYEN 2012/01/09 CHKD: J. BELL 2012/01/09 APPR: FSM/TH 2012/02/02	QUALITY SYMBOLS ▽=0 ▽=0 ▽=0	GENERAL TOLERANCES (UNLESS SPECIFIED)		DIMENSION STYLE IN/MM	SCALE 4:1	DESIGN UNITS METRIC	THIRD ANGLE PROJECTION	
		4 PLACES ± --- ± ---	3 PLACES ± --- ± .10	2 PLACES ± 0.25 ± .015	1 PLACE ± 0.38 ± ---	ANGULAR ± 1/2°	DRAFT WHERE APPLICABLE MUST REMAIN WITHIN DIMENSIONS	MATERIAL NO. SEE CHART
DRAWN BY: GEP DATE: 1994/07/25 CHECKED BY: R.J.F. DATE: 1994/07/25 APPROVED BY: R.J.F. DATE: 1994/07/25 TITLE: VERT. HDR. ASS., 3 CKT. SINGLE ROW, WITH & W/O DRAIN HOLES, MINI-FIT MOLEX INCORPORATED								
THIS DRAWING CONTAINS INFORMATION THAT IS PROPRIETARY TO MOLEX INCORPORATED AND SHOULD NOT BE USED WITHOUT WRITTEN PERMISSION								