

NOTES: UNLESS OTHERWISE SPECIFIED

- P/N: XB2ACOLOR
 HOUSING : MOLDED NYLON TYPE 6,6. AVAILABLE IN BLACK, RED, YELLOW.
 KNOB: MOLDED PLASTIC. AVAILABLE IN BLACK, RED, YELLOW.
 NEEDLES: SPRING TEMPER MUSIC WIRE. TIN PLATED.
 NEEDLE CLUSTER HOUSING: BRASS. TIN PLATED
 CLAMPING SCREW: STAINLESS STEEL.

- P/N: 9306COLOR
 HOUSING: MOLDED NYLON 6,6. AVAILABLE IN BLACK, RED, YELLOW.
 SOCKET & BANANA PLUG: BRASS. NICKEL PLATED.
 CONTACT: BeCu OR PHOSPHOR BRONZE. NICKEL PLATED.
 HARDWARE: BRASS EYELET. COPPER FINISH, TIN PLATED TERMINAL RING.

- P/N: W-600/COLOR
 18AWG 65X36 TINNED COPPER
 0.144 [3.66] O.D. PVC INSULATION
 AVAILABLE IN TEN COLORS.

- PERFORMANCE
 MAXIMUM CURRENT: 500 MILLIAMPS
 MAXIMUM VOLTAGE: <33 V AC < 70 V DC
 MAXIMUM TEMPERATURE: 221°F (105°C)

		REVISIONS	DATE	APPROVED
LTR				

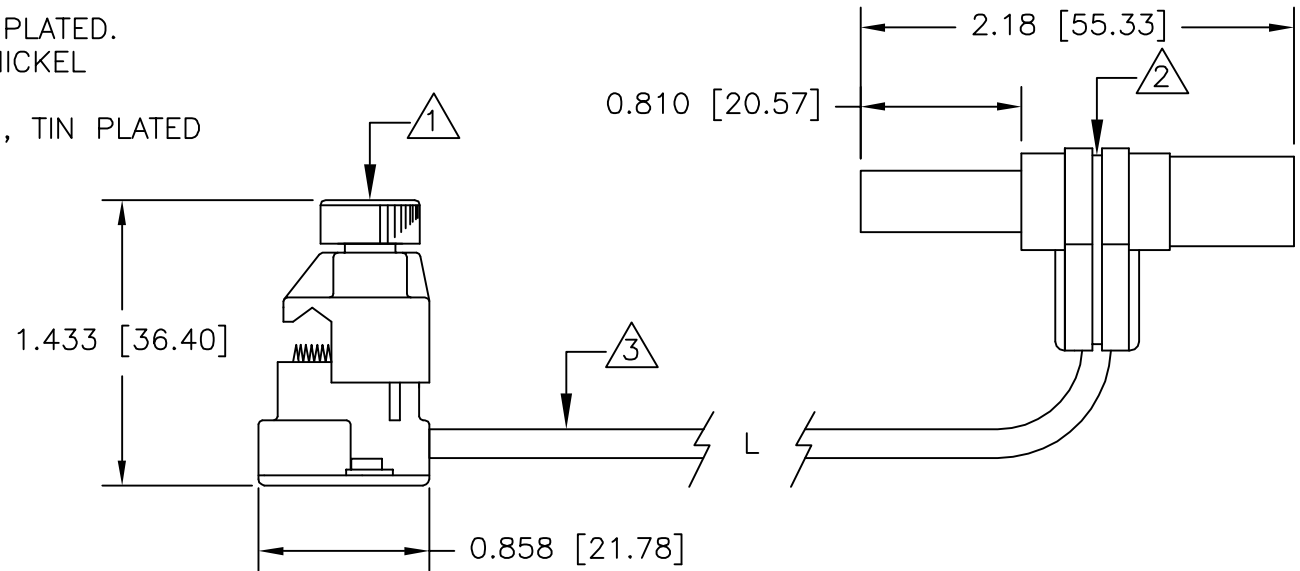

		UNLESS OTHERWISE SPECIFIED DIMENSIONS ARE IN INCHES TOLERANCES ARE: FRACTIONS DECIMALS ANGLES ± .XX ± ± .XXX ±	CONTRACT NO.		E-Z-HOOK DIVISION OF TEKTEST INC. ARCADIA, CA 91006 U.S.A.	
			APPROVALS	DATE		
		MATERIAL SEE NOTE.	DRAWN	R.L.	11/11	DESCRIPTION INSULATION PIERCING XB TO STK SHRD R/A STD BAN PLUG
			APPROVED BY			
		FINISH SEE NOTE.	SIZE	CODE IDENT NO.	DRAWING NO.	REV.
NEXT ASSY	USED ON		A	08505	636XB	
APPLICATION		DO NOT SCALE DRAWING	SCALE 1:1		SHEET 1 OF 1	

THE INFORMATION CONTAINED IN THIS DOCUMENT IS PROPRIETARY TO E-Z-HOOK. THE INFORMATION IS NOT TO BE REPRODUCED WITHOUT PRIOR WRITTEN PERMISSION OF E-Z-HOOK, DIV. OF TEKTEST INC. MAXIMUM TESTED RATINGS IN A HANDS-FREE CONTROLLED ENVIRONMENT. MAXIMUM RATINGS ARE NOT TO BE USED CONCURRENTLY.