

6

5

4

3

2

1

APPROVED: _____

DATE: _____ TITLE: _____

Rev	AWO #	Description	Date	Appr
-		RELEASED	01/17/07	
A		REVISED DIM.	5/19/09	
B		REVISED SPEC	9/8/11	

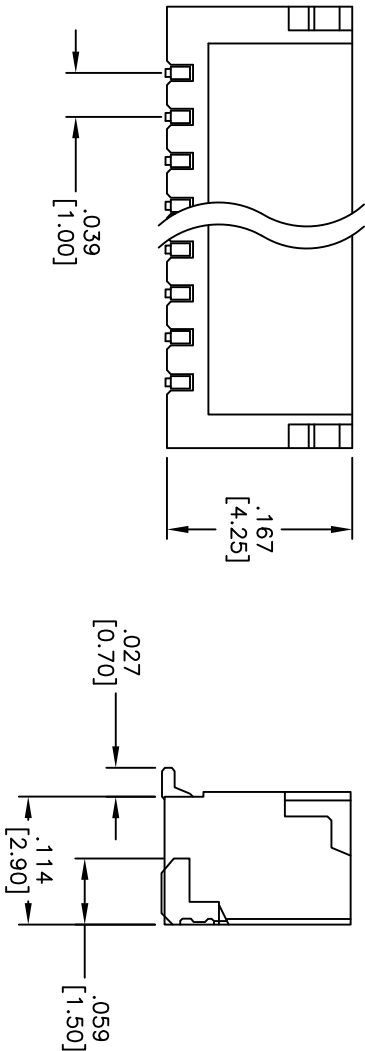

POLES	DIMENSIONS INCHES [mm]	
	A	B
2	.039 [1.00]	.157 [4.00]
3	.079 [2.00]	.197 [5.00]
4	.118 [3.00]	.236 [6.00]
5	.157 [4.00]	.276 [7.00]
6	.197 [5.00]	.315 [8.00]
7	.236 [6.00]	.354 [9.00]
8	.276 [7.00]	.394 [10.00]
9	.315 [8.00]	.433 [11.00]
10	.354 [9.00]	.472 [12.00]
11	.394 [10.00]	.512 [13.00]
12	.433 [11.00]	.551 [14.00]
13	.472 [12.00]	.591 [15.00]
14	.512 [13.00]	.630 [16.00]
15	.551 [14.00]	.669 [17.00]
20	.748 [19.00]	.866 [22.00]

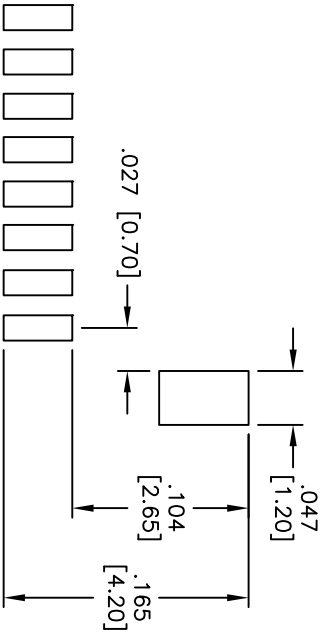
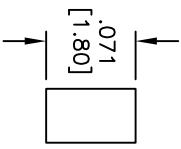
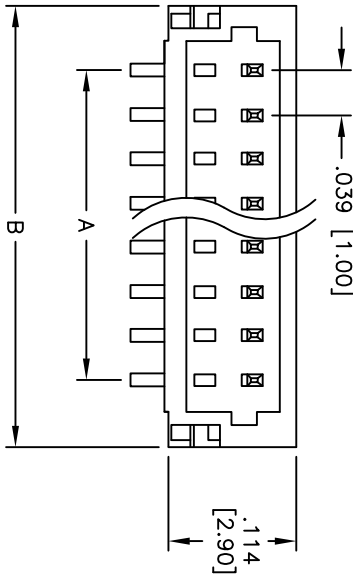

RECOMMENDED PCB LAYOUT

SPECIFICATIONS:

Material: Insulator: Hi-Temp Thermoplastic, rated UL 94V-0
 Insulator color: Natural
 Plating: Tin over Copper underplate overall
 Electrical: Operating voltage: 50 VAC max
 Current rating: 1 Amp max
 Insulation resistance: 100 Mohms min
 Dielectric withstanding voltage: 500 VAC for 1 minute
 Temperature Rating: Operating temperature: -25°C to +85°C
 Environmental: Lead free, RoHS compliant



ADAM TECH

909 Railway Avenue, Union, NJ 07083
 Phone: 908-687-5000 Fax: 908-687-5710

TITLE: 1.0mm WIRE TO BOARD WAFER SMT TOP ENTRY

UNLESS OTHERWISE SPECIFIED ALL DIMENSIONS ARE INCHES [MM] TOLERANCES: EXCEPT AS NOTED INCHES		HOLE SIZE	
.X	± .10	ØXX	± .10
.XX	± .020	ØXXX	± .015
.XXX	± .015	ØXXX	± .010
APPROVALS		DATE	
DRAWN	BW	01/17/07	
CHECKED			
APPROVED			
SIZE	PART NO.	SCALE	REV.
X	1SH-A-XX-TS-SMT	NIS	B
REF:	S0016T	SHEET	1 OF 1

6

5

4

3

2

1