

PRODUCT PARTNUMBER  
10148195-XXXXXXLF

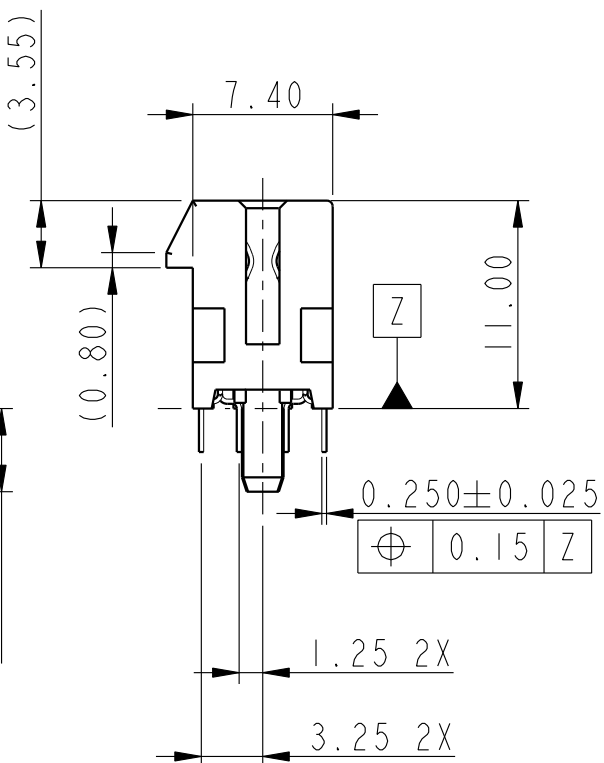
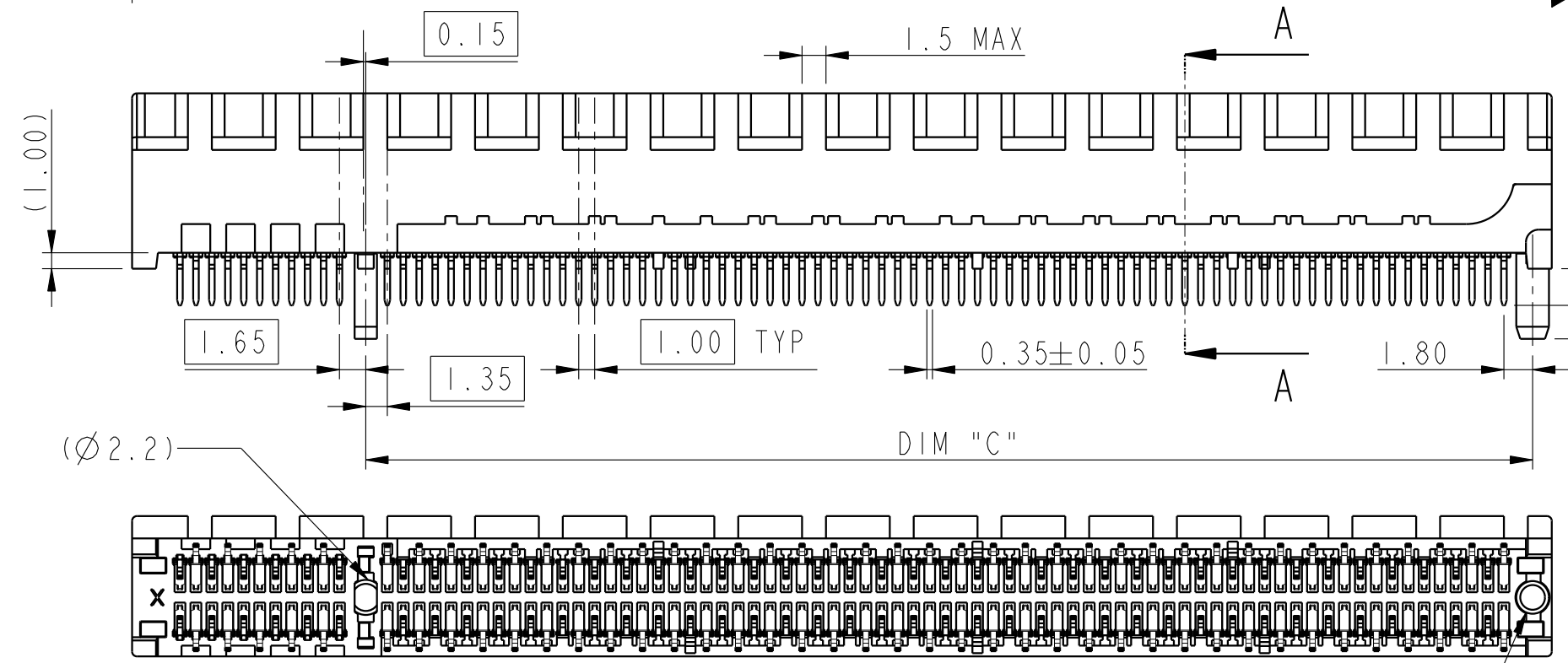
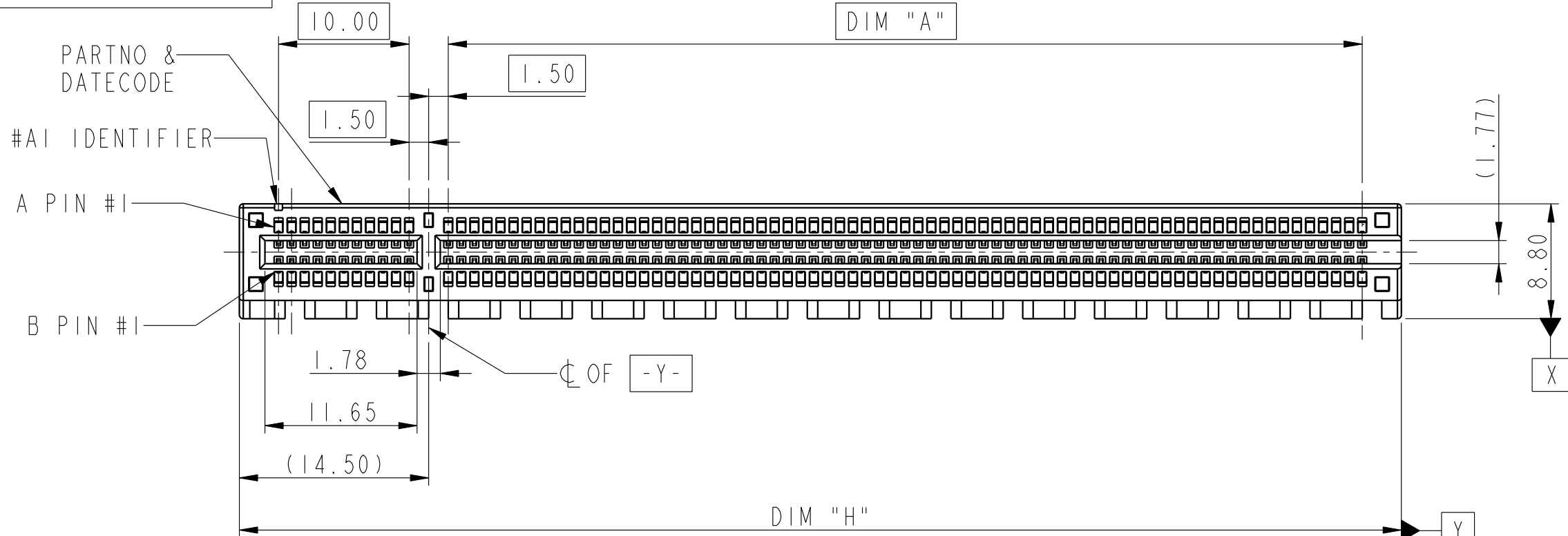

Amphenol  
FCi

© 2016 AFCI

spec ref	-	dr	Cheong, Matthe	2018/08/23	projection	mm	size	A3	scale	1:1	
tolerance std	ISO 406 ISO 1101	eng	Cheong, Matthe	2018/10/29			ecn no	-	rel level	Released	
surface	linear	chr	-	-			product family	-	rel level	Released	
		appr	Koon-Poh Tay	2018/10/29	<b>Amphenol FCI</b>		title	PCI EXPRESS 4.0		rev	A
	angular				cat. no.	-	TH Type Ass'y	dwg no	10148195	sheet 1 of 4	
									Product - Customer Drw		

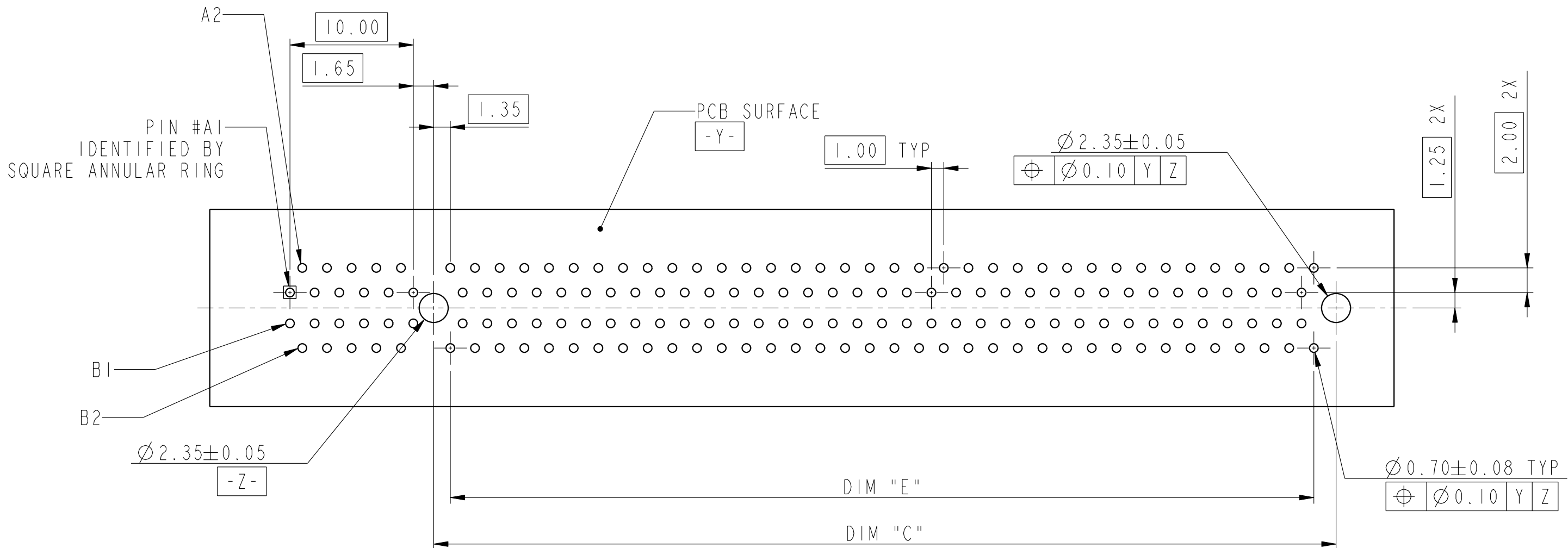

← I/O PANEL DIRECTION  
RECOMMENDED PCB LAYOUT

DIMENSIONS				
POSITION	A	C	E	H
36	6.00	9.15	6.00	25.00
64	20.00	23.15	20.00	39.00
98	37.00	40.15	37.00	56.00
164	70.00	73.15	70.00	89.00

spec ref	-	dr	Cheong, Matthe	2018/08/23	projection	mm	size	A3	scale	1:1		
tolerance std	ISO 406 ISO 1101	eng	Cheong, Matthe	2018/10/29			ecn no	-	rel level		Released	
TOLERANCES UNLESS OTHERWISE SPECIFIED		chr	-	-			product family	-	-			
surface	ISO 1302	appr	Koon-Poh Tay	2018/10/29	<b>Amphenol FCI</b>			PCI EXPRESS 4.0	dwg no	10148195	rev	A
	linear	0.X	±0.3		cat. no.			-	Product - Customer Drw		sheet 2 of 4	
		0.XX	±0.20		PDS: Rev :A				STATUS:Released		Printed: Nov 12, 2018	
		0.XXX	±0.1		Product - Customer Drw				STATUS:Released		Printed: Nov 12, 2018	
	angular	0°	±2°		Product - Customer Drw				STATUS:Released		Printed: Nov 12, 2018	

CONNECTOR LINK WIDTH	POSITION	N	DIM "G"	DIM "F"	PIN "L"
X1	36	6	8.15	6.00	B17
X4	64	20	22.15	20.00	B31
X8	98	37	39.15	37.00	B48
X16	164	70	72.15	70.00	B81

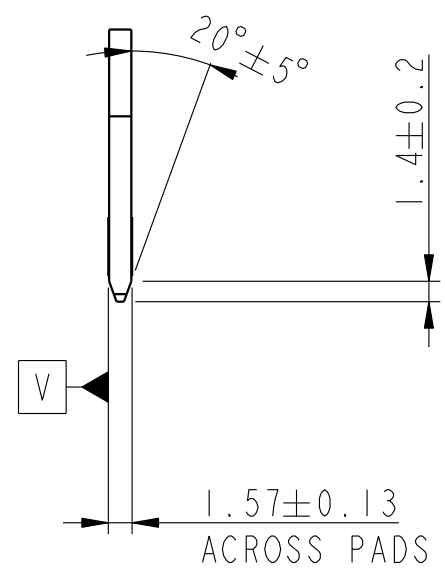
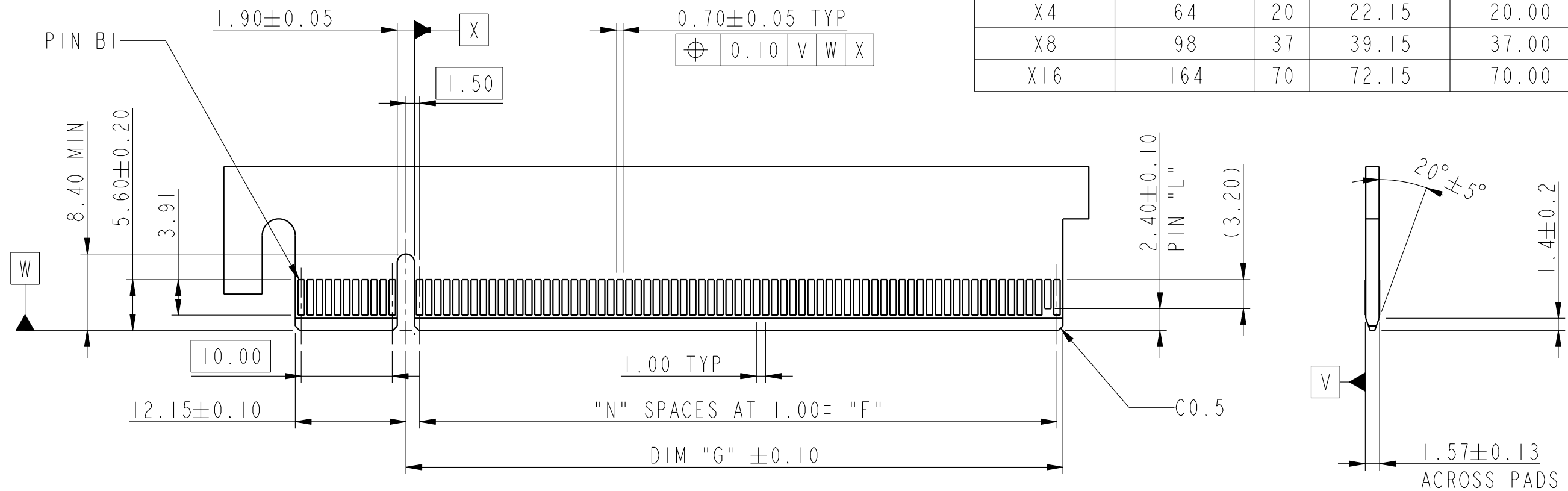

← I/O PANEL DIRECTION  
PRIMARY (COMPONENT) SIDE

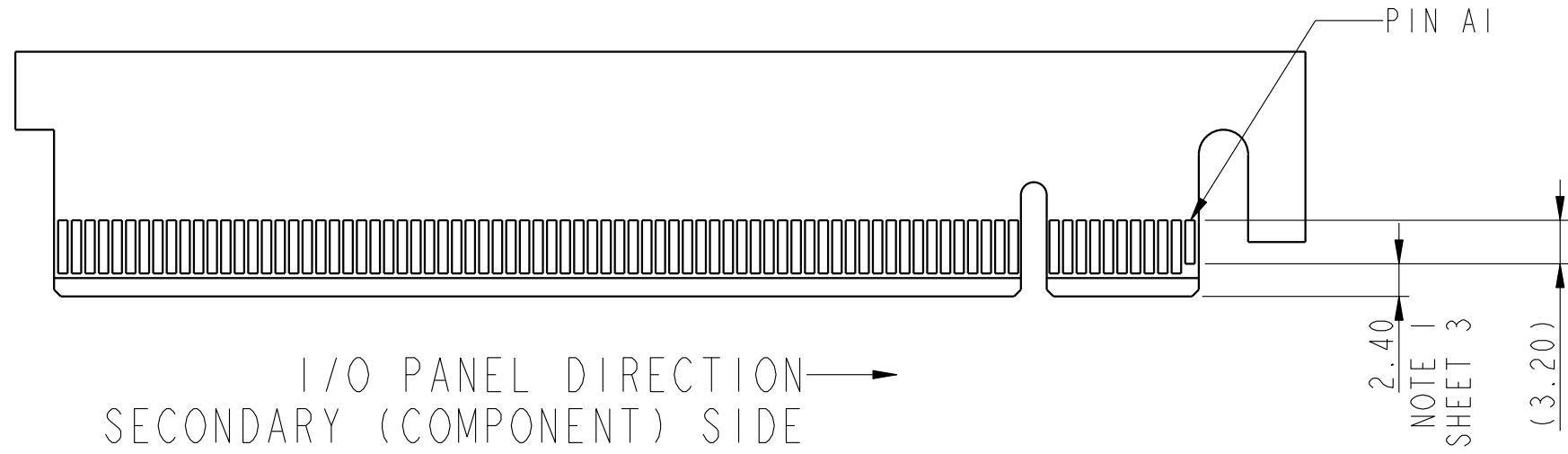

I/O PANEL DIRECTION →  
SECONDARY (COMPONENT) SIDE

- NO TIE BAR PERMITTED FROM CARD EDGE TO THE LEADING EDGE OF PAD AI AND PIN L
- CHAMFER EDGES MUST BE FREE OF CUTTING BURRS.
- TOLERANCE: ±0.13.

spec ref	-	dr	Cheong, Matthe	2018/08/23	projection	mm	size	A3	scale	1:1
tolerance std	ISO 406 ISO 1101	eng	Cheong, Matthe	2018/10/29			ecn no	-	rel level	Released
TOLERANCES UNLESS OTHERWISE SPECIFIED		chr	-	product family			-			
surface	linear	0.X	±0.3	<b>Amphenol FCI</b>	<b>PCI EXPRESS 4.0</b>		dwg no 10148195	rev A	Product - Customer Drw	
		0.XX	±0.20		TH Type Ass'y				sheet 3 of 4	
ISO 1302	angular	0°	±2°		cat. no.	-			STATUS:Released	

Amphenol FCI

© 2016 AFCI

PRODUCT NUMBER CODE

10148195-□□□□□□LF

HOUSING COLOUR OPTIONS

1: BLACK

PEGS OPTION

0: PLASTICS PEGS

CONTACT PLATING OPTIONS

0: 50u" Ni UNDERPLATE  
 30u" Au CONTACT AREA  
 100u" TIN TAIL AREA  
 1: 50u" Ni UNDERPLATE  
 15u" Au CONTACT AREA  
 100u" TIN TAIL AREA

PACKAGING

M: SOFT TRAY WITH KAPTON TAPE, 22MM

NO. OF POSITION

0: 36 POS  
 1: 64 POS  
 2: 98 POS  
 3: 164 POS

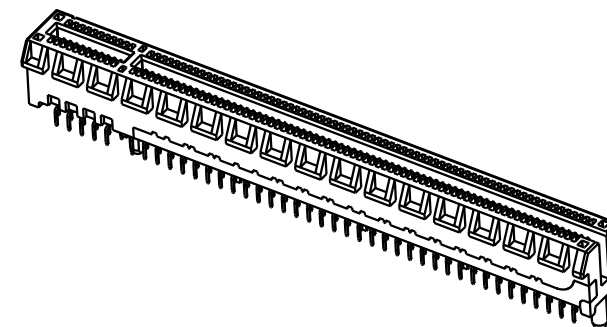

TAIL LENGTH OPTION

	DIM "D"	PCB THICKNESS
0	2.30	1.56
1	3.10	2.36
2	2.54	1.56
3	1.90	1.56

POSITION OF KAPTON TAPE

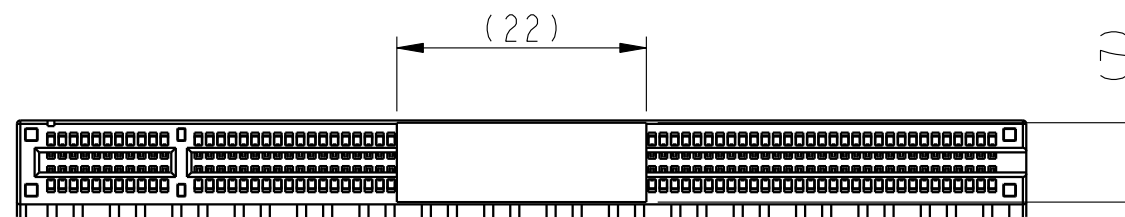

NOTES:

- MATERIAL:  
 HOUSING: HIGH PERFORMANCE RESIN, UL94V-0  
 CONTACT: COPPER ALLOY
- PLATING:  
 SEE TABLE
- PRODUCT SPECIFICATION: GS-12-1406
- PRODUCT MEETS EUROPEAN UNION DIRECTIVES  
 AND OTHER COUNTRIES REGULATIONS AS DESCRIBED IN GS-22-008
- DIMENSION APPLIES TO THE TIP OF TERMINAL.
- DATE CODE B PRINTED ON THIS SURFACE.  
 DATE CODE "MMDDYYL", MMDDYY IS ASSEMBLY DATE.  
 L IS AFCI PRODUCTION SITE.  
 - "M" DENOTES MALAYSIA
- THE HOUSING WITH WITHSTAND EXPOSURE TO 260°  
 PEAK TEMPERATURE FOR 10SECONDS IN A  
 CONVECTION, INFRA-RED OR VAPOR PHASE  
 REFLOW OVEN

spec ref	-	dr	Cheong, Matthe	2018/08/23	projection	mm	size	A3	scale	1:1	
tolerance std	ISO 406 ISO 1101	eng	Cheong, Matthe	2018/10/29			ecn no		-		
TOLERANCES UNLESS OTHERWISE SPECIFIED		chr	-	-			rel level		Released		
surface	linear	appr	Koon-Poh Tay	2018/10/29	product family	-	cat. no.		-		
	0.X ±0.3 0.XX ±0.20 0.XXX ±0.1	Amphenol FCI		PCI EXPRESS 4.0		dwg no		10148195		rev	A
ISO 1302	angular 0° ±2°			TH Type Ass'y		Product - Customer Drw		sheet 4 of 4			