

HS Series Hook Switches



Features/Benefits

- Connect headsets and phones
- Answer and hang up for telephone
- Various lever designs

Typical Applications

- Telecommunication
- Computer peripherals
- Medical devices

Specifications

CONTACT ARRANGEMENT: DPDT
 CONTACT RATING: 0.2 A @ 30 VDC
 INITIAL CONTACT RESISTANCE: 50 m Ω max.
 INSULATION RESISTANCE: 100M Ω min. @ 500 VDC
 DIELECTRIC STRENGTH: 500 V AC (50-60 Hz)
 OPERATING TEMPERATURE: -20°C to + 70°C
 OPERATING FORCE: 50 ± 20 gf

Materials

LEVER: POM (UL94 HB)
 COVER: POM (UL94 HB)
 TERMINAL: Silver plated

NOTE: Specifications and materials listed above are for switches with standard options. For information on specific and custom switches, consult Customer Service Center.

How To Order

Part number list is shown below. For individual part details, please refer to the following pages.

Part Number (Part Description)	Product Details
HS-2206-A1 NS	Hook Switches 24.2 *17.1
HS-2206-D NS	Hook Switches 35.9 * 17.2
HS-2206-E NS	Hook Switches 34* 17.2

PART NUMBER	LIFE CYCLE	PACKAGING
HS-2206-A1 NS	300,000 cycles	5,000 pieces

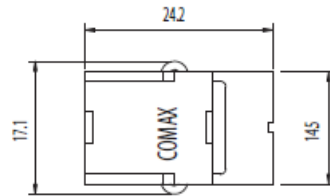

TRAVEL POSITION (X)			
①	③	ON	OFF
②	③	OFF	ON
④	⑥	ON	OFF
⑤	⑥	OFF	ON

6.85 Max 2.65 Min (m/m)

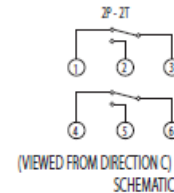
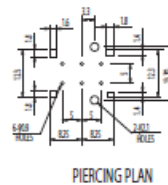
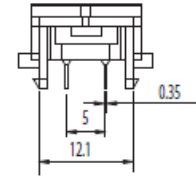
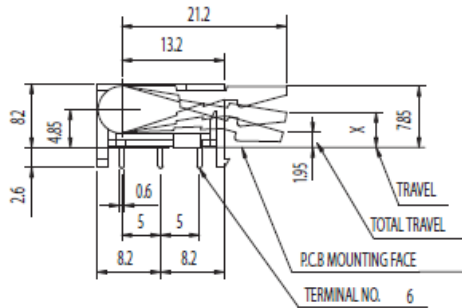

Detect m

HS Series Hook Switches

PART NUMBER	LIFE CYCLE	PACKAGING
HS-2206-D NS	100,000 cycles	5,000 pieces

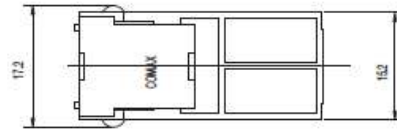

TRAVEL POSITION (Q)			
①	③	ON	OFF
②	④	OFF	ON
④	⑥	ON	OFF
⑤	⑥	OFF	ON

0 1.9Min. 5.2Max. (m/m)

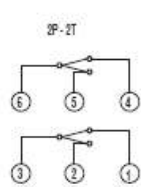
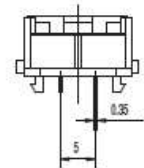
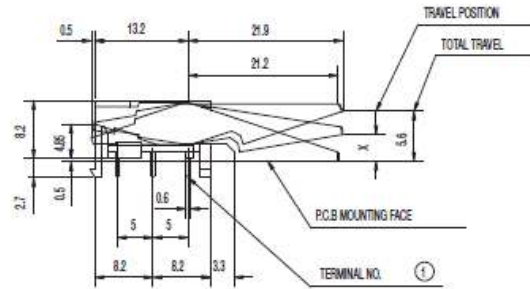

SCHEMATIC

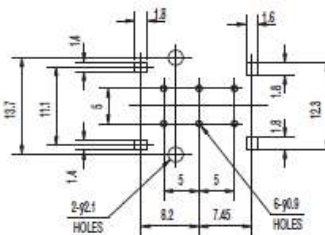

PIERCING PLAN

PART NUMBER	LIFE CYCLE	PACKAGING
HS-2206-E NS	100,000 cycles	5,000 pieces

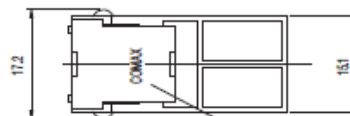

TRAVEL POSITION (Q)			
①	③	ON	OFF
②	④	OFF	ON
④	⑥	ON	OFF
⑤	⑥	OFF	ON

0 1.5Min. 5.9Max. (m/m)

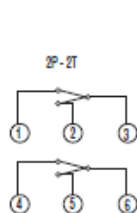
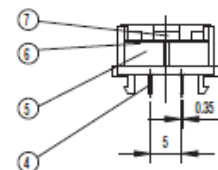
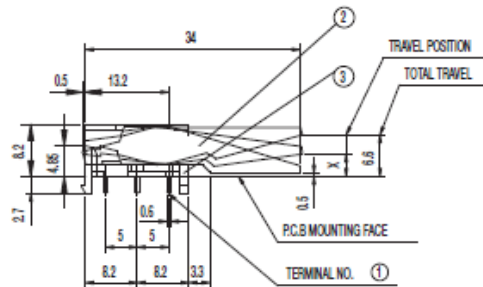

SCHEMATIC

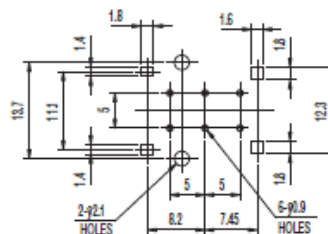

PIERCING PLAN

Dimensions are shown: mm
Specifications and dimensions subject to change



Detect