

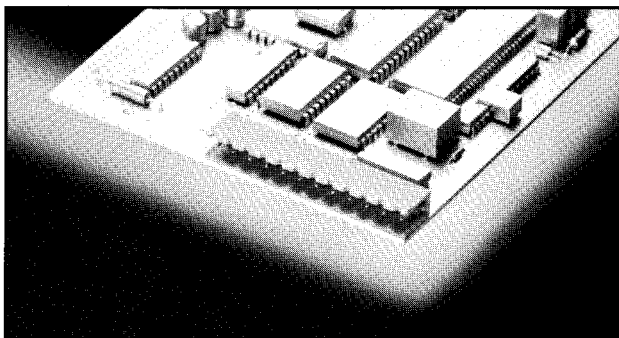



# EDSTLZ 950/OE



2-24 poles, Spacing 5.08 mm  
insert required no. of poles \*\*  
How to order see page 6

## Ratings:

	 UL1059	 CSA 22.2 No. 158	 DIN VDE 0627
<b>Rated Voltage</b>	250 VB	300 VB	250 V
<b>Rated Current</b>	15 A	16 A	12 A (T60)
<b>Test Voltage</b>			2.21 kV

## Dimensions

Spacing	5.08 mm
PCB Hole Diameter	1.4 mm

## Materials

Insulating Material	PA
Flammability Class	UL94 V-0
Temperature Range	-30°C/+105°C
Contact Pin	Cu
Color	Green

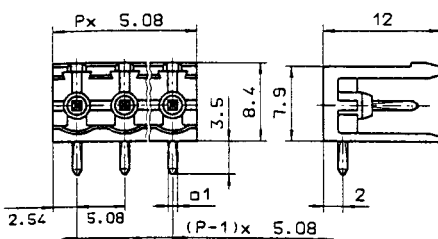

P = No. of Poles