

PRODUCT NUMBER
SEE TABLE

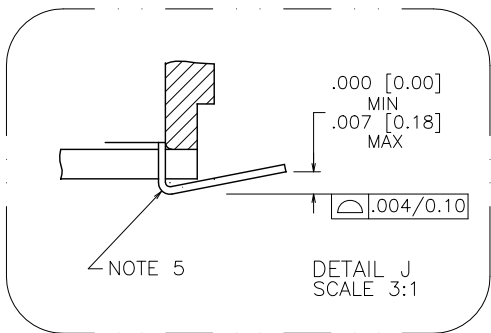

mat'l. code				surface		tolerance		projection		product family		
-				ISO 1302 ✓		ISO 406 ISO 1101				RIB CAGE		
ltr	ecn no	dr	date	tolerances unless otherwise specified						title		
T	M06-0284	ARA	7/27/06	angles	linear	xx ±.01/.3		INCH/MM		.050/1.27cc V.C.C. SURFACE		
U	M07-0053	MHT	1/22/07			xxx ±.005/.13				MOUNT w/POL. HOLD DOWN		
V	M07-0267	MHT	6/28/07	σ±2'			xxxx ±.0020/.050		scale 4:1			
W	M07-0345	AGS	7/26/07	dr	J. MUSTARD	3/25/91				dwg no		
X	M09-0058	CMR	4/06/09	engr	M. HAHN	3/25/91				sheet 1 of 3		size
Y	N10-0174	YO	6/17/10	chr	G. GINGRICH	3/25/91				87471		A3
AA	ELX-010203	YO	2/8/12	appd	M. HAHN	3/25/91				Product Customer Drawing		
sheet	revision	AA	AA	AA								
index	sheet	1	2	3								

PRODUCT NO. NOTE 8	SIZE	DIM A	DIM B	DIM C	DIM D	SPECIAL PACKAGING	TAPE WIDTH
87471-605	2 X 5	.266/6.76	.200/5.08	.370/9.40	.3200/8.128	NOTE 7	24mm
-610	2 X 10	.516/13.11	.450/11.43	.620/15.75	.5700/14.478		
-615	2 X 15	.766/19.46	.700/17.78	.870/22.10	.8200/20.828		
-620	2 X 20	1.016/25.81	.950/24.13	1.120/28.45	1.0700/27.178	NOTE 7	44mm
-625	2 X 25	1.266/32.16	1.200/30.48	1.370/34.80	1.3200/33.528		
-630	2 X 30	1.516/38.51	1.450/36.83	1.620/41.15	1.5700/39.878		
-635	2 X 35	1.766/44.86	1.700/43.18	1.870/47.50	1.8200/46.228		
-640	2 X 40	2.016/51.21	1.950/49.53	2.120/53.85	2.0700/52.578		
-645	2 X 45	2.266/57.56	2.200/55.88	2.370/60.20	2.3200/58.928		
87471-650	2 X 50	2.516/63.91	2.450/62.23	2.620/66.55	2.5700/65.278	NOTE 7	88mm
87471-905	2 X 5	.266/6.76	.200/5.08	.370/9.40	.3200/8.128		
-910	2 X 10	.516/13.11	.450/11.43	.620/15.75	.5700/14.478		
-915	2 X 15	.766/19.46	.700/17.78	.870/22.10	.8200/20.828		
-920	2 X 20	1.016/25.81	.950/24.13	1.120/28.45	1.0700/27.178		
-925	2 X 25	1.266/32.16	1.200/30.48	1.370/34.80	1.3200/33.528		
-930	2 X 30	1.516/38.51	1.450/36.83	1.620/41.15	1.5700/39.878		
-935	2 X 35	1.766/44.86	1.700/43.18	1.870/47.50	1.8200/46.228		
-940	2 X 40	2.016/51.21	1.950/49.53	2.120/53.85	2.0700/52.578		
-945	2 X 45	2.266/57.56	2.200/55.88	2.370/60.20	2.3200/58.928		
87471-950	2 X 50	2.516/63.91	2.450/62.23	2.620/66.55	2.5700/65.278		

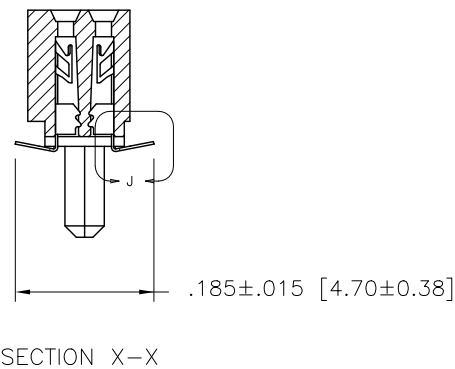
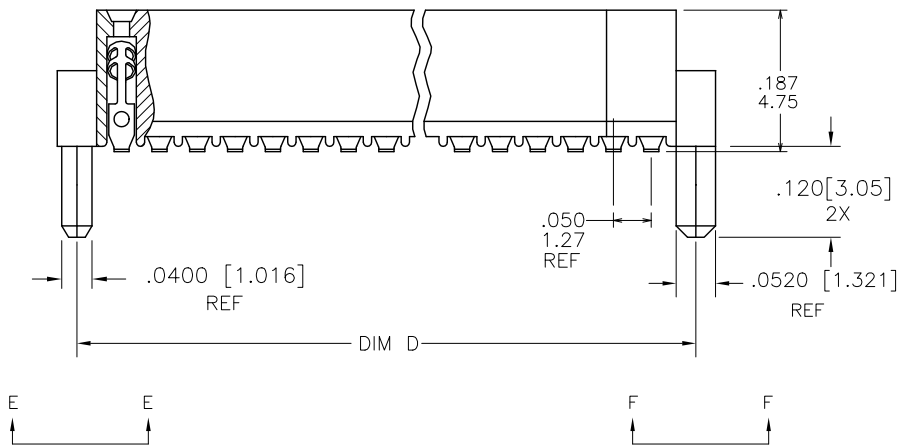
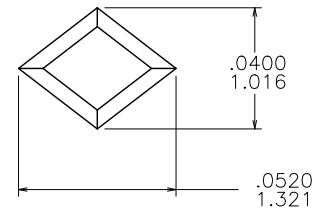
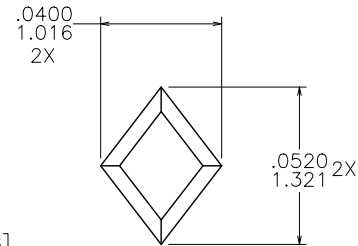
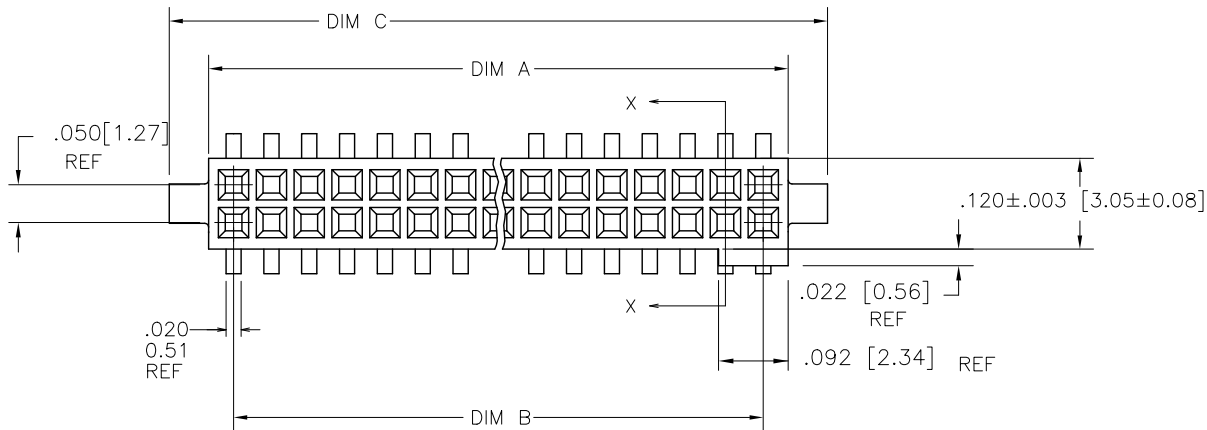
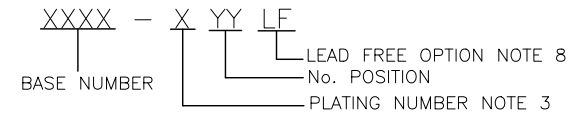

NOTES :

- HOUSING MATERIAL :
GLASS FILLED THERMOPLASTIC FLAME RETARDANT
PER UL 94-0 COLOR : NATURAL
- TERMINAL MATERIAL : BeCu
- TERMINAL PLATING :
-6XXLF 30u"/.76um MIN HARD GOLD OR GXT OVER Ni ON CONTACT ZONES. 100u"/2.54um MIN Sn OVER Ni IN SOLDERING ZONES. OTHERWISE GOLD FLASH OR UNPLATED
-9XXLF 60u"/1.52um MIN HARD GOLD OVER Ni ON CONTACT ZONES. 100u"/2.54um MIN Sn OVER Ni IN SOLDERING ZONES. OTHERWISE GOLD FLASH OR UNPLATED
- APPLICATION INFORMATION :
 - RECOMMENDED MOUNTING PAD PATTERN IS SHOWN IN FIGURE "A".
 - MATING PINS TO BE .0176/0.447 TO .0181/0.459 THICK.
 - MATING PIN TIPS TO BE IN TRUE POSITION TO MATING GRID WITHIN .008/0.20 DIA.
 - SUGGESTED MATING PIN LENGTH .130/3.30 ±.010/0.25.
- LEAD TIPS TO BE ABOVE HEEL, UP TO .007/0.18 MAX. COPLANARITY TO BE MEASURED AT LOWEST POINT (HEEL).
- ADD "CT" TO END OF DASH NUMBER FOR CONNECTOR WITH VACUUM CAP IN TUBE.
- ADD "TR" TO END OF DASH NUMBER FOR TAPE AND REEL PACKAGED WITH CAP. TOOLED ONLY FOR NOTED
- ADD "LF" SUFFIX AT THE END OF PART NUMBER FOR LEAD FREE OPTION.
- THIS PRODUCT MEETS EUROPEAN UNION DIRECTIVES AND OTHER COUNTRY REGULATION AS DESCRIBED IN GS-22-008.
- THE HOUSING WILL WITHSTAND EXPOSURE TO 260°C PEAK TEMPERATURE FOR 20 SECONDS IN A CONVECTION INFRA-RED OR VAPOR PHASE REFLOW OVEN. SEE APPLICATION NOTES/PROCEDURES IF THEY ARE AVAILABLE.
- PRODUCT SPECIFICATION PER BUS-12-087.

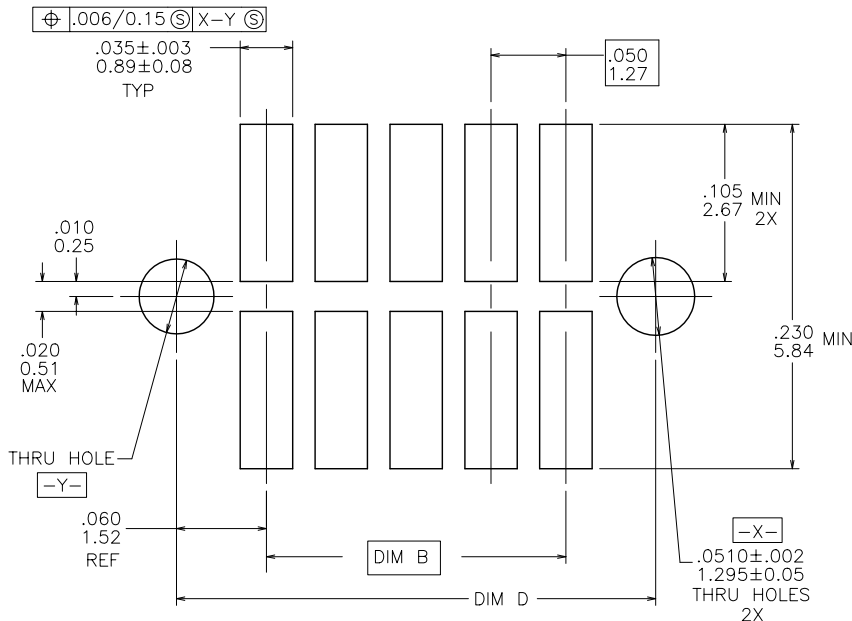

FIGURE A
RECOMMENDED
P.C.B. LAYOUT

mat'l. code		surface		tolerance		projection		product family	
-		ISO 1302 ✓		ISO 406 ISO 1101				RIB CAGE	
ltr	ecn	no	dr	date	tolerances unless otherwise specified		title		
AA					angles	linear	INCH/MM scale 8:1		
					σ±2'	xxx ±.005/.13 xxxx ±.0020/.050	.050/1.27cc V.C.C. SURFACE MOUNT w/POL. HOLD DOWN		
			dr	J. MUSTARD	3/25/91		dwg no		
			enr	M. HAHN	3/25/91		sheet 2 of 3 size		
			chr	G. GINGRICH	3/25/91		87471 A3		
			appd	M. HAHN	3/25/91		type Product Customer Drawing		
sheet	revision								
index	sheet								

