

REVISIONS			
REV	DESCRIPTION	DATE	APPROVED
A	INITIAL RELEASE	03/07/11	D.N.

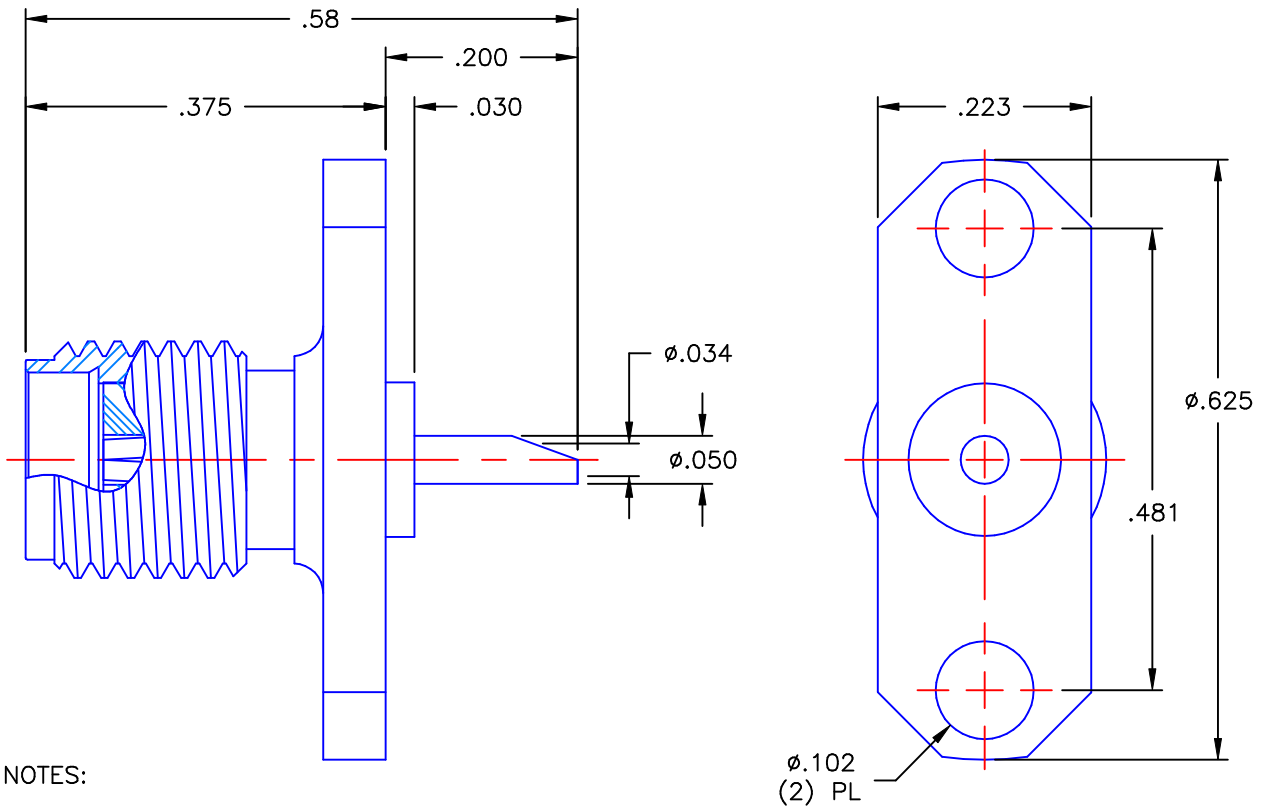

NOTES:

MATERIALS:

1. BODY = STAINLESS STEEL PER ASTM A582, ALLOY 303, CONDITION "A".
2. INSULATOR = VIRGIN WHITE TEFLON PER ASTM D1710, GRADE 1, TYPE I, CLASS "B".
3. CONTACT = BERYLLIUM COPPER PER ASTM B196, ALLOY C17300, TEMPER TD04.

FINISHES:

1. BODY = PASSIVATE PER QQ-P-35, TYPE VI.
2. CONTACT = GOLD PLATE PER MIL-G-45204, TYPE II, CLASS 1, GRADE C, OVER .00010 TO .00020 STRESS FREE SULFAMATE NICKEL PER QQ-N-290.

UNLESS OTHERWISE SPECIFIED DIMENSIONS ARE IN INCHES TOLERANCES ON	DWN:	DATE	
	D.N.	03/07/11	
	CHKD:	DATE	
DECIMAL	ANGLE	M.J.	03/07/11
		APVD:	DATE
		J.M.	03/07/11



Property of Radiall
This document cannot be reproduced or
communicated to a third party without prior
written permission of RADIALL.

SMA STRAIGHT PANEL JACK
2 HOLE FLANGE MOUNT
SOLDER POT CONTACT

REFERENCE:	MATERIALS & FINISHES:	SIZE	FSCM NO.	DWG NO.	REV
ORIGINATOR: D.N. DATE: 03/07/11	SEE NOTES	A	19505	9408-9113-000	A
		SCALE 5:1	THIRD ANGLE PROJECTION		SHEET 1 OF 1

9408-9113-000