

THIS DRAWING IS UNPUBLISHED. RELEASED FOR PUBLICATION, 19  
 © COPYRIGHT 19 BY AMP INCORPORATED. ALL INTERNATIONAL RIGHTS RESERVED.

|     |      |   |   |           |     |                      |         |       |
|-----|------|---|---|-----------|-----|----------------------|---------|-------|
| LOC | DIST | P | F | REVISIONS |     |                      |         |       |
| G   | 14   |   |   | ZONE      | LTR | DESCRIPTION          | DATE    | APPD  |
|     |      |   |   |           | B   | REV PER OG3A-0013-01 | 20FEB01 | SR TM |

|                                |                                |                                |
|--------------------------------|--------------------------------|--------------------------------|
| <b>AMP</b><br>WIRE RANGE       | <b>UL</b> Listed               | <b>SR</b> LR7189<br>Certified  |
| 22-16 AWG<br>SOLID OR STRANDED | 22-16 AWG<br>SOLID OR STRANDED | 22-16 AWG<br>SOLID OR STRANDED |

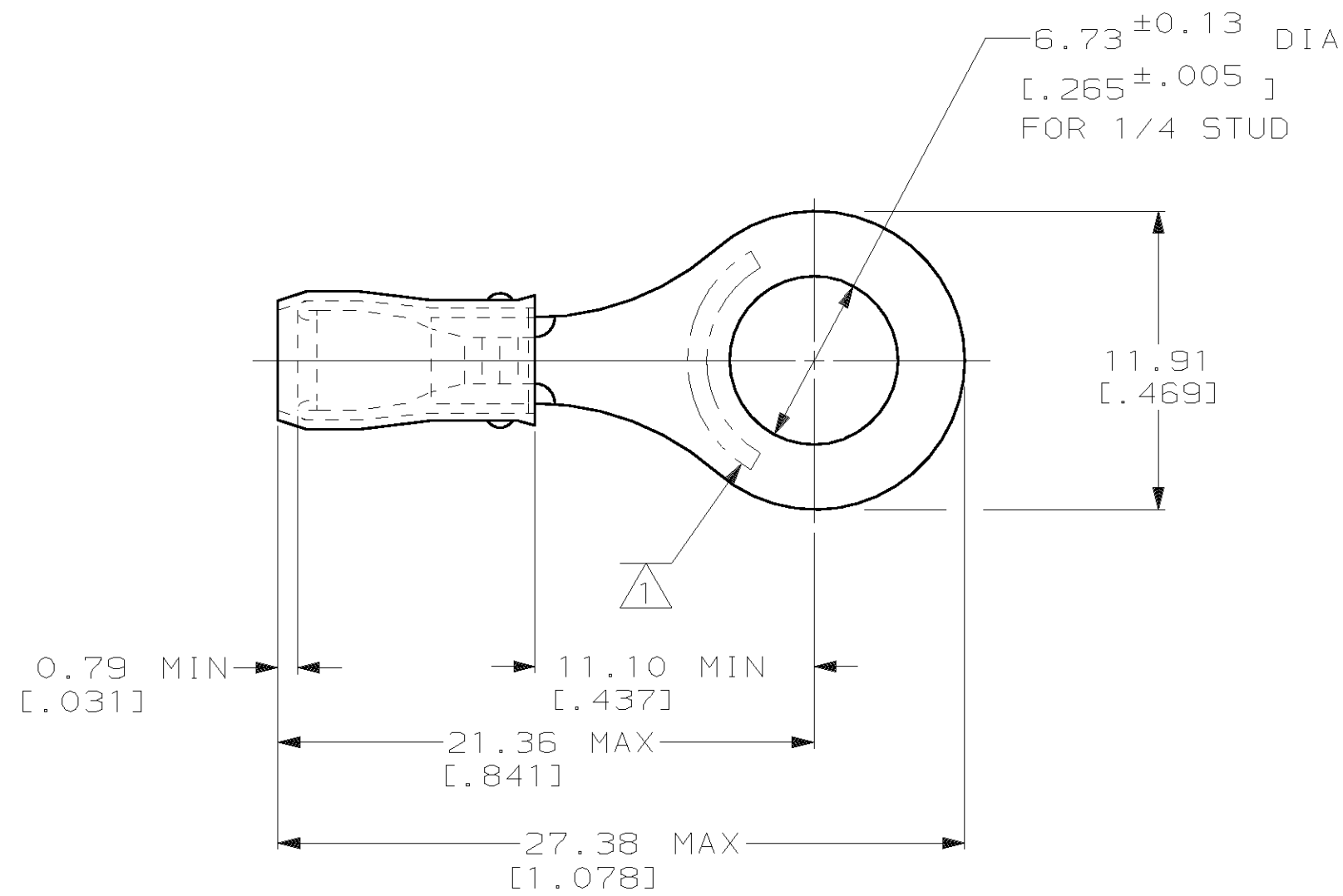

- 1 STAMP AMP 22-18\* APPROX AS SHOWN  
22-16 TERMINALS ARE STAMPED 22-18 IN  
ACCORDANCE WITH MILITARY SPEC MIL-T-7928  
COMMERCIAL WIRE RANGE IS 22-16
- 2 WIRE INSULATION DIA: .080 - .125
- 3 TONGUE MATERIAL THK: 0.79 ± 0.05 [.031 ± 0.002]

|   |  |   |  |   |  |            |  |  |  |
|---|--|---|--|---|--|------------|--|--|--|
| <b>AMP INCORPORATED</b><br><b>CUSTOMER SERVICE SYSTEMS</b>  |  | MAX RECOMMENDED OPERATING TEMPERATURE:<br>105°C MAX                             |  | 5000                                      |  | ON TAPE    |  | 55936-2  |  |
| FOR ADDITIONAL PRODUCT INFORMATION OR COPIES OF DRAWINGS AND TECHNICAL DOCUMENTS  |  | PRODUCT INFORMATION CENTER<br>1-800-522-6752                                    |  | MILITARY P/N AND CLASS                    |  | QUANTITY   |  | PACKAGE TYPE                                       |  |
| FOR APPLICATION TOOLING INFORMATION   |  | TOOLING ASSISTANCE CENTER<br>1-800-722-1111                                     |  | COPPER PER ASTM B-152 SLEEVE, BLACK NYLON |  | -          |  | LOOSE PIECE  |  |
| FOR ORDER ENTRY   |  | 1-800-526-5142  |  | FINISH<br>TIN PLATE PER MIL-T-10727       |  | -          |  | 55936-1  |  |
| THIS DRAWING IS A CONTROLLED DOCUMENT FOR AMP INCORPORATED. IT IS SUBJECT TO CHANGE AND THE CONTROLLING ENGINEERING ORGANIZATION SHOULD BE CONTACTED FOR THE LATEST REVISION. |  | CIRCULAR MIL AREA:<br>0.26-1.65mm <sup>2</sup> [509-3,260]<br>SOLID OR STRANDED |  | DR 03/25/93<br>DK SCHRUM                  |  | AMP        |  | AMP Incorporated<br>Harrisburg, PA 17105-3608      |  |
|   |  |   |  | CHK 03/29/93<br>SH BORTNER                |  | NAME       |  | TERMINAL, RING TONGUE, PIDG™, WIRE SIZE: 22-16 AWG |  |
|   |  |   |  | APPD 03/29/93<br>ML ELLIS                 |  | SIZE       |  | B  |  |
|   |  |   |  | APPD 03/29/93<br>M BARNABA                |  | CAGE CODE  |  | 00779  |  |
|   |  |   |  | PRODUCT SPEC<br>UL 486A                   |  | DRAWING NO |  | C-55936  |  |
|   |  |   |  | APPLICATION SPEC<br>NOT AVAILABLE         |  | SCALE      |  | 4:1  |  |
|   |  |   |  | WEIGHT -                                  |  | SHEET      |  | 1 OF 1   |  |