

.250-36 UNS-2A

OSM JACK

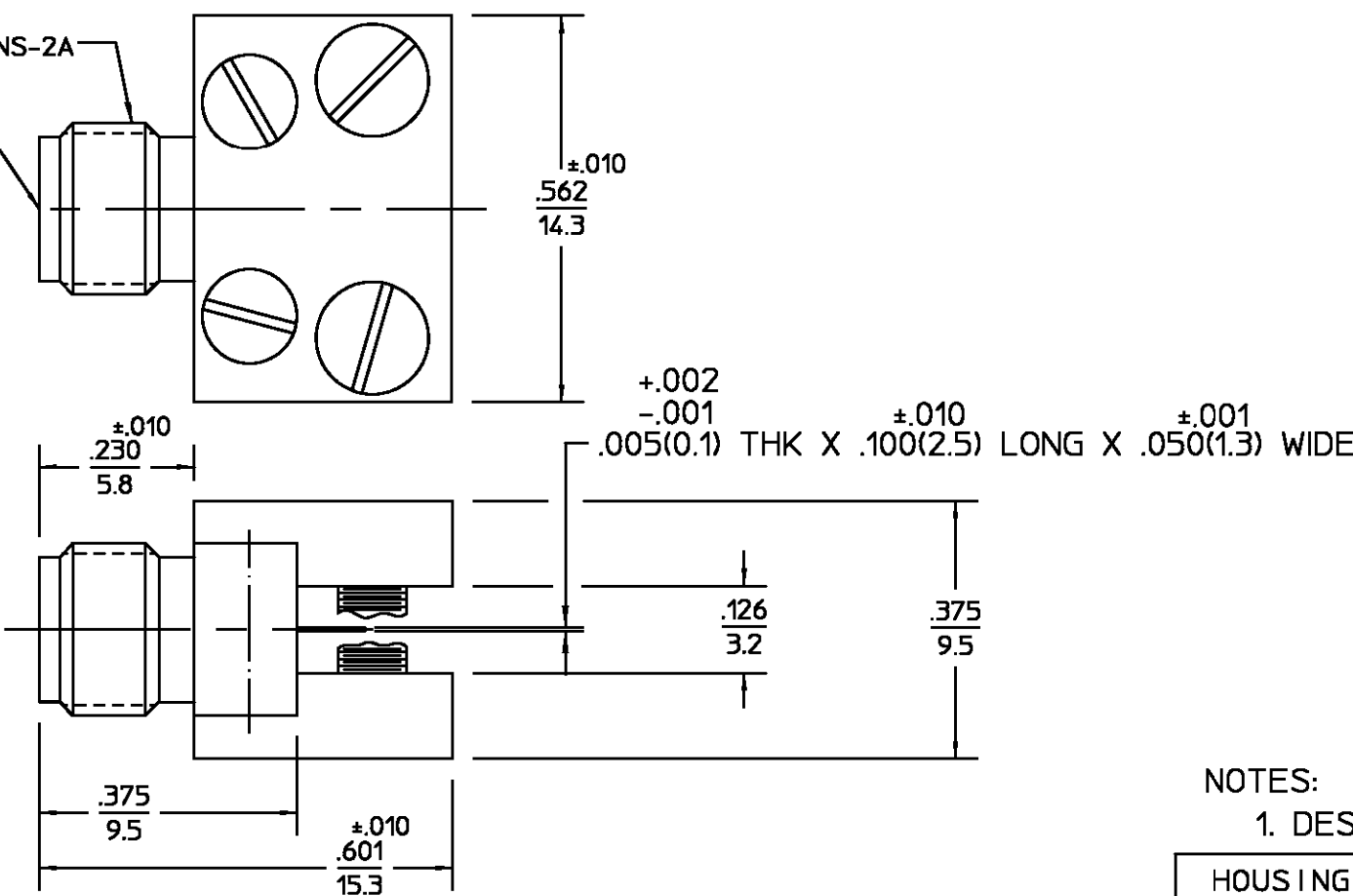

REVISIONS			
REV	DESCRIPTION	DATE	APPROVED
A1	REVISED PER ECO-11-005030	21MAR11	HMR

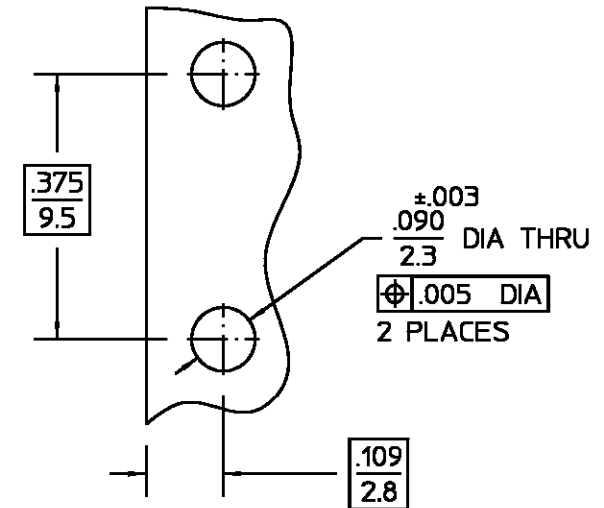

MOUNTING HOLE PATTERN

NOTES:

- 1. DESIGNED FOR USE WITH 1/8 THICK STRIPLINE

.XXX = in
XX.X = mm

ELECTRICAL	MECHANICAL	ENVIRONMENTAL
Nominal Impedance (Ohms) <u>50</u>	Interface Dimensions MIL-STD-348A, Fig. <u>310.2</u>	Temperature Rating <u>-65°C to +105°C</u>
Frequency Range (GHz) DC to <u>18</u>	Recommended Mating Torque <u>N/A</u>	Vibration MIL-STD-202, Method 204, Condition D.
Volt Rating (VRMS MAX) @ Sea Level <u>335</u>	Mating Characteristics: Insertion (MAX lbs) <u>3.0</u>	Shock MIL-STD-202, Method 213, Condition I.
VSWR <u>1.05 + .005 f(GHz)</u>	Withdrawal (MIN oz) <u>1.0</u>	Thermal Shock MIL-STD-202, Method 107, Condition A.
Insertion Loss (dB MAX) <u>.03 √f(GHz)</u>	Force to Engage and Disengage (in-lbs MAX) <u>2.0</u>	Moisture Resistance MIL-STD-202, Method 106
RF Leakage (dB MIN) <u>N/A</u>	Center Contact Captivation Axial (lbs) <u>6.0</u> MIN	Corrosion - MIL-STD-202, Method 101, Condition B, 5% salt spray
Corona, 70,000 Ft (VRMS MIN) <u>250</u>	Radial (in-oz) <u>4.0</u> MIN	
Dielectric Withstanding Voltage (VRMS MIN) @ Sea Level <u>1,000</u>		
Contact Resistance (Milliohms MAX) Center Contact <u>2.0</u>		
Outer Contact <u>2.0</u>		
Cable to Housing <u>N/A</u>		
RF High Potential @ Sea Level (VRMS MIN @ 5 MHz) <u>670</u>		
LR.(Megohms MIN) <u>5000</u>		

COMPONENT	MATERIAL	FINISH
HOUSING BASE PLATES	STAINLESS STEEL PER ASTM-A484 AND ASTM-A582, TYPE 303	PASSIVATE PER ASTM-A380
DIELECTRIC	TFE FLUOROCARBON PER ASTM-D-1457	N/A
CENTER CONTACT	BERYLLIUM COPPER PER ASTM B 196, ALLOY C17300, CONDITION H	GOLD PLATE PER MIL-G-45204
MACHINE SCREWS	CORROSION RESISTANT STEEL PER QQ-S-763	PASSIVATE PER ASTM-A380

UNLESS OTHERWISE SPECIFIED DIMENSIONS ARE IN MILLIMETERS	DRAWN BY <i>M.A.</i> DATE <u>7/29/94</u>	
TOLERANCE ON	CHECKED BY	
FRAC. DEC. ANGLES	APPD BY	
$\pm 1/64$ $\pm .25$ $\pm 1^\circ$	USE ASS'Y PROCEDURE	TITLE <u>OSM STRAIGHT END LAUNCH JACK</u>
	NO. AP. <u>N/A</u>	SIZE <u>B</u> CODE IDENT NO. <u>26805</u> 1053465-1 REV <u>A1</u>
	CUSTOMER DRAWING	SCALE <u>4 : 1</u> SHEET 1 OF 1