

Mechanical Dimensions: Inches [mm]

Tolerances  $\pm 0.012$  [0.3] Unless Otherwise Specified

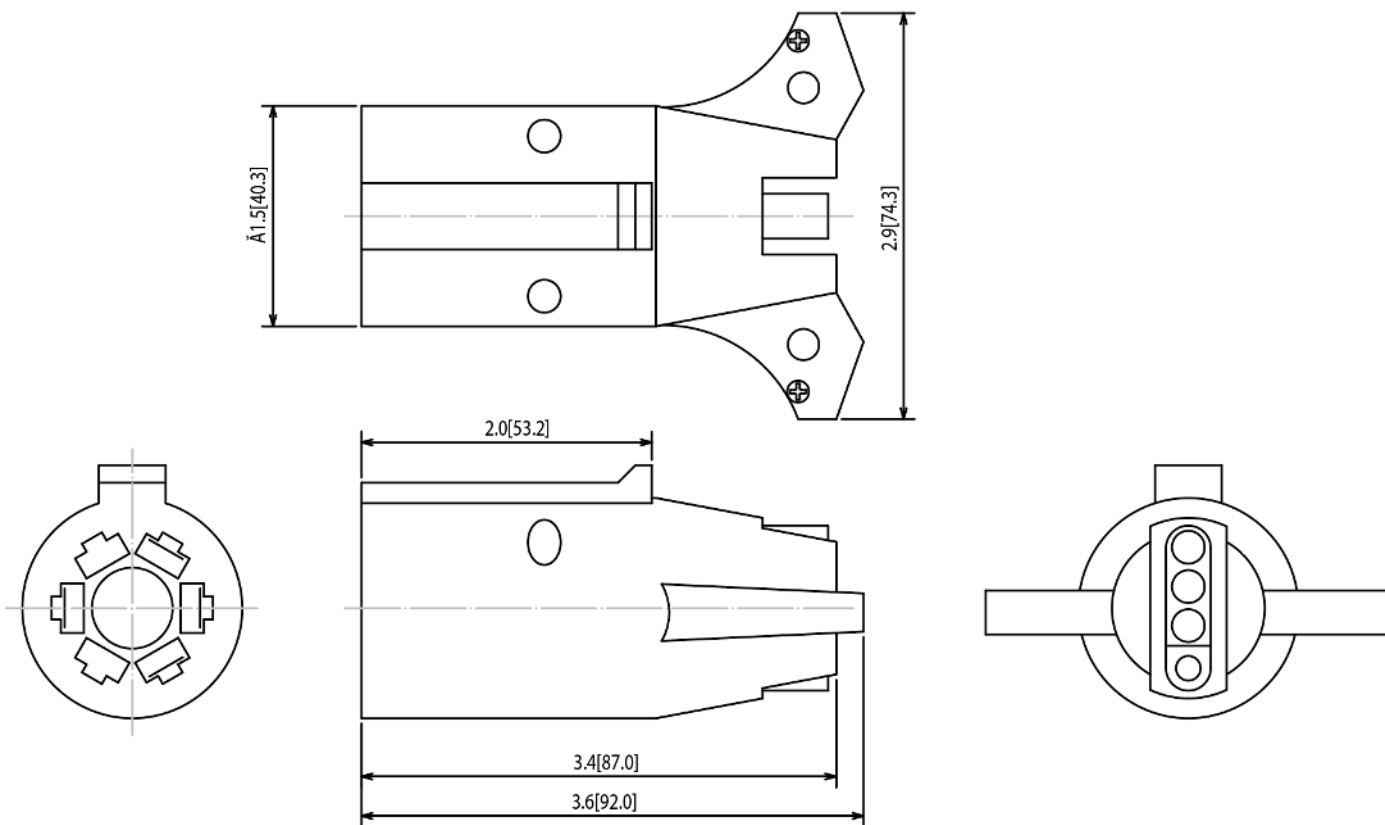

TOLERANCES:  
1mm~5mm:±0.1  
6mm~20mm:±0.2  
21mm~50mm:±0.3  
51mm~100mm:±0.5  
ANGLES:±1°

Rev	Date of issue	Revision Notes	Designed	Approved
A	07-16-2019	Initial Drawing	RC	OH