

# In-Line On/Off Rocker Switch

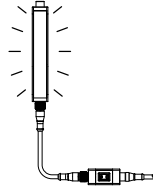

## Datasheet

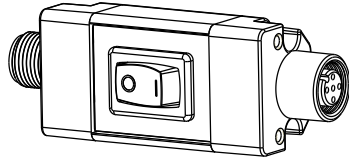

- In-line switch with M12 connectors
- Rugged metal housing
- Perfect for dc-powered task lights
- Rated for up to 30 V dc

(WLS28PBQ shown)

Models	Description	Used With
WLS28PBQ	2 position In-line switch	2-wire dc LED lights
WLS28-2PBQ	3 position In-line switch	WLS28-2 and WLS28-2 Dual Color

WLS28-2PBQ models can be used with the WLS28-2 family for controlling the two levels of intensity or on the WLS28-2 Dual Color family for Color 1 or Color 2 selection.



**Important:** Lea el siguiente instructivo antes de operar el luminario. Por favor descargue desde [www.bannerengineering.com](http://www.bannerengineering.com) toda la documentación técnica de los In-Line On/Off Rocker Switch, disponibles en múltiples idiomas, para detalles del uso adecuado, aplicaciones, advertencias, y las instrucciones de instalación de estos dispositivos.



**Important:** Lisez les instructions suivantes avant d'utiliser le luminaire. Veuillez télécharger la documentation technique complète des In-Line On/Off Rocker Switch sur notre site [www.bannerengineering.com](http://www.bannerengineering.com) pour les détails sur leur utilisation correcte, les applications, les notes de sécurité et les instructions de montage.

## Specifications

### Supply Voltage

30V dc max  
See electrical characteristics on product label

### Current Rating

4 Amps max

### Electrical Life

> 10,000 make and break cycles at full load

### Construction

Clear anodized aluminum housing; painted zinc end caps; Nylon switch; zinc plated steel brackets

### Mounting

(2) swivel brackets SMBWLS28RA included and (4) screws

### Environmental Rating

IEC IP50

### Certifications



## Dimensions

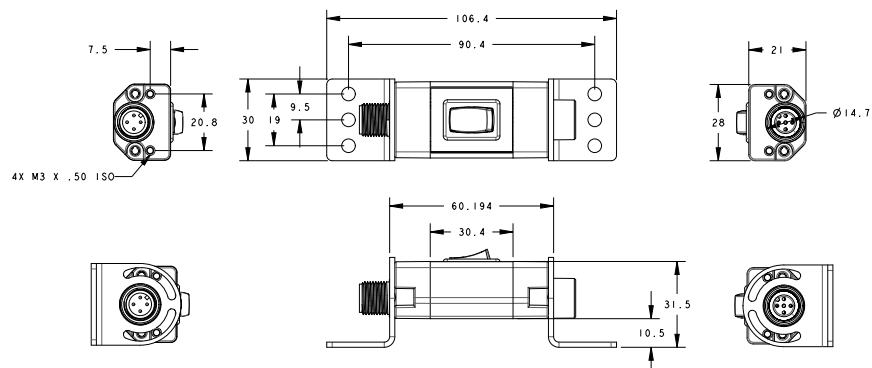

## Wiring Diagrams

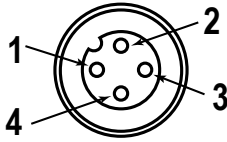

Figure 1. 4-pin M12/Euro-style Female

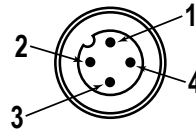

Figure 2. 4-pin M12/Euro-style Male

		WLS28-2PBQ Wiring Diagram		WLS28PBQ Wiring Diagram	
Pin	Wire Color	Input (Male)	Output (Female)	Input (Male)	Output (Female)
1	Brown	V+ dc (30 V max)	V+ dc Position II	V+ dc (30 V max)	V+ dc Position I
3	Blue	dc common	dc common	dc common	dc common
4	Black	Not used	V+ dc Position I	Not used	Not used
2	White	Not used	Not used	Not used	Not used

## Accessories

### Cordsets

4-Pin Threaded M12/Euro-Style Cordsets—Single Ended					
Model	Length	Style	Dimensions	Pinout (Female)	
MQDC-406	1.83 m (6 ft)	Straight			1 = Brown 2 = White 3 = Blue 4 = Black
MQDC-415	4.57 m (15 ft)				
MQDC-430	9.14 m (30 ft)				
MQDC-450	15.2 m (50 ft)				
MQDC-406RA	1.83 m (6 ft)	Right-Angle			1 = Brown 2 = White 3 = Blue 4 = Black
MQDC-415RA	4.57 m (15 ft)				
MQDC-430RA	9.14 m (30 ft)				
MQDC-450RA	15.2 m (50 ft)				

4-Pin Threaded M12/Euro-Style Cordsets—Double Ended				
Model	Length	Style	Dimensions	Pinout
MQDEC-401SS	0.31 m (1 ft)	Male Straight/ Female Straight		Female
MQDEC-403SS	0.91 m (3 ft)			
MQDEC-406SS	1.83 m (6 ft)			Male
MQDEC-412SS	3.66 m (12 ft)			
MQDEC-420SS	6.10 m (20 ft)			
MQDEC-430SS	9.14 m (30 ft)			
MQDEC-450SS	15.2 m (50 ft)			
				1 = Brown 2 = White 3 = Blue 4 = Black

## Brackets

### SMBWLS28RA

The bracket kit is available as a replacement for the one that comes with the light or switch. The kit contains two end brackets and four screws.

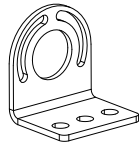

### SMBWLS28SM

This kit allows the light or switch to be mounted at a right angle to the mounting surface. The kit contains two end brackets and four screws.

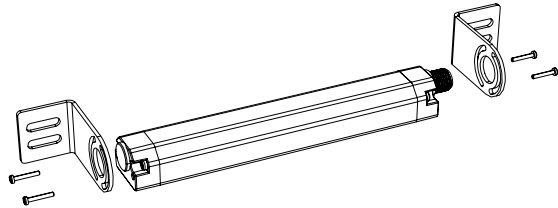

### SMBWLS28SP

- Stainless steel snap bracket kit
- Includes two brackets

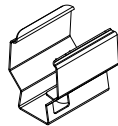

### SMH1316

This kit allows the light or switch to be mounted to a 13/16-inch Unistrut channel. Light is shown. The kit includes:

- #10-32 spring nuts (qty 2)
- #10-32 socket head cap screws (qty 2)
- #10 lock washers (qty 2)

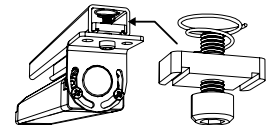

### SMBWLSMAG

Magnetic mounting bracket for easy attachment to steel surfaces

### SMBWLSMAGR

Protective cover also available to prevent scratches to painted surfaces

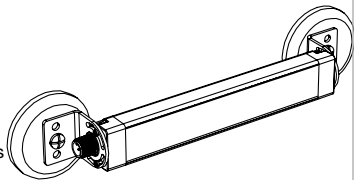

## Banner Engineering Corp Limited Warranty

Banner Engineering Corp. warrants its products to be free from defects in material and workmanship for one year following the date of shipment. Banner Engineering Corp. will repair or replace, free of charge, any product of its manufacture which, at the time it is returned to the factory, is found to have been defective during the warranty period. This warranty does not cover damage or liability for misuse, abuse, or the improper application or installation of the Banner product.

**THIS LIMITED WARRANTY IS EXCLUSIVE AND IN LIEU OF ALL OTHER WARRANTIES WHETHER EXPRESS OR IMPLIED (INCLUDING, WITHOUT LIMITATION, ANY WARRANTY OF MERCHANTABILITY OR FITNESS FOR A PARTICULAR PURPOSE), AND WHETHER ARISING UNDER COURSE OF PERFORMANCE, COURSE OF DEALING OR TRADE USAGE.**

This Warranty is exclusive and limited to repair or, at the discretion of Banner Engineering Corp., replacement. **IN NO EVENT SHALL BANNER ENGINEERING CORP. BE LIABLE TO BUYER OR ANY OTHER PERSON OR ENTITY FOR ANY EXTRA COSTS, EXPENSES, LOSSES, LOSS OF PROFITS, OR ANY INCIDENTAL, CONSEQUENTIAL OR SPECIAL DAMAGES RESULTING FROM ANY PRODUCT DEFECT OR FROM THE USE OR INABILITY TO USE THE PRODUCT, WHETHER ARISING IN CONTRACT OR WARRANTY, STATUTE, TORT, STRICT LIABILITY, NEGLIGENCE, OR OTHERWISE.**

Banner Engineering Corp. reserves the right to change, modify or improve the design of the product without assuming any obligations or liabilities relating to any product previously manufactured by Banner Engineering Corp. Any misuse, abuse, or improper application or installation of this product or use of the product for personal protection applications when the product is identified as not intended for such purposes will void the product warranty. Any modifications to this product without prior express approval by Banner Engineering Corp will void the product warranties. All specifications published in this document are subject to change; Banner reserves the right to modify product specifications or update documentation at any time. Specifications and product information in English supersede that which is provided in any other language. For the most recent version of any documentation, refer to: [www.bannerengineering.com](http://www.bannerengineering.com).

For patent information, see [www.bannerengineering.com/patents](http://www.bannerengineering.com/patents).

## Mexican Importer

Banner Engineering de México, S. de R.L. de C.V.  
David Alfaro Siqueiros 103 Piso 2 Valle oriente  
San Pedro Garza Garcia Nuevo León, C. P. 66269  
81 8363.2714