

SIZE	DIM H	DIM J	DIM K	DIM L
2X5	.275/6.99	.200/5.08	.372/9.45	.320/8.13
2X10	.525/13.34	.450/11.43	.622/15.80	.570/14.48
2X15	.775/19.68	.700/17.78	.872/22.15	.820/20.83
2X20	1.025/26.03	.950/24.13	1.122/28.50	1.070/27.18
2X25	1.275/32.38	1.200/30.48	1.372/34.85	1.320/33.53
2X30	1.525/38.74	1.450/36.83	1.622/41.20	1.570/39.88
2X35	1.775/45.08	1.700/43.18	1.872/47.55	1.820/46.23
2X40	2.025/51.43	1.950/49.53	2.122/53.90	2.070/52.58
2X45	2.275/57.78	2.200/55.88	2.372/60.25	2.320/58.93
2X50	2.525/64.14	2.450/62.23	2.622/66.60	2.570/65.28

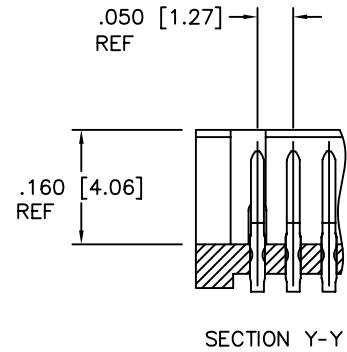

mat'l. code		surface		tolerance	projection	product family		
-		ISO 1302 ✓		ISO 406	INCH/MM	RIBCAGE		
		tolerances unless otherwise specified		ISO 1101				
ltr	ecn	no	dr	date	linear	title		
B						RIBCAGE III SMT VERT. HEADER ASS'Y		
					angles	scale 3:1	dwg no	
					.XX±.01/0.3			sheet 2 of 3
					±2°			size
					dr	GM SUN	2013-01-15	
					enr	GM SUN	2013-01-15	
					chr	RICK BIAN	2013-01-15	
					app	RICK BIAN	2013-01-15	
sheet index	revision sheet							

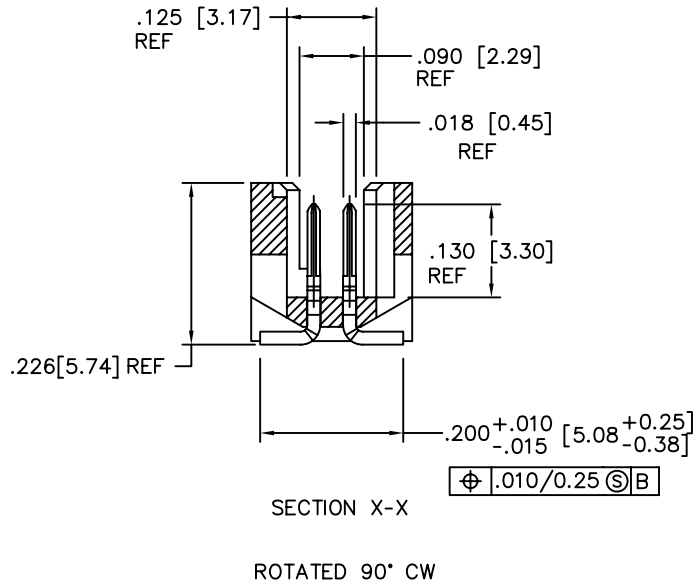

Copyright FCJ

D

NOTES:

1. 10124055-01-1XXLF
 ├── LEAD FREE OPTION (NOTE 11& 13)
 └── NUMBER OF POSITIONS (NOTE 2)
2. NUMBER OF POSITIONS = 05 THRU 50 IN 5 POS INCREMENTS.
 (EXAMPLE : 105=10 POS., 110=20 POS. ETC.)
3. REQUIRED ON -X40,-X45 & -X50 POSITION PARTS ONLY.
4. 10124055-01-1XXLF PACKAGING IN TUBES
 10124055-01-1XXTLF PACKAGING IN TAPE AND REEL
5. HOUSING MATERIAL :
 GLASS FILLED THERMOPLASTIC FLAME RETARDANT PER UL 94V-0.
 COLOR : NATURAL
6. TERMINAL PLATING :
 30u" GOLD OVER 50u" NI ON CONTACT ZONES.
 GOLD FLASH OVER 50u" Ni ON OTHERWISE ALL ZONES.
7. MOLDING FLOW RESTRICTOR QUANTITY AND LOCATION IS
 MANUFACTURING OPTION.
8. VACUUM CAP SLOT REQUIRED ON ALL SIZES, SLOT MAY
 BE LOCATED ON OPPOSITE SIDE FOR 2 X 5.
9. NOT AVAILABLE IN TAPE AND REEL.
10. ADD LF SUFFIX AT THE END OF PART NUMBER FOR LEAD FREE OPTION.
11. THE HOUSING WILL WITHSTAND EXPOSURE TO 260°C PEAK TEMPERATURE
 FOR 20 SECONDS IN A CONVECTION, INFRA-RED OR VAPOR PHASE REFLOW
 OVEN. SEE APPLICATION NOTE/PROCEDURES IF THEY ARE AVAILABLE.
12. THIS PRODUCT MEETS EUROPEAN UNION DIRECTIVES AND OTHER
 COUNTRY REGULATION AS DESCRIBED IN GS-22-008.
13. PRODUCT SPECIFICATION SEE BUS-12-087.

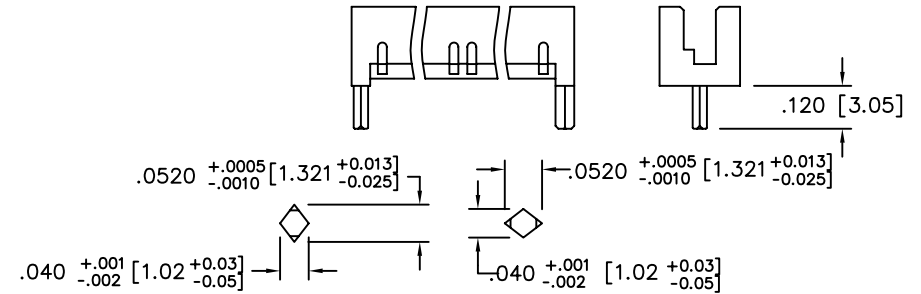

LOCATOR/HOLDDOWN VARIATIONS

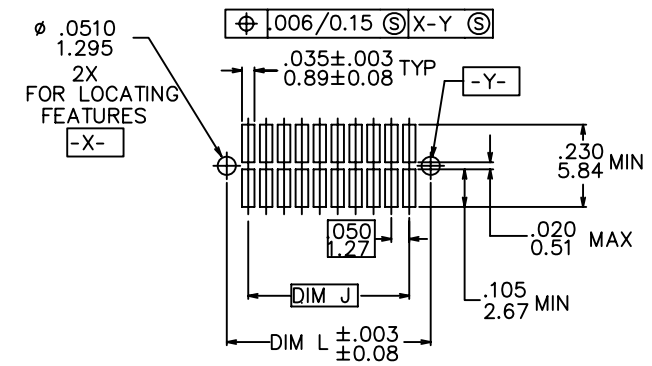

RECOMMENDED PCB MOUNTING PAD PATTERN



FCIconnect.com

Copyright FCI

mat'l. code		surface		tolerance		projection		product family	
-		ISO 1302 <input checked="" type="checkbox"/>		ISO 406 <input checked="" type="checkbox"/>				RIBCAGE	
tr		ecn		no		dr		date	
B									
angles		linear		.XX \pm .01/0.3		INCH/MM		title	
				.XXX \pm .005/0.13		scale 3:1		RIBCAGE III SMT	
				.XXXX \pm .0020/0.05				VERT. HEADER ASS'Y	
dr		GM SUN		2013-01-15		FCI		dwg no	
enr		GM SUN		2013-01-15				sheet 3 of 3	
chr		RICK BIAN		2013-01-15				size	
appd		RICK BIAN		2013-01-15				10124055	
sheet		revision						type	
index		sheet						Product Customer Drawing	