

- NOTES :
- MATERIAL :
TERMINAL : BRASS C2600EH, T=0.4mm
 - FINISH : TIN PLATING
 - APPLICATION :
WIRE SIZE : AWG #20~#14
 - OBsolete PARTS

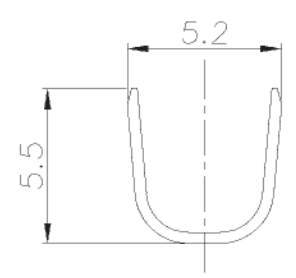

SEC. A-A

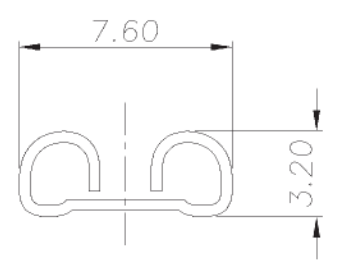
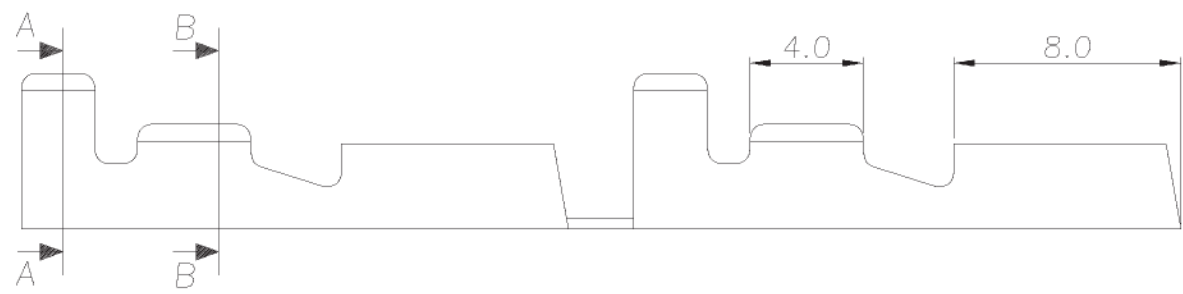
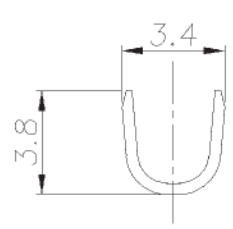

SEC. B-B

	1470322-2
	1470322-1
PLATING THICKNESS	PART NUMBER

DIMENSION : 0 PLC ±0.5 1 PLC ±0.3 2 PLC ±0.2 3 PLC ± ANGLES ±3'	DWN S. HOU 26-APR-2002	TE Connectivity NAME RECEPTACLE, FASTIN-FASTON, .250 SERIES
	CHK J. CHENG 26-APR-2002	
MATERIAL SEE NOTE	APVD J. WU 26-APR-2002	PRODUCT SPEC
FINISH SEE NOTE	APPLICATION SPEC	WEIGHT
LTR REVISION RECORD ECN A REVISED PER ECR-19-018072 0 NEW RELEASED FZ00-0097-02 SS TD 27NOV 2019 SH JC 26APR 2002 DWN CHK DATE		LOC DW A3 SIZE 3 DRAWING NO C-1470322 SCALE -- SHEET 1 OF 2

NUMBER C-1470322



METRIC

THIS INFORMATION IS CONFIDENTIAL AND IS DISCLOSED TO YOU ON CONDITION THAT YOU WILL NOT REPRODUCE, COPY, OR TRANSMIT IT TO ANY OTHER PERSONNEL WITHOUT WRITTEN PERMISSION FROM STMicroelectronics. DIMENSIONS IN MILLIMETERS. DO NOT SCALE PRINT.

PRINT DIST DW

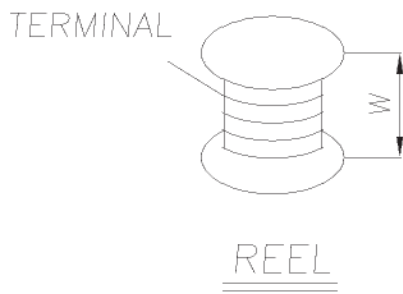
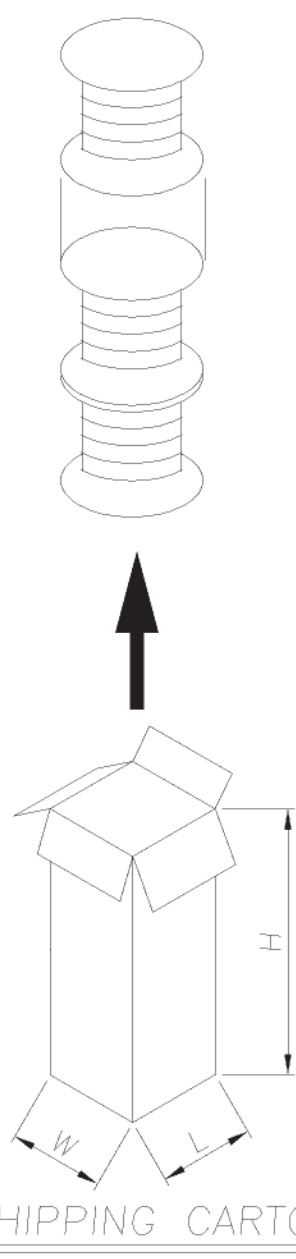

NOTE :
 1. DIMENSION :
 REEL : $\phi 260$, W=150
 SHIPPING CARTON:
 L=275, W=275, H=480
 2. QUANTITY :
 5,000 PCS/FEEL
 3 REEL/SHIPPING CARTON

SHIPPING CARTON

SEE SHEET 1			
LTR	REVISION RECORD	ECH	DWN/CHK DATE

DIMENSION : 0 PLC ± 1 PLC ± 2 PLC ± 3 PLC ± ANGLES ±		DWN S. HOU 26-APR-2002 CHK J. CHENG 26-APR-2002	TE Connectivity	
MATERIAL SEE NOTE		APVD J. WU 26-APR-2002	NAME RECEPTACLE, FASTIN-FASTON, .250 SERIES	
FINISH SEE NOTE		PRODUCT SPEC APPLICATION SPEC WEIGHT	LOC DW SCALE --	SIZE A ₃ DRAWING NO C-1470322 SHEET 2 OF 2

CUSTOMER DRAWING

8 | 7 | 6 | 5 | 4 | 3 | 2 | 1