

PRODUCT N°	NB OF TERMINAL	DIM"C"	DIM"D"	CONTACTS PLACED IN CAVITY (ACCORDING TO VIEW "A")
87627-Y01(H)LF	2	12.70	15.08	X
87627-Y02(H)LF	5	15.24	17.70	X X X X X
87627-Y03(H)LF	4	15.24	17.70	X X X X
87627-Y04(H)LF	8	40.64	43.10	X X X X X X X X
87627-Y05(H)LF	5	15.24	17.70	X X X X X
87627-Y06(H)LF	5	15.24	17.70	X X X X X
87627-Y07(H)LF	3	10.16	12.62	X X X
87627-Y08(H)LF	7	35.56	43.10	X X X X X X X
87627-Y09(H)LF	4	15.24	17.70	X X X X

ROHS COMPATIBLE, SEE NOTE 6

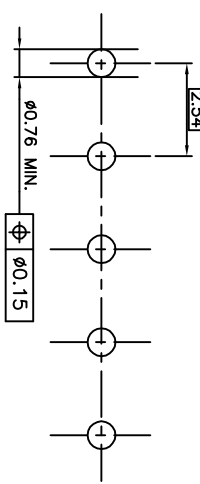

NOTES:

- 1 - MATERIAL HOUSING: THERMOPLASTIQUE POLYESTER 30% GLASS FILLED, COLOUR BLUE. FLAME RETARDANT PER UL-94V0.
  - 2 - MATERIAL TERMINAL: PHOSPHOR BRONZE EXTRA HARD.
  - 3 - RECOMMENDED APPLICATION DATA: SEE TA 804.
  - 4 - SUFFIX LETTER "H" AT THE END OF THE P/N INDICATES A HIGH TEMPERATURE HOUSING, MATERIAL: PCT 30% GLASS FILLED COLOR GREY. FLAME RETARDANT PER UL-94V0.
  - 5 - PRODUCT PACKAGED IN TUBE.
  - 6 - R&HS COMPATIBLE. PRODUCT SPECIFICATIONS
  - 7 - END STAND-OFFS FOR 1x2 UP TO 1x5 POS  
NO END STAND-OFFS FOR 1x6 UP TO 1x50 POS
  - 8 - END STAND-OFFS FOR 1x2 UP TO 1x5 POS  
NO END STAND-OFFS FOR 1x6 UP TO 1x50 POS
- d - PLATING:**
- "LF" MEANS THE PRODUCT IS LEAD-FREE, 2µm MINIMUM MATTE TIN OVER 1.27µm MINIMUM NICKEL UNDERPLATE.
  - b - MANUFACTURING PROCESS COMPATIBILITY**
  - THE HOUSING WILL WITHSTAND EXPOSURE TO 260°C ±5°C SOLDER BATH TEMPERATURE FOR 5 SECONDS IN A WAVE SOLDER APPLICATION WITH A 1.6mm MIN THICK CIRCUIT BOARD.
  - c - LABELING:**
  - MEETS PACKAGING SPECS AS PER GS-14-920
  - d - LEGAL STATEMENT:** SEE GS-47-0004

87627-4XXLF	5µm Sn	Sn
87627-3XXLF	0.76µm GOLD	Sn
PLATING CODE	CONTACT AREA	SOLDER TAIL
	PLATING THICKNESS OVER 1.27µm NI	

part. code	surface	tolerance	projection	product family
LF	ISO 1392	ISO 146, 50 TH	ISO 1191	DX VCC SR
S	B-19123(LMU)	14.10.21	42°	
L	F04-0337(DLE)	04.08.31	42°	
M	F04-0343(DLE)	04.11.09	42°	
N	F06-0204(DLE)	06.06.21	42°	
P	F07-0271(LMU)	07.12.06	42°	
R	F11-0043(DO)	12.02.22	42°	

SEE NOTES

surface tolerance: ISO 1392, ISO 146, 50 TH, ISO 1191

projection: ISO 1191

product family: DX VCC SR

title: **SELECTED LOADED**

dwg no: **87627**

sheet 1 of 1

size: **A2**

customer: **CUSTOMER**

drawing: **Drawing**

revision: **1**

index: **6**