

MATERIAL NO.	ENG. NO.	MATL NO. (TAPE)	ENG. NO. (TAPE)	STUD SIZE	"S"±.005	"W" MAX	"C" MIN	"L" MAX	"H" NOMINAL
----	----	----	----	14	.265 (6.73)	.544 (13.82)	.554 (14.07)	1.250 (31.75)	1.172 (29.77)
190730059	BB-818-38	190730060	BB-818-38T	38	.390 (9.91)	.544 (13.82)	.554 (14.07)	1.250 (31.75)	1.172 (29.77)
190730061	BB-818-56	190730062	BB-818-56T	56	.328 (8.33)	.544 (13.82)	.554 (14.07)	1.250 (31.75)	1.172 (29.77)
190730065	BB-823-04	190730066	BB-823-04T	04	.119 (3.02)	.270 (6.86)	.209 (5.31)	.770 (20.32)	.980 (24.89)
190730067	BB-823-06	190730070	BB-823-06T	06	.146 (3.71)	.270 (6.86)	.209 (5.31)	.770 (20.32)	
190730072	BB-823-08	190730073	BB-823-08T	08	.173 (4.39)	.270 (6.86)	.209 (5.31)	.770 (20.32)	
190730074	BB-825-10	----	----	10	.198 (5.03)	.477 (12.12)	.388 (9.86)	1.077 (27.36)	.980 (24.89)
190730076	BB-825-14	190730077	BB-825-14T	14	.265 (6.73)	.477 (12.12)	.388 (9.86)	1.077 (27.36)	
190730079	BB-825-56	190730080	BB-825-56T	56	.328 (8.33)	.477 (12.12)	.388 (9.86)	1.077 (27.36)	

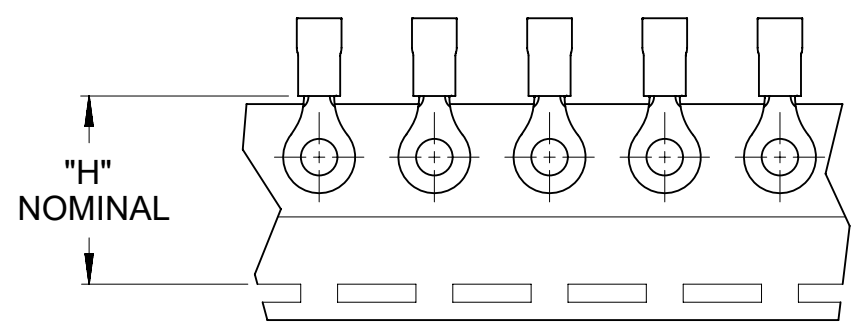
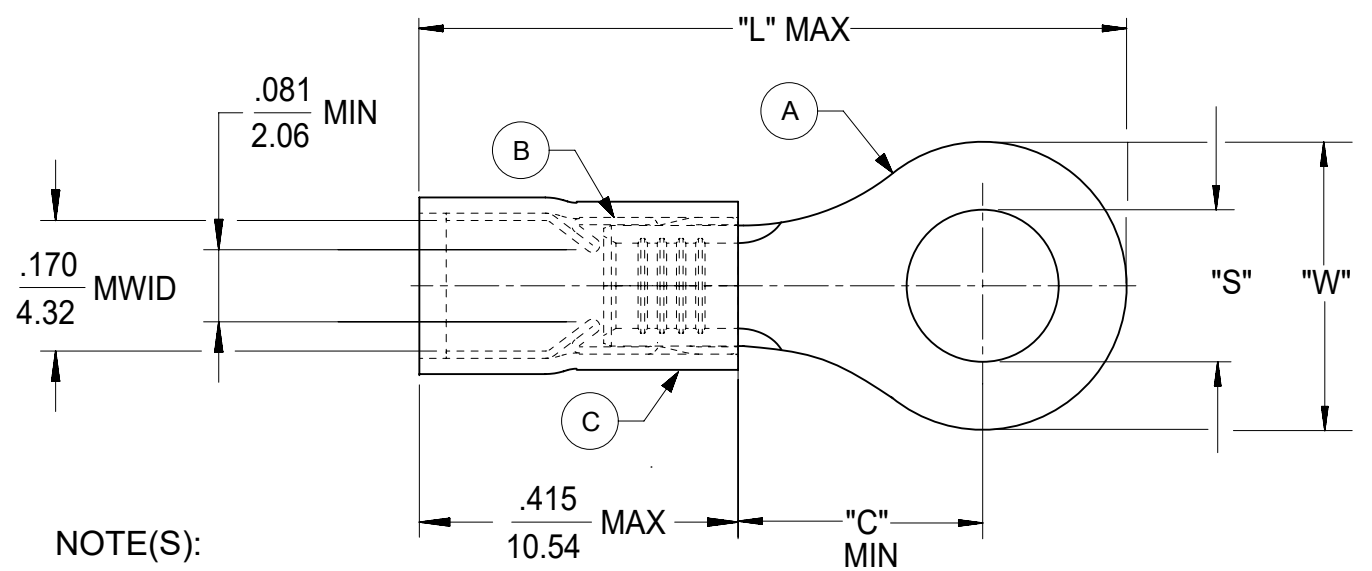

PARTS ON TAPE

- NOTE(S):
- MATERIAL:
    - (A) RING TONGUE TERMINAL: COPPER .031 (0.79) THICK REF PLATING: ELECTROPLATE TIN (.0003 MIN.)
    - (B) FERRULE: TIN-PLATED BRASS
    - (C) INSULATION: BLUE NYLON
  - MWID=MAXIMUM WIRE INSULATION DIA.
  - DIMENSIONS SHOWN ARE FOR REFERENCE ONLY.
  - WIRE SIZE: 16-14 AWG  
1.0-2.5 MM<sup>2</sup>
  - "UL" LISTING #E32244  
"CSA" LISTING #18689
  - TERMINAL PART NUMBER(S): 190730060 (BB-818-38T) & -0062 (BB-81856T)  
WILL REQUIRE ADDITIONAL TOOLING: DIE SPACER SET 190270133 (ATP-DS-187)  
\*\*THE SPACER IS NOT INCLUDED AND/ OR WILL NOT AUTOMATICALLY BE SENT WITH THE DIE SET. \*\*
  - PARTS ARE RoHS COMPLIANT.

THIS DRAWING CONTAINS INFORMATION THAT IS PROPRIETARY TO MOLEX ELECTRONIC TECHNOLOGIES, LLC AND SHOULD NOT BE USED WITHOUT WRITTEN PERMISSION									
FUNCTIONAL SYMBOLS	DIMENSION UNITS	SCALE	CURRENT REV DESC: ADD NOTE 6: ADDITIONAL DIE SET SPACER NEEDED (ATP-DS-187)						
$\nabla_A = 0$	INCH/MM	4:1	<p><b>molex</b></p> <p>RING TONGUE TERMINAL AVIKRIMP, 800-SERIES 16-14 AWG</p> <p>PRODUCT CUSTOMER DRAWING</p> <p>DOCUMENT NUMBER: SD-19073-005   DOC TYPE: PSD   DOC PART: 001   REVISION: C2</p> <p>EC NO: 667572   DRWN: DMYRICK   2021/06/17</p> <p>CHK'D: JMACNEIL   2021/06/18</p> <p>APPR: JMACNEIL   2021/06/18</p> <p>INITIAL REVISION: DRWN: APPR:</p> <p>DRAFT WHERE APPLICABLE MUST REMAIN WITHIN DIMENSIONS</p> <p>THIRD ANGLE PROJECTION</p> <p>DRAWING: B-SIZE   SERIES: 19073</p> <p>MATERIAL NUMBER:   CUSTOMER: GENERAL MARKET   SHEET NUMBER: 1 OF 1</p>						
$\nabla_E = 0$	GENERAL TOLERANCES (UNLESS SPECIFIED)								
$\nabla_F = 0$	MM	INCH							
DIVISIONAL SYMBOLS	4 PLACES	±							
	3 PLACES	± 0.005							
	2 PLACES	± 0.13 ± 0.01							
	1 PLACE	± 0.25 ±							
	0 PLACES	±							
	ANGULAR TOL	± 1.0°							