



STANDARD EXECUTIONS

- DVA.5: bushing with threaded blind hole and base plate in polished

... to the description with the desired hardness:
40, 55 or 70 tolerance ±5 Shore A

DVA.5 - 10 - 10 - M4 - 55

D L d Shore

Conversion Table
1 mm = 0.039 inch

D		L	
mm	inch	mm	inch
8	0.31	50	1.97
10	0.39	8	0.31
10	0.39	30	1.18

DVA.5



Description	Hardness 40 Shore A						Hardness 55 Shore A						Hardness 70 Shore A					
	D	L	d	h	⚖	Code	Max load [N]	Max deflection [mm]	Stiffness [N/mm]	Code	Max load [N]	Max deflection [mm]	Stiffness [N/mm]	Code	Max load [N]	Max deflection [mm]	Stiffness [N/mm]	
DVA.5-8-8-M3*	8	8	M3	3	1	415691	34	2	17	413029	55	2	28	418391	141	2	2	2
DVA.5-8-13-M3*	8	13																
DVA.5-10-15-M4*	10	15	M4	4	2	415703	69	4	18	413033	92	4	25	418403	175	4	4	47
DVA.5-15-15-M4*	15	15	M4	4	5	415711	141	4	38	413041	259	4	69	418411	384	4	4	102
DVA.5-15-20-M4*	15	20	M4	4	6	415721	134	5	27	413051	223	5	45	418421	590	5	5	118
DVA.5-20-15-M6*	20	15	M6	6	10	415731	289	4	77	413061	468	4	125	418431	704	4	4	188
DVA.5-20-20-M6*	20	20	M6	6	11	415741	258	5	52	413071	367	5	73	418441	809	5	5	162
DVA.5-20-25-M6*	20	25	M6	6	13	415751	250	6	40	413081	437	6	70	418451	750	6	6	120
DVA.5-20-30-M6*	20	30	M6	6	15	415756	285	7	38	413086	410	7	55	418456	615	7	7	82
DVA.5-25-15-M6*	25	15	M6	6	16	415761	485	4	129	413091	797	4	213	418461	1627	4	4	434
DVA.5-25-20-M6*	25	20	M6	6	20	415771	416	5	83	413101	581	5	116	418471	1382	5	5	276
DVA.5-25-25-M6*	25	25	M6	6	21	415776	510	6	82	413105	635	6	102	418476	1262	6	6	202
DVA.5-25-30-M6*	25	30	M6	6	21	415781	290	8	39	413106	591	8	79	418481	1186	8	8	158

Vibration damping elements

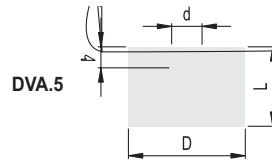

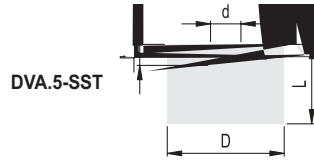

1

2

3

4

5

6

METRIC