

REVISIONS

P	LTR	DESCRIPTION	DATE	DWN	APVD
F		ECR-09-007414	02JUN2009	KG	DW
F1		ECR-16-015298	07NOV2016	KG	DW
G		ECR-17-014341	24OCT2017	KG	DW
G1		ECR-17-017934	12DEC2017	KG	DW

1. USE WITH FERRULE ASSEMBLY KIT P/N 1588908-1 OR P/N 1588700-1.
QUANTITY OF 2 REQUIRED.

2. PROTECTIVE LABEL APPLIED AFTER FINAL CLEAN ROOM TEST TO PREVENT OPTICAL CAVITY CONTAMINATION. REMOVE ONLY WHEN READY TO ASSEMBLE.

3. MULTIMODE IDENTIFIER.

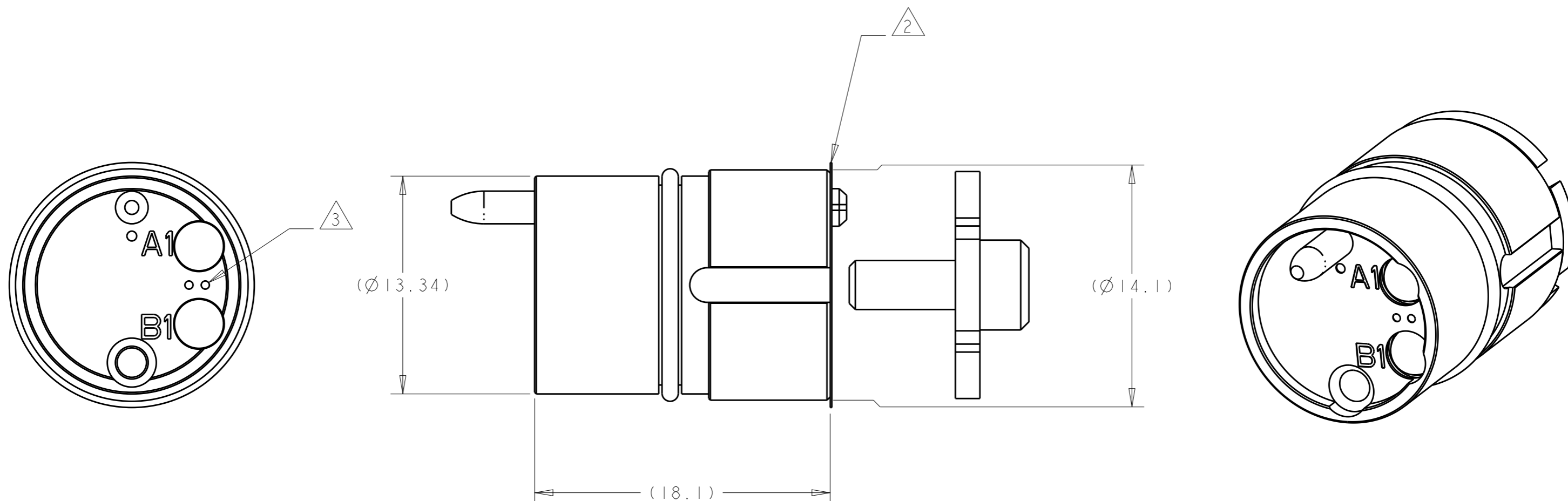

2 CHANNEL, 850/1300nm MM	1515743-1
DESCRIPTION	PART NO.

THIS DRAWING IS A CONTROLLED DOCUMENT.		DWN E. HOPKINS 08OCT2002		
DIMENSIONS: mm		CHK D. WERTMAN 08OCT2002		
TOLERANCES UNLESS OTHERWISE SPECIFIED:		APVD D. WERTMAN 08OCT2002	NAME INSERT ASSEMBLY, PRO BEAM JR., 2 CHANNEL, 850/1300nm MM	
0 PLC ±-		PRODUCT SPEC	-	
1 PLC ±-		APPLICATION SPEC	-	
2 PLC ±-		WEIGHT	-	
3 PLC ±-		CUSTOMER DRAWING	-	
4 PLC ±-		SCALE	4:1	
ANGLES ±2		SIZE	A3	
FINISH		CAGE CODE	00779	
MATERIAL STAINLESS ALLOYS & NBR		DRAWING NO	G-1515743	
-		RESTRICTED TO	-	
-		SHEET	1 OF 1	
-		REV	G1	