

ohne Verriegelung
without interlocking

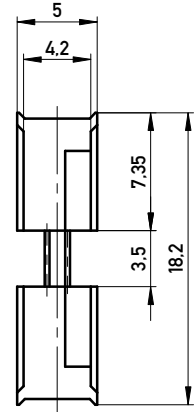

mit Verriegelung
with interlocking

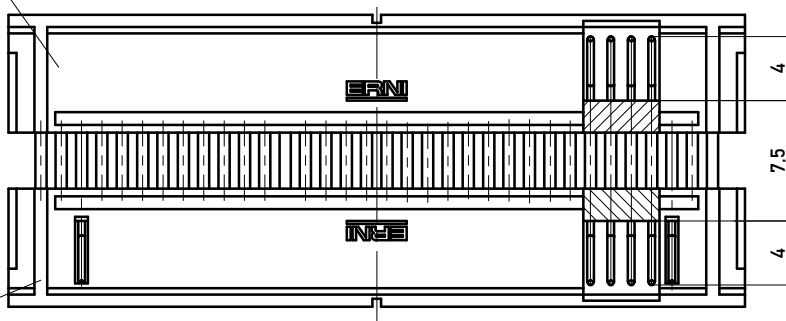
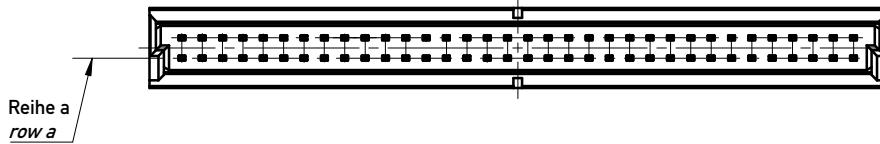

Verpackt in Tray -tray packaging
Verpackungseinheit 68 Stück -packaging unit 68

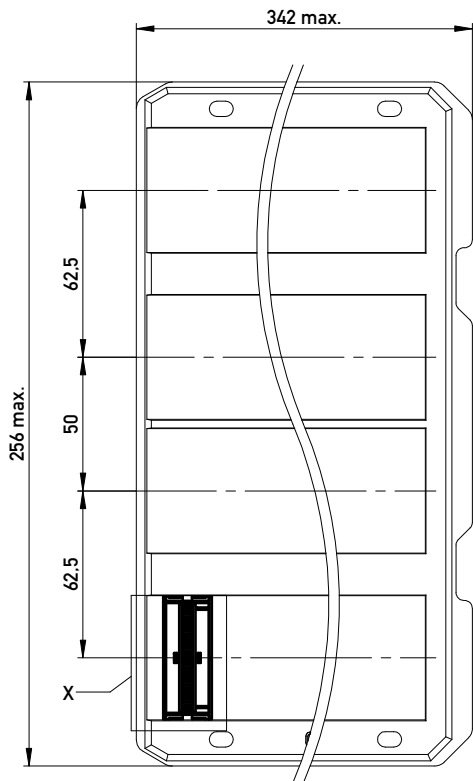

Einzelheit X (M 2:1)
detail X (scale 2:1)

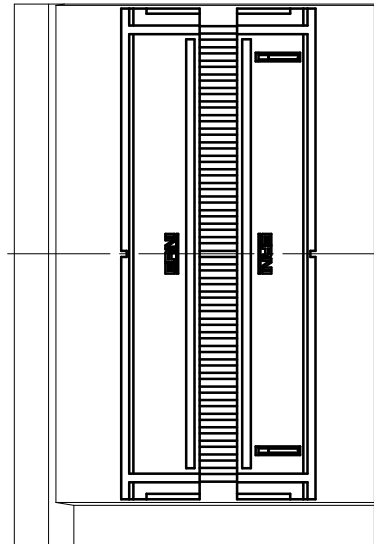

Adapterstück für board-to-board Abstand von 20mm (beidseitig verbaut mit Federleiste: 154808, Low Profile)
Adapter for board-to-board height 20mm (in combination with two female connectors: 154808, low profile)

Information:	Tolerances		Scale	3:1
	All Dimensions in mm			
All rights reserved. Only for Information. To ensure that this is the latest version of this drawing, please contact one of the ERNI companies before using.	Subject to modification without prior notice. Drawing will not be updated.		Designation	
	www.ERNI.com		1,27 DRC BTB 20mm 68-polig 1,27 DRC BTB 20mm 68-pin	
c	22.08.2016	364715		I
Index	Date	Class		A3
		DRCBTB		

Copyright by ERNI Production GmbH & Co. KG
Proprietary notice pursuant to ISO 16063 to be observed.