

| ITEM NO. | PART NUMBER | DESCRIPTION  | QTY. | COMPONENT NOTES |
|----------|-------------|--|------|-----------------|
| 1        | 50-00525    | Connector, dc plug, 5.5x2.5xL18.5 mm, molding style, spring contacts, white insulators | 1    |                 |
| 2        | 30-00405    | Wire, 2C TS, 24 AWG, UL2468, 300V, 80C, 3.0 mm, VW-1, PVC, 87A, white                  | 1    |                 |
| 3        | 24-00006    | Overmold, PVC, white   | 1    |                 |

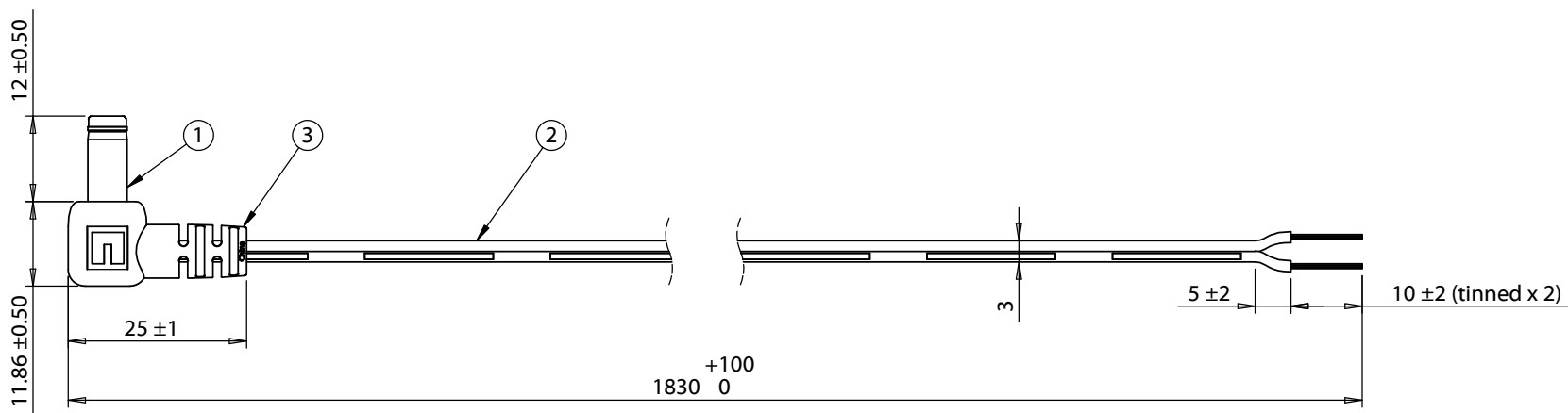
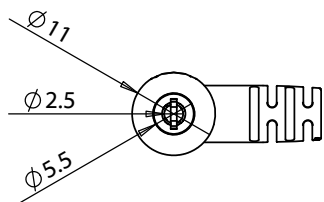

**Notes:**

Cables individually tied and bundled in groups of 10

Functionally equivalent components may be substituted

4 A, 12 Vdc

| Wiring Diagram |                   |
|----------------|-------------------|
| 50-00525       | wire color        |
| center         | white with stripe |
| sleeve         | white             |

|           |            |                 |   |   |   |
|-----------|------------|-----------------|---|---|---|
| Revision: | Date:      | Description:    | Prepared:   | Notes:  | <h1>TENSILITY</h1><br>tel 1.541.323.3228 800 877.670.7118<br>fax 1.541.323.4202 web tensility.com |
| A         | 12/11/2015 | Initial release | GL 2016.06.16<br>12:20:21<br>-07'00'  |   |   |
|           |            |                 | Verified:   | Function test: no open, no short circuit, no intermittent   | Size: Part number:<br>A 10-01240  |
|           |            |                 | LA<br><small>Digitally signed by LA<br/>DN: cn=LA, o=Tensility<br/>ou=Engineering,<br/>email=la@tensility.com, c=US<br/>Date: 2016.06.21 14:56:10 -07'00'</small> |   |   |
|           |            |                 | Dimensions are in millimeters.<br>Tolerances:<br>X: ± 0.5 mm<br>X.X: ± 0.3 mm<br>X.XX: ± 0.05 mm  | Description:<br>Cable, 1830 mm, 5.5x2.5x12 mm 90° 50-00525 dc plug to stripped tinned, 24 AWG, 30-00405 wire, white | Scale: 1:2  |
|           |            |                 |   |   | Sheet 1 of 1  |