

PART NO.

RSA-3010-C3

REV	DESCRIPTION	DWN	DATE	APPROVED
-	ENGINEERING RELEASE	CZ	11/04/21	JDMc

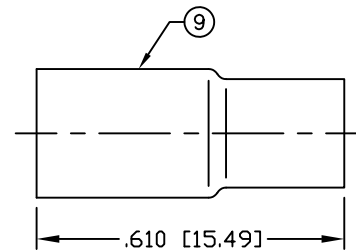
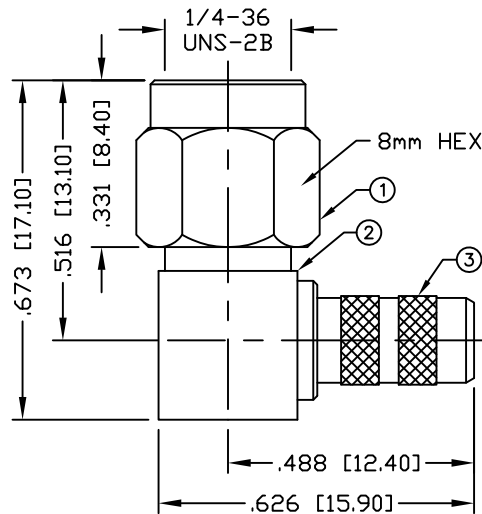

RECOMMENDED CRIMP SIZE: .213"

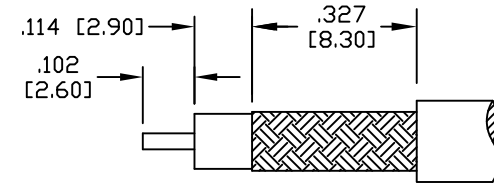

RECOMMENDED STRIPPING DIMENSIONS

NOTE: ATTACH CABLE TO CONNECTOR BY
SOLDERING THE CABLE INNER CONDUCTOR
TO THE PIN SLOT INSIDE THE CONNECTOR

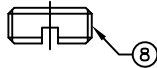

SPECIFICATIONS:

IMPEDANCE: 50 Ohms

FREQUENCY RANGE: 0-12.4 GHz

INSERTION LOSS(dB): $0.04 \times \sqrt{f(\text{GHz})}$ VSWR: $1.15 + .03 \times \sqrt{f(\text{GHz})}$

WORKING VOLTAGE: 500 V rms Max. @ Sea Level

INSULATION RESISTANCE: 5k M Ohms min.

TEMPERATURE RANGE: -65°C TO 85°C

FOR ALPHA 9859, 9859-EL & 9158S, BELDEN 82240, 82907, 88240,

89907 & 84303, BERK-TEK 642002 & 640143, BICCGENERAL C3519

& C3579, CAROL/GENERAL C3519 & C3579, COLEMAN 921023,

821015, 921025, 921027 & 921021, CONTINENTAL C6101,

DEC 17-01246-00, HELIX/HITEMP 497106, 497002

& 499109, TIMES MICROWAVE M17/111-RG303,

17-811-77 & AA-3417

#	DESCRIPTION	QTY	MATERIAL	FINISH
1	SHELL	1	BRASS	NICKEL
2	BODY	1	BRASS	NICKEL
3	FERRULE STUD	1	BRASS	NICKEL
4	INSULATOR	1	PTFE	NATURAL
5	PIN	1	BRASS	GOLD
6	RETAINING RING	1	Be.Cu.	NATURAL
7	GASKET	1	SILICONE	RED
8	SCREW CAP	1	BRASS	NICKEL
9	FERRULE	1	BRASS	NICKEL
#	DESCRIPTION	QTY	MATERIAL	FINISH

CUSTOMER
OUTLINE DRAWINGALL DIMENSIONS
ARE REFERENCE ONLYUNLESS OTHERWISE SPECIFIED:
DIMENSIONS ARE IN INCHES
AND [MILLIMETERS]DRAWN
C. ZUÑIGA 11/04/21

CHECKED

ORJ DRAWN
C. ZUÑIGA 11/04/21

RoHS
COMPLIANT

PROPRIETARY AND CONFIDENTIAL
THIS DRAWING CONTAINS
INFORMATION PROPRIETARY TO
RF INDUSTRIES, ANY
UNAUTHORIZED USE OF THIS
DRAWING IS EXPRESSLY
PROHIBITED WITHOUT WRITTEN
PERMISSION FROM RF
INDUSTRIES. ANY VIOLATION IS
PUNISHABLE UNDER U.S.
COPYRIGHT LAWS.

RFconnectors
DIVISION OF RF INDUSTRIES, LTD.

RFINDUSTRIES.COM
7610 MIRAMAR RD.
SAN DIEGO, CA 92126
(858) 549-6340
(858) 549-6345 FAX

SMA PLUG CRIMP

RIGHT ANGLE

DWG #

RSA-3010-C3

CABLE GROUP	CONTROL #	SCALE	FORMAT	SHEET	REVISION
C3	001560	NTS	A	1 OF 1	-