

# PRODUCT DATA DRAWING

REVISION HISTORY			
REV	DESCRIPTION	DATE	APPROVED
-	NRN 45757	04/21	SEE PDM
A	DCN 50729	04/21	
B	DCN 51513	04/22	

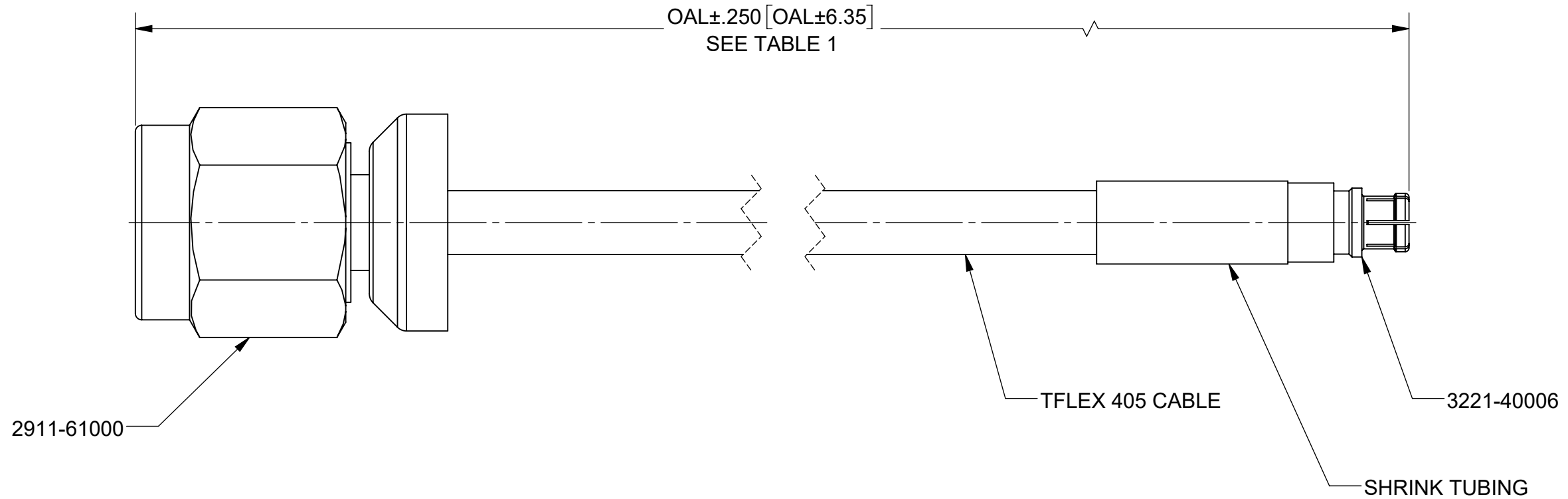
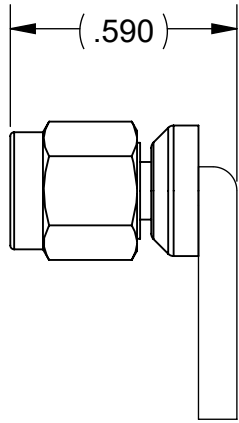

SV P/N	OAL
7029-3639	6.000"
7029-3640	12.000"

**MATERIAL:**

CONNECTORS: 2911-61000 (SMA STRAIGHT MALE LOW PROFILE RF)  
3221-40006 (SMPM STRAIGHT FEMALE)

CABLE: 200-70-139 (TFLEX 405 HF CABLE)

SHRINK TUBING: M23053/5 OR EQUIVALENT

**PERFORMANCE:**

IMPEDANCE: 50 OHMS  
FREQ. RANGE: DC TO 18 GHz

MATERIAL: PER BOM	DIMENSIONS ARE IN INCHES TOLERANCES: FRACTIONAL: ±1/64 ANGULAR: X° ±1°0' X°X' ±15'	UNLESS OTHERWISE SPECIFIED 1) ALL DIMENSIONS ARE AFTER PLATING. 2) BREAK CORNERS & EDGES .005 R. MAX. 3) CHAM. 1ST & LAST THREADS. 4) SURFACE ROUGHNESS 63 / MIL-STD-10. 5) DIA.'S ON COMMON CENTERS TO BE CONCENTRIC WITHIN .005 T.I.R. 6) REMOVE ALL BURRS	 www.svmicrowave.com TITLE: SMA STR. M TO SMPM STR. F TFLEX405 LOW PROFILE RF CABLE ASSEMBLY
FINISH: PER BOM	DECIMAL: X ±.030 .XX ±.010 .XXX ±.005	INTERPRET DIMENSIONS AND TOLERANCES PER ASME Y14.5M - 1994	
<b>PROPRIETARY</b> THE INFORMATION CONTAINED IN THIS DRAWING IS THE SOLE PROPERTY OF SV MICROWAVE, INC. ANY REPRODUCTION IN PART OR AS A WHOLE WITHOUT THE WRITTEN PERMISSION OF SV MICROWAVE, INC IS PROHIBITED.	THIRD ANGLE PROJECTION 	DRAWN: TSW 04/20/21 CHECKED: SEE PDM APPROVED: SEE PDM E.M. SIMULATION: N/A	SIZE DWG. NO. <b>B</b> 7029-3639-3640 SCALE: 5:1 SHEET 1 OF 1