

CAT P/N	ENG P/N	SHELL FINISH	CONTACT FINISH
JM2P	55010536-000	NICKEL PLATE	TIP & SLEEVE - NICKEL PLATED
JM2P-AU	55010536-001	NICKEL PLATE	TIP & SLEEVE - GOLD PLATED
JM2PB	55010536-002	MATT BLACK	TIP & SLEEVE - NICKEL PLATED
JM2PB-AU	55010536-003	MATT BLACK	TIP & SLEEVE - GOLD PLATED

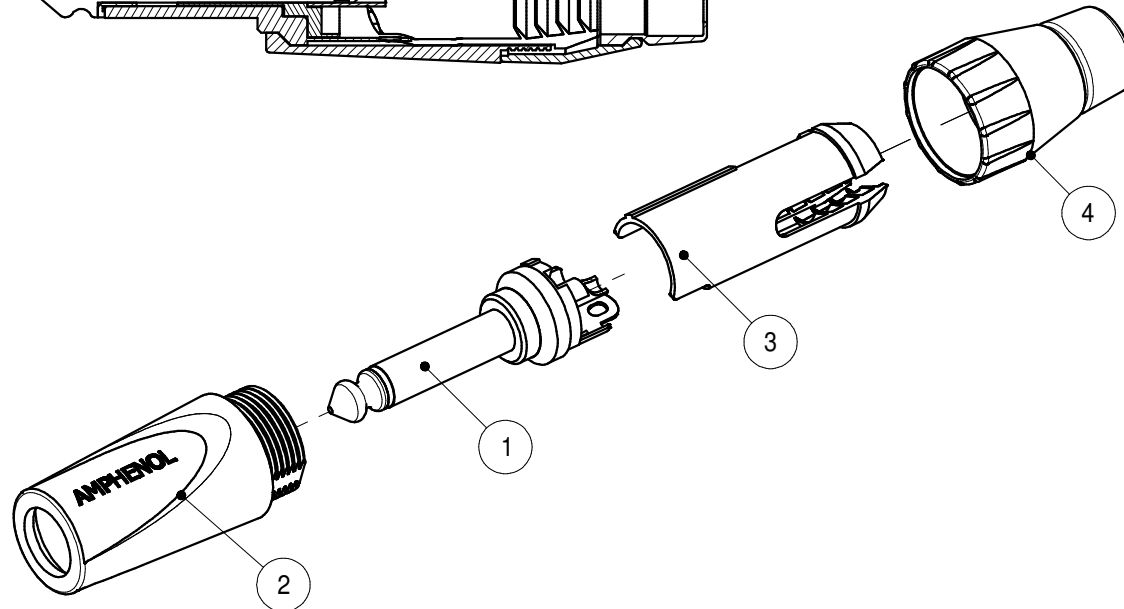

NOTE:  
1. CONTACT FACTORY FOR THE AVAILABILITY OF COLOURED GROMMET

ITEM	PART NUMBER	DWG No.	DESCRIPTION	QTY
4	50440035-530	50440035-530-1	JUMBO BACKSHELL ASSEMBLY	1
3	50260005-521	50260005-521-1	1/4" PHONE JUMBO CABLE CLAMP	1
2	53480053-331	53480053-331-1	JUMBO DIECAST SHELL	1
1	51560071-131	51560071-131-1	JUMBO INSERT ASSEMBLY	1

UNLESS OTHERWISE SPECIFIED TOLERANCE TO BE		THIS DOCUMENT IS THE PROPERTY OF AMPHENOL AUSTRALIA PTY. LTD. NO PART THEREOF MAY BE REPRODUCED AND USED WITHOUT THE PRIOR WRITTEN CONSENT OF THE OWNER			
LINEAR	ANGULAR	CAD FILE: 55010536000110		DRN: A.O	DATE: 27/06/08
X ± 1 X.X ± 0.5 X.XX ± 0.1	X ± 1 X.X' ± 30' X.XX' ± 15'	MATL: SEE COMPONENTS		CKD: M.N.H	DATE: 17/07/08
BREAK ALL SHARP EDGES AND REMOVE ALL BURRS		FINISH: SEE TABLE		APP'D: P.M	DATE: 17/07/08
DO NOT SCALE		SCALE: 1:1		PART No: SEE TABLE	
DIMENSIONS IN MILLIMETRES		THIRD ANGLE PROJECTION		SIZE: A4	

0	FIRST ISSUED	17/07/08	M.H	---
REV	DESCRIPTION	DATE	BY	CHG/No
REVISION HISTORY				
TITLE:		1/4" PHONE MONO JUMBO PLUG CUSTOMER DRAWING		
DRAWING NO.		55010536-000-1		
SHEET		1/1		



Parts List

6

5

4

3

2

1