

HF
Halogen Free

PB

DATE CODE
SEE NOTES 4

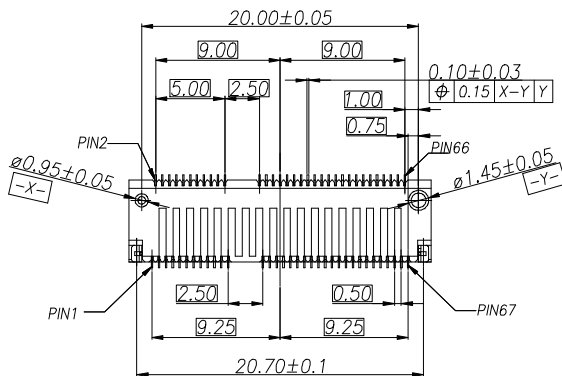
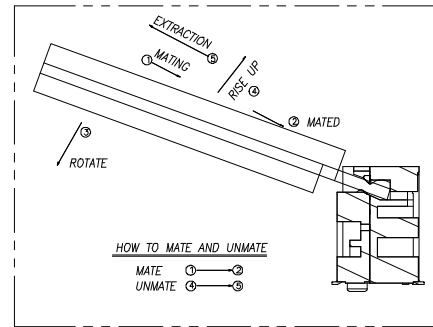
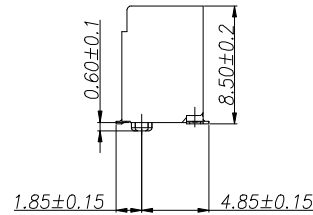
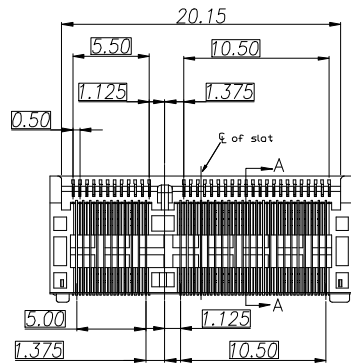
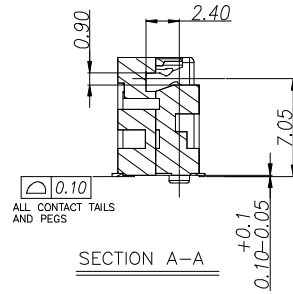
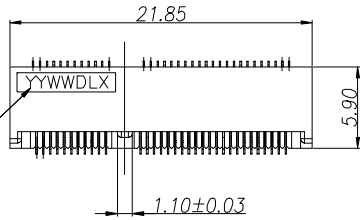

| | |
|--------------|-----------------|
| 30u" Au | 10128797-005RLF |
| 15u" Au | 10128797-004RLF |
| GOLD FLASH | 10128797-001RLF |
| CONTACT AREA | FCI P/N |

NOTES:

- MATERIAL:
 - HOUSING: HIGH TEMPERATURE THERMOPLASTIC, UL94V-0, COLOR: BLACK
 - CONTACTS: COPPER ALLOY;
 - PEG: STAINLESS STEEL.
- REFLOW SOLDER CAPABLE TO 260°C.
- FINISH:

CONTACT:

 - 50u" MIN NICKEL UNDERPLATING OVERALL.
 - CONTACT AREA: GOLD PLATED (SEE TABLE)
 - SOLDER AREA: GOLD FLASH 1u" MIN.

PEG:

 - 50u" MIN. NICKEL UNDERPLATING OVERALL.
 - 80u" MIN. MATTE-TIN PLATED ON SURFACE.
- DATE CODE : YYWWDLX
 - YY: YEAR (09: 2009)
 - WW: WEEK (25: THE 25TH WEEK)
 - D: DAY (1~7: SUNDAY~SATURDAY)
 - L: LINE NUMBER OF ASSEMBLY (A: LINE A)
 - X: D OR N (D: DAY; N: NIGHT)
- PRODUCT SPECIFICATION SEE FCI GS-12-1195
- PART NO:
10128797-00XR~~L~~F

LF: LEAD FREE & RoHS COMPLIANCE

PACKAGE CODE:
R: TAPE & REEL PACKING

PLATING CODE:
1: 1u"Min GOLD FLASH ON CONTACT AREA
4: 15u"Min GOLD ON CONTACT AREA
5: 30u"Min GOLD ON CONTACT AREA

| | | | | | |
|--------------------|----------------|---------------------------------------|-------------------|------------|--|
| mat'l. code | | surface | tolerance | projection | product family |
| ltr ecn no dr date | | tolerances unless otherwise specified | | mm | title M.2 CONNECTOR 8.5H_STD_KEY E |
| A | BF | 2013-04-18 | angles .X ±0.3 | | |
| B | ELX-T-19318 | TAI | 2014-11-10 | scale | dwg no 10128797 sheet 1 of 3 size A4 |
| | | X*±2" | | scale | |
| | | dr | BEER FU | 2013-05-02 | type Customer Drawing |
| | | engr | BEER FU | 2013-05-02 | |
| | | chr | BEER FU | 2013-05-02 | |
| | | appd | BEER FU | 2013-05-02 | |
| sheet index | revision sheet | B | B | B | |
| | | 1 | 2 | 3 | |

HF
Halogen Free

PB

PLUG PCB

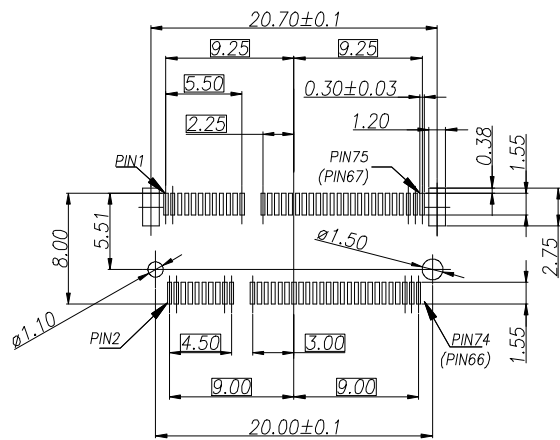
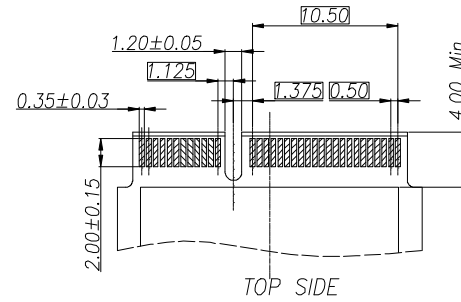
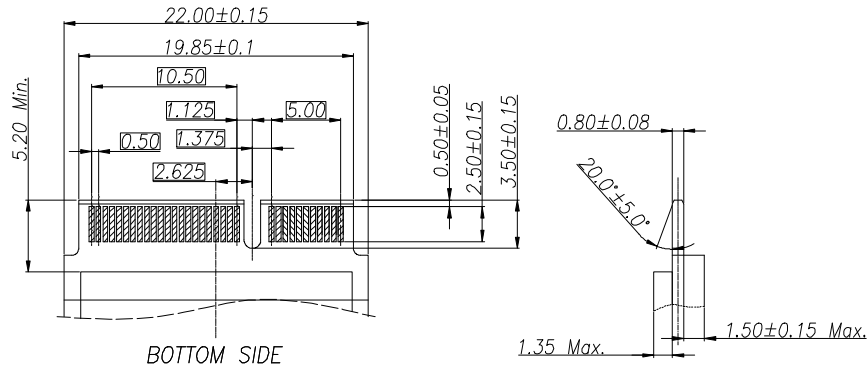

RECOMMENDED PCB LAYOUT
THICKNESS: 1.20 ± 0.05 mm

| | | | |
|--|-----------------------|--------------|------|
| | dwg no | sheet 2 of 3 | size |
| | 10128797 | | A4 |
| | type Customer Drawing | | |

| sheet index | revision sheet | B 1 | B 2 | B 3 | | | | | | | | | | | |
|-------------|----------------|-----|-----|-----|--|--|--|--|--|--|--|--|--|--|--|
| | | | | | | | | | | | | | | | |

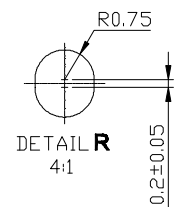
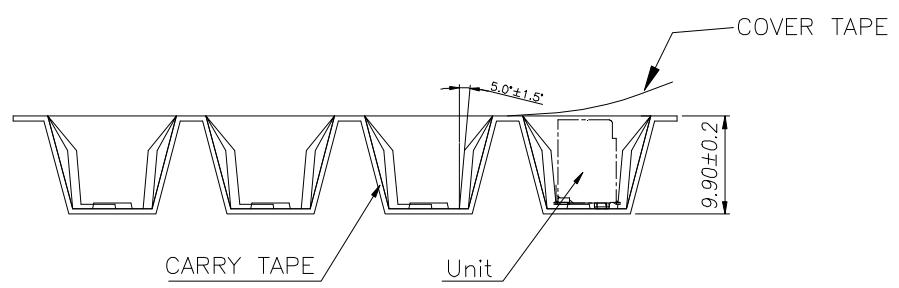
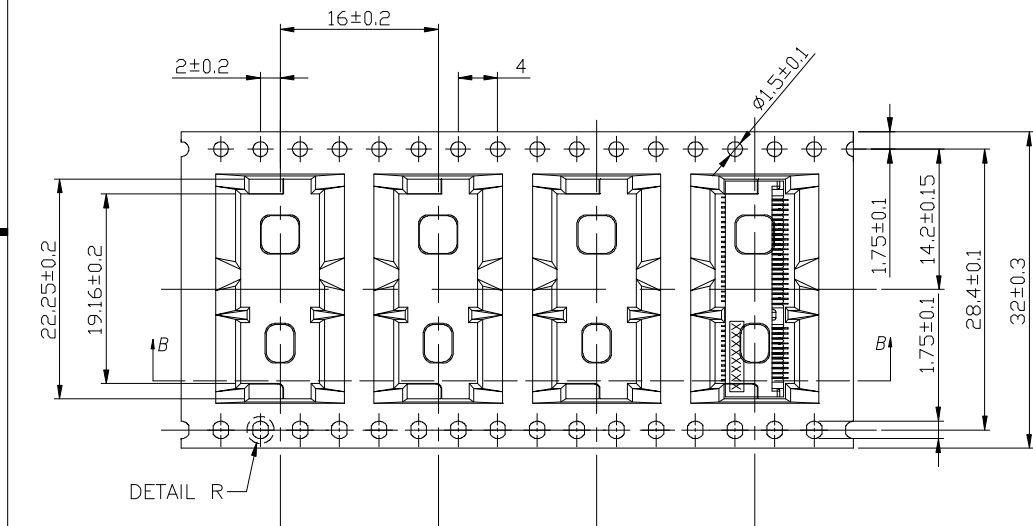
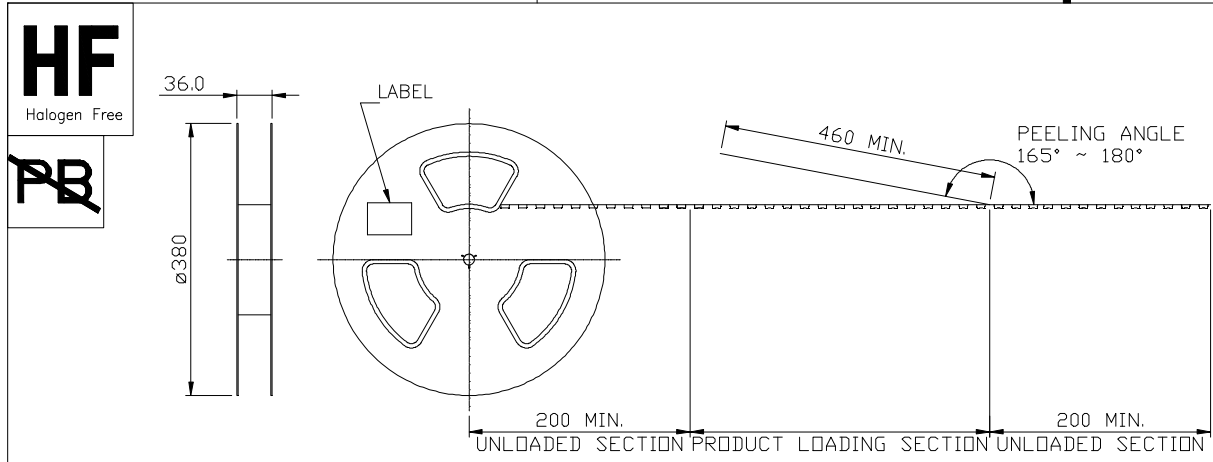

- NOTES :
- MATERIAL :
 COVER TAPE : ANTISTATIC P.S T=0.05±0.01 ,COLOR:CLEAR
 CARRIER TAPE : ANTISTATIC P.S T=0.40±0.10,COLOR:BLACK
 REEL : PS UL94V-0
 CARTON: CORRUGATED FIBER
 - DIMENSION :
 REEL : SEE DRAWING
 SHIPPING BOX: 385X385X225mm
 - QUANTITY : SEE TABLE
 - PEELING RESISTANCE : 10gf~130gf (for 12~56mm)
 - PEELING SPEED : 300mm/MINUTES

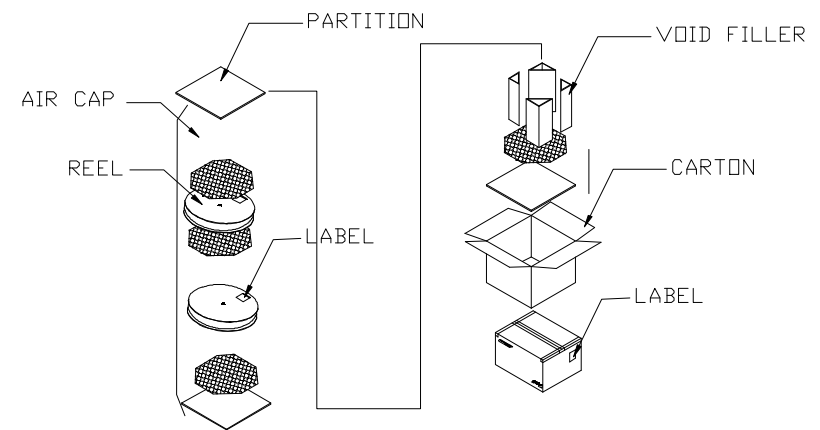

| | | | | |
|--------------|------------|-----------|--------------|-------------|
| 5.35KG | 3.525KG | 500 | 5 | 2500 |
| GROSS WEIGHT | NET WEIGHT | PCS/ REEL | REEL/ CARTON | PCS/ CARTON |

FCI | dwg no 10128797 | sheet 3 of 3 | size A4
 type Customer Drawing

| | | | | | | | | | | | | | | | | | | | | |
|-------------|----------------|-----|-----|-----|--|--|--|--|--|--|--|--|--|--|--|--|--|--|--|--|
| sheet index | revision sheet | B 1 | B 2 | B 3 | | | | | | | | | | | | | | | | |
|-------------|----------------|-----|-----|-----|--|--|--|--|--|--|--|--|--|--|--|--|--|--|--|--|