

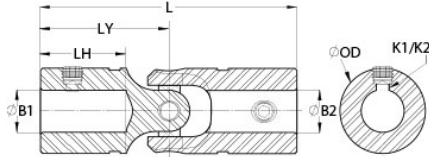

## USKC16-8-8-F

Ruland USKC16-8-8-F, 1/2" x 1/2" Single Universal Joint, Needle Bearing, Steel, Set Screw With Keyway, 0.995" OD, 3.375" Length



### Description

Ruland USKC16-8-8-F is a single cardan needle bearing universal joint with 0.5000" x 0.5000" bores, 1/8" x 1/8" keyways, 0.995" OD, 3.375" length, and #10-32 set screws. It is ideal for applications where higher accuracy, service life, and speed are required. This needle bearing universal joint is comprised of needle roller bearings, precision machined trunnions with hardened and ground journals, and two yokes for reduced friction and increased performance in high performance applications. USKC16-8-8-F is designed for use in high RPM applications up to 6000 RPM and has extended service life due to pre-lubricated maintenance free bearings. It is made from high grade alloy steel for durability and high strength. When combined with boot [UBOOT16/25-NI-KIT](#) the joint is protected from unwanted contaminants such as dust or water and self lubricates reducing maintenance time. This single cardan universal joint is manufactured in the USA by Belden Universal for strict control of processes.

### Product Specifications

<b>Bore (B1)</b>	0.5000 in	<b>Small Bore (B2)</b>	0.5000 in
<b>Keyway (K1)</b>	1/8 in	<b>Keyway (K2)</b>	1/8 in
<b>B1 Max Shaft Penetration</b>	1.190 in	<b>B2 Max Shaft Penetration</b>	1.190 in
<b>Joint Outer Diameter (OD)</b>	0.995 in	<b>Bore Tolerance</b>	+0.0010 in / -0.0000 in
<b>Length (L)</b>	3.375 in	<b>Yoke Length (LY)</b>	1.688 in
<b>Hub Depth (LH)</b>	1.190 in	<b>Broached Set Screw</b>	#10-32
<b>Screw Material</b>	Alloy Steel	<b>Max Operating Angle</b>	45°
<b>Material Specification</b>	Alloy Steel	<b>Manufacturer</b>	Belden Universal
<b>Country of Origin</b>	USA	<b>Weight (lbs)</b>	0.481000
<b>Recommended Lubricant</b>	LUBRIPLATE No. 1200-2	<b>Matching Boot Cover</b>	<a href="#">UBOOT16/25-NI-KIT</a>
<b>UPC</b>	634529305232	<b>Tariff Code</b>	8483.60.4000
<b>UNSPC</b>	25173810		

**Note 1** Performance ratings are for guidance only. The user must determine suitability for a particular application.

**Prop 65**  **WARNING** This product can expose you to the chemical Ethylene Thiourea, known to the State of California to cause cancer and birth defects or other reproductive harm. For more information go to [www.P65Warnings.ca.gov](http://www.P65Warnings.ca.gov).