

SURE-SEAL® IP67
USB SERIES CATALOG



Table of Contents

Technical Information	4
How to Order	
USB Cable Assemblies	5
USB Receptacles	5
USB Cable Mounted Plug Assemblies	
USB-A Circular Plug to USB-A Plug Cable Assembly	6
USB-A Metal Circular Plug to USB-A Plug Cable Assembly	6
USB-A Circular Plug to USB-B Plug Cable Assembly	7
USB-A Metal Circular Plug to USB-B Plug Cable Assembly	7
USB-A Circular Plug to Circular USB-A Plug Cable Assembly	8
USB-A Metal Circular Plug to Metal Circular USB-A Plug Cable Assembly	8
USB-A Circular Plug to Circular USB-B Plug Cable Assembly	9
USB-B Circular Plug to Circular USB-B Plug Cable Assembly	9
USB-B Circular Plug to USB-A Plug Cable Assembly	10
USB-B Circular Plug to USB-B Plug Cable Assembly	10
USB Cable Mounted Receptacle Assemblies	
USB-A Circular Cable Mounted Receptacle to USB-A Plug Cable Assembly.....	11
USB-A Metal Circular Cable Mounted Receptacle to USB-A Plug Cable Assembly.....	11
USB-A Circular Cable Mounted Receptacle to USB-B Plug Cable Assembly	12
USB-A Metal Circular Cable Mounted Receptacle to USB-B Plug Cable Assembly.....	12
USB-A Circular Cable Mounted Receptacle to Circular Cable Mounted USB-A Plug Cable Assembly	13
USB-A Metal Circular Cable Mounted Receptacle to Metal Circular USB-A Plug Cable Assembly	13
USB-A Circular Cable Mounted Receptacle to Circular Cable Mounted USB-B Plug Cable Assembly	14
USB-B Circular Cable Mounted Receptacle to USB-A Plug Cable Assembly	14
USB-B Circular Cable Mounted Receptacle to USB-B Plug Cable Assembly	15
USB-B Circular Cable Mounted Receptacle to Circular Cable Mounted USB-A Plug Cable Assembly	15
USB-B Circular Cable Mounted Receptacle to Circular Cable Mounted USB-B Plug Cable Assembly	16
USB Jamnut Receptacles	
USB-A Circular Receptacle Feed Thru	17
USB-A Metal Circular Receptacle Feed Thru.....	17
USB A Circular Receptacle to PCB Contacts	18
USB-A Metal Circular Receptacle to PCB Contacts.....	18
USB-A Circular Receptacle to Screw Terminals	19
USB-A Metal Circular Receptacle to Screw Terminals.....	19
USB-A Circular Receptacle to Flying Leads	20
USB-A Metal Circular Receptacle to Flying Leads	20
USB-B Circular Receptacle Feed Thru	21
USB-B Circular Receptacle to PCB Contacts.....	21
USB-B Circular Receptacle to Flying Leads	22
Accessories	
USB Receptacle Cap	23
USB Receptacle Metal Cap	23
Gasket	24
Locknut	24
USB PCB Layout	25
Part Numbers	26

Technical Information

Wire Gauge Conversion Chart

Conversion between American Wire Gauge (AWG), Circular Mil Area (CMA), and approximate metric millimeter squared (mm²) wire sizes.

Diameter			Area	
AWG	in.	mm	CMA	mm ^{2*}
4/0 (0000)	0.46	11.68	212000	120
3/0 (000)	0.41	10.41	168000	95
2/0 (00)	0.365	9.27	133000	70
1/0 (0)	0.325	8.26	106000	50
1	0.289	7.34	83700	-
2	0.258	6.55	66400	35
3	0.229	5.82	52600	-
4	0.204	5.18	41700	25
5	0.182	4.62	33100	-
6	0.162	4.11	26300	16
7	0.144	3.66	20800	-
8	0.128	3.25	16500	10
9	0.114	2.90	13100	-
10	0.102	2.59	10400	6
11	0.091	2.31	8230	-
12	0.081	2.06	6530	4
13	0.072	1.83	5180	-

Diameter			Area	
AWG	in.	mm	CMA	mm ^{2*}
14	0.062	1.57	4110	2.5
15	0.057	1.45	3260	-
16	0.051	1.30	2580	1.5
17	0.045	1.14	2050	1
18	0.040	1.02	1620	0.75
19	0.036	0.91	1290	-
20	0.032	0.81	1020	0.5
21	0.0285	0.72	810	-
22	0.0253	0.643	642	0.34
23	0.0226	0.574	509	-
24	0.0201	0.511	404	0.25
25	0.0179	0.45	320	-
26	0.0159	0.404	254	0.14
27	0.0142	0.361	202	-
28	0.0126	0.320	160	0.08
29	0.0113	0.29	127	-
30	0.01	0.254	101	0.05

*Nearest metric wire size
Use to Convert American Wire Gauge to Diameter and Circular Mil Area.

How to Order

USB 2.0 & 3.0 Cable Assemblies

1		2	3	4		5
USB	-	3	WPA	PA	-	1M
SERIES		USB VERSION	CONNECTOR STYLE (END A)	CONNECTOR STYLE (END B)		LENGTH

SERIES

USB = USB Composite
USBM = USB Metal*

USB VERSION

2 = USB 2.0
3 = USB 3.0

CONNECTOR STYLE (END A)

WPA = Molded Plug USB-A
WPB = Molded Plug USB-B
WJA = Molded Receptacle USB-A
WJB = Molded Receptacle USB-B

CONNECTOR STYLE (END B)

WPA = Molded Plug USB-A
WPB = Molded Plug USB-B
PA = USB-A
PB = USB-B

LENGTH**

1M = 1 meters
2M = 2 meters
3M = 3 meters

* Molded USB-B only available in composite
** Additional lengths are available upon request

USB 2.0 & 3.0 Receptacles

1		2	3
IPUSB	-	2	JAFL
SERIES		USB VERSION	STYLE

SERIES

IPUSB = USB Composite
IPUSBM = USB Metal*

USB VERSION

2 = USB 2.0
3 = USB 3.0

STYLE

JAFL = Molded Receptacle USB-A to 500 mm Flying Leads
JBFL = Molded Receptacle USB-B to 500 mm Flying Leads
JAPC = Molded Receptacle A to PC Contacts
JBPC = Molded Receptacle B to PC Contacts
AABHD = Molded Receptacle A to A Feed Thru
BABHD = Molded Receptacle B to A Feed Thru
ASTB = Molded Receptacle A to Terminal Block

* Molded USB-B only available in composite

USB-A Circular Plug to USB-A Plug Cable Assembly

Connector series: USB
Gender: Male
Part No.: IPUSB-*WPAPA-#M

*refers to use version (2.0 or 3.0)
refers to cable length

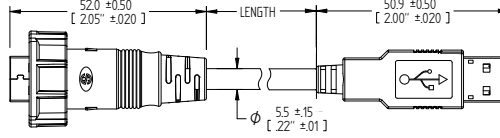

General Information

Connector Type:	USB-A to USB-A	Withstanding voltage:	AC 500V/1 minute
Temperature range:	-20°C ~ +80°C	Salt spray:	48 hr.
Terminal:	Copper alloy, gold plated	Protection class:	IP67 (unmated)
Screw nut:	Nylon + GF	Durability:	1000 times
Mating style:	Screw thread	Current rating:	1.5A
Contact resistance:	≤ 30MΩ	Voltage rating:	30V

USB-A Metal Circular Plug to USB-A Plug Cable Assembly

Connector series: USB
Gender: Male
Part No.: IPUSBM-*WPAPA-#M

*refers to use version (2.0 or 3.0)
refers to cable length

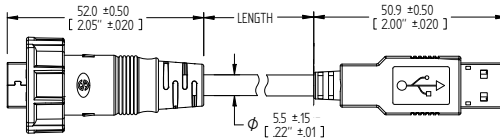

General Information

Connector Type:	USB-A to USB-A	Withstanding voltage:	AC 500V/1 minute
Temperature range:	-20°C ~ +80°C	Salt spray:	48 hr.
Terminal:	Copper alloy, gold plated	Protection class:	IP67 (unmated)
Screw nut:	Zinc alloy, nickel plated	Durability:	1000 times
Mating style:	Screw thread	Current rating:	1.5A
Contact resistance:	≤ 30MΩ	Voltage rating:	30V

Notes

- Please refer to Page 4 for the Conversion between American Wire Gauge AWG and Wire Cross-section mm².
- Please refer to Page 5 for part number breakdown.

USB-A Circular Plug to USB-B Plug Cable Assembly

Connector series: USB
Gender: Male to Male
Part No.: IPUSB-*WPAPB-#M

*refers to use version (2.0 or 3.0)
refers to cable length

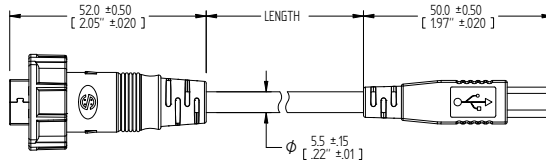

General Information

Connector Type:	USB-A to USB-B	Withstanding voltage:	AC 500V/1 minute
Temperature range:	-20°C ~ +80°C	Salt spray:	48 hr.
Terminal:	Copper alloy, gold plated	Protection class:	IP67 (unmated)
Screw nut:	Nylon + GF	Durability:	1000 times
Mating style:	Screw thread	Current rating:	1.5A
Contact resistance:	≤ 30MΩ	Voltage rating:	30V

USB-A Metal Circular Plug to USB-B Plug Cable Assembly

Connector series: USB
Gender: Male to Male
Part No.: IPUSBM-*WPAPB-#M

*refers to use version (2.0 or 3.0)
refers to cable length

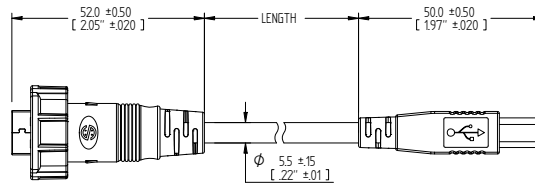

General Information

Connector Type:	USB-A to USB-B	Withstanding voltage:	AC 500V/1 minute
Temperature range:	-20°C ~ +80°C	Salt spray:	48 hr.
Terminal:	Copper alloy, gold plated	Protection class:	IP67 (mated)
Screw nut:	Zinc alloy, nickel plated	Durability:	1000 times
Mating style:	Screw thread	Current rating:	1.5A
Contact resistance:	≤ 30MΩ	Voltage rating:	30V

Notes

- Please refer to Page 4 for the Conversion between American Wire Gauge AWG and Wire Cross-section mm².
- Please refer to Page 5 for part number breakdown.

USB-A Circular Plug to Circular USB-A Plug Cable Assembly

Connector series: USB
Gender: Male to Male
Part No.: IPUSB-*WPAWPA-#M

*refers to use version (2.0 or 3.0)
refers to cable length

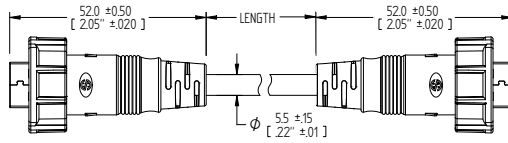

General Information

Connector Type:	USB-A to USB-A	Withstanding voltage:	AC 500V/1 minute
Temperature range:	-20°C ~ +80°C	Salt spray:	48 hr.
Terminal:	Copper alloy, gold plated	Protection class:	IP67 (unmated)
Screw nut:	Nylon + GF	Durability:	1000 times
Mating style:	Screw thread	Current rating:	1.5A
Contact resistance:	≤ 30MΩ	Voltage rating:	30V

USB-A Metal Circular Plug to Metal Circular USB-A Plug Cable Assembly

Connector series: USB
Gender: Male to Male
Part No.: IPUSBM-*WPAWPA-#M

*refers to use version (2.0 or 3.0)
refers to cable length

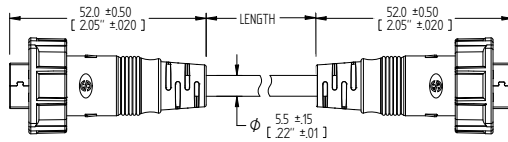

General Information

Connector Type:	USB-A to USB-A	Withstanding voltage:	AC 500V/1 minute
Temperature range:	-20°C ~ +80°C	Salt spray:	48 hr.
Terminal:	Copper alloy, gold plated	Protection class:	IP67 (unmated)
Screw nut:	Zinc alloy, nickel plated	Durability:	1000 times
Mating style:	Screw thread	Current rating:	1.5A
Contact resistance:	≤ 30MΩ	Voltage rating:	30V

Notes

- Please refer to Page 4 for the Conversion between American Wire Gauge AWG and Wire Cross-section mm².
- Please refer to Page 5 for part number breakdown.

USB-A Circular Plug to Circular USB-B Plug Cable Assembly

Connector series: USB
Gender: Male to Male
Part No.: IPUSB-*WPAWPB-#M

*refers to use version (2.0 or 3.0)
refers to cable length

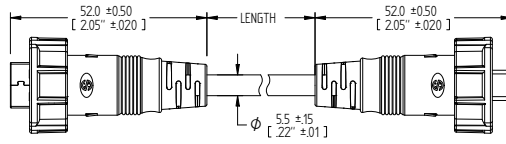

General Information

Connector Type:	USB-A to USB-B	Withstanding voltage:	AC 500V/1 minute
Temperature range:	-20°C ~ +80°C	Salt spray:	48 hr.
Terminal:	Copper alloy, gold plated	Protection class:	IP67 (unmated)
Screw nut:	Nylon + GF	Durability:	1000 times
Mating style:	Screw thread	Current rating:	1.5A
Contact resistance:	≤ 30MΩ	Voltage rating:	30V

USB-B Circular Plug to Circular USB-B Plug Cable Assembly

Connector series: USB
Gender: Male to Male
Part No.: IPUSB-*WPBWPB-#M

*refers to use version (2.0 or 3.0)
refers to cable length

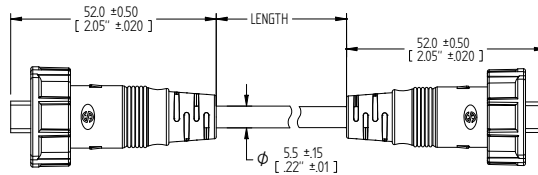

General Information

Connector Type:	USB-B to USB-B	Withstanding voltage:	AC 500V/1 minute
Temperature range:	-20°C ~ +80°C	Salt spray:	48 hr.
Terminal:	Copper alloy, gold plated	Protection class:	IP67 (mated)
Screw nut:	Nylon + GF	Durability:	1000 times
Mating style:	Screw thread	Current rating:	1.5A
Contact resistance:	≤ 30MΩ	Voltage rating:	30V

Notes

- Please refer to Page 4 for the Conversion between American Wire Gauge AWG and Wire Cross-section mm².
- Please refer to Page 5 for part number breakdown.

USB-B Circular Plug to USB-A Plug Cable Assembly

Connector series: USB
Gender: Male to Male
Part No.: IPUSB-*WPBPA-#M

*refers to use version (2.0 or 3.0)
refers to cable length

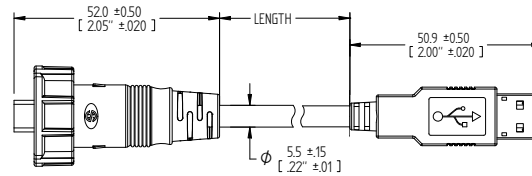

General Information

Connector Type:	USB-B to USB-A	Withstanding voltage:	AC 500V/1 minute
Temperature range:	-20°C ~ +80°C	Salt spray:	48 hr.
Terminal:	Copper alloy, gold plated	Protection class:	IP67 (unmated)
Screw nut:	Nylon + GF	Durability:	1000 times
Mating style:	Screw thread	Current rating:	1.5A
Contact resistance:	≤ 30MΩ	Voltage rating:	30V

USB-B Circular Plug To USB-B Plug Cable Assembly

Connector series: USB
Gender: Male to Male
Part No.: IPUSB-*WPBPB-#M

*refers to use version (2.0 or 3.0)
refers to cable length

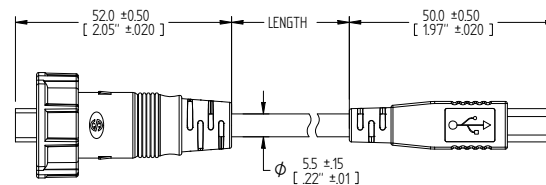

General Information

Connector Type:	USB-B to USB-B	Withstanding voltage:	AC 500V/1 minute
Temperature range:	-20°C ~ +80°C	Salt spray:	48 hr.
Terminal:	Copper alloy, gold plated	Protection class:	IP67 (unmated)
Screw nut:	Nylon + GF	Durability:	1000 times
Mating style:	Screw thread	Current rating:	1.5A
Contact resistance:	≤ 30MΩ	Voltage rating:	30V

Notes

- Please refer to Page 4 for the Conversion between American Wire Gauge AWG and Wire Cross-section mm².
- Please refer to Page 5 for part number breakdown.

USB-A Circular Cable Mounted Receptacle to USB-A Plug Cable Assembly

Connector series: USB
Gender: Female to Male
Part No.: IPUSB-*WJAPA-#M
*refers to use version (2.0 or 3.0)
refers to cable length

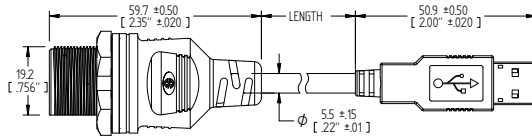

General Information

Connector Type:	USB-A to USB-A	Withstanding voltage:	AC 500V/1 minute
Temperature range:	-20°C ~ +80°C	Salt spray:	48 hr.
Terminal:	Copper alloy, gold plated	Protection class:	IP67 (unmated)
Screw nut:	Nylon + GF	Durability:	1000 times
Mating style:	Screw thread	Current rating:	1.5A
Contact resistance:	≤ 30MΩ	Voltage rating:	30V

USB-A Metal Circular Cable Mounted Receptacle to USB-A Plug Cable Assembly

Connector series: USB
Gender: Female to Male
Part No.: IPUSBM-*WJAPA-#M
*refers to use version (2.0 or 3.0)
refers to cable length

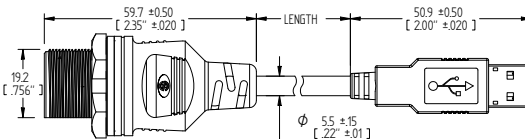

General Information

Connector Type:	USB-A to USB-A	Withstanding voltage:	AC 500V/1 minute
Temperature range:	-20°C ~ +80°C	Salt spray:	48 hr.
Terminal:	Copper alloy, gold plated	Protection class:	IP67 (unmated)
Screw nut:	Zinc alloy, nickel plated	Durability:	1000 times
Mating style:	Screw thread	Current rating:	1.5A
Contact resistance:	≤ 30MΩ	Voltage rating:	30V

Notes

- Please refer to Page 4 for the Conversion between American Wire Gauge AWG and Wire Cross-section mm².
- Please refer to Page 5 for part number breakdown.

USB-A Circular Cable Mounted Receptacle to USB-B Plug Cable Assembly

Connector series: USB
Gender: Female to Male
Part No.: IPUSB-*WJAPB-#M

*refers to use version (2.0 or 3.0)
refers to cable length

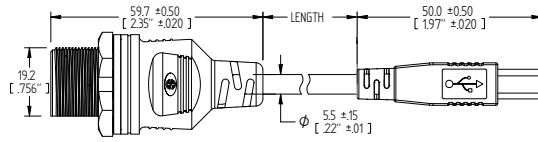

General Information

Connector Type:	USB-A to USB-B	Withstanding voltage:	AC 500V/1 minute
Temperature range:	-20°C ~ +80°C	Salt spray:	48 hr.
Terminal:	Copper alloy, gold plated	Protection class:	IP67 (unmated)
Screw nut:	Nylon + GF	Durability:	1000 times
Mating style:	Screw thread	Current rating:	1.5A
Contact resistance:	≤ 30MΩ	Voltage rating:	30V

USB-A Metal Circular Cable Mounted Receptacle to USB-B Plug Cable Assembly

Connector series: USB
Gender: Female to Male
Part No.: IPUSBM-*WJAPB-#M

*refers to use version (2.0 or 3.0)
refers to cable length

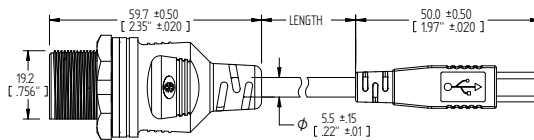

General Information

Connector Type:	USB-A to USB-B	Withstanding voltage:	AC 500V/1 minute
Temperature range:	-20°C ~ +80°C	Salt spray:	48 hr.
Terminal:	Copper alloy, gold plated	Protection class:	IP67 (unmated)
Screw nut:	Zinc alloy, nickel plated	Durability:	1000 times
Mating style:	Screw thread	Current rating:	1.5A
Contact resistance:	≤ 30MΩ	Voltage rating:	30V

Notes

- Please refer to Page 4 for the Conversion between American Wire Gauge AWG and Wire Cross-section mm².
- Please refer to Page 5 for part number breakdown.

USB-A Circular Cable Mounted Receptacle to Circular Cable Mounted USB-A Plug Cable Assembly

Connector series: USB
Gender: Female to Male
Part No.: IPUSB-*WJAWPA-#M
*refers to use version (2.0 or 3.0)
refers to cable length

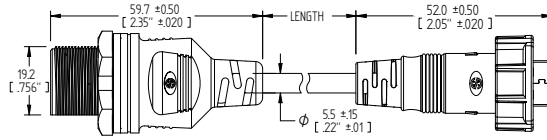

General Information

Connector Type:	USB-A to USB-A	Withstanding voltage:	AC 500V/1 minute
Temperature range:	-20°C ~ +80°C	Salt spray:	48 hr.
Terminal:	Copper alloy, gold plated	Protection class:	IP67 (unmated)
Screw nut:	Nylon + GF	Durability:	1000 times
Mating style:	Screw thread	Current rating:	1.5A
Contact resistance:	≤ 30MΩ	Voltage rating:	30V

USB-A Metal Circular Cable Mounted Receptacle to Metal Circular USB-A Plug Cable Assembly

Connector series: USB
Gender: Female to Male
Part No.: IPUSBM-*WJAWPA-#M
*refers to use version (2.0 or 3.0)
refers to cable length

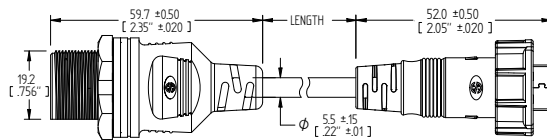

General Information

Connector Type:	USB-A to USB-A	Withstanding voltage:	AC 500V/1 minute
Temperature range:	-20°C ~ +80°C	Salt spray:	48 hr.
Terminal:	Copper alloy, gold plated	Protection class:	IP67 (unmated)
Screw nut:	Zinc alloy, nickel plated	Durability:	1000 times
Mating style:	Screw thread	Current rating:	1.5A
Contact resistance:	≤ 30MΩ	Voltage rating:	30V

Notes

- Please refer to Page 4 for the Conversion between American Wire Gauge AWG and Wire Cross-section mm².
- Please refer to Page 5 for part number breakdown.

USB-A Circular Cable Mounted Receptacle to Circular Cable Mounted USB-B Plug Cable Assembly

Connector series: USB
Gender: Female to Male
Part No.: IPUSB-*WJAWPB-#M

*refers to use version (2.0 or 3.0)
refers to cable length

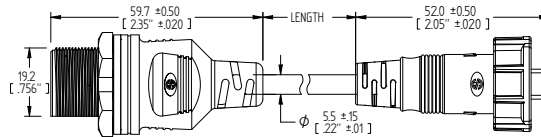

General Information

Connector Type:	USB-A to USB-B	Withstanding voltage:	AC 500V/1 minute
Temperature range:	-20°C ~ +80°C	Salt spray:	48 hr.
Terminal:	Copper alloy, gold plated	Protection class:	IP67 (unmated)
Screw nut:	Nylon + GF	Durability:	1000 times
Mating style:	Screw thread	Current rating:	1.5A
Contact resistance:	≤ 30MΩ	Voltage rating:	30V

USB-B Circular Cable Mounted Receptacle to USB-A Plug Cable Assembly

Connector series: USB
Gender: Female to Male
Part No.: IPUSB-*WJBPA-#M

*refers to use version (2.0 or 3.0)
refers to cable length

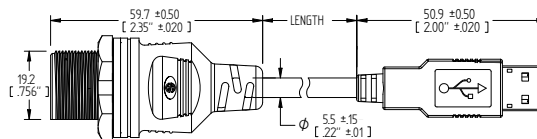

General Information

Connector Type:	USB-B to USB-A	Withstanding voltage:	AC 500V/1 minute
Temperature range:	-20°C ~ +80°C	Salt spray:	48 hr.
Terminal:	Copper alloy, gold plated	Protection class:	IP67 (unmated)
Screw nut:	Zinc alloy, nickel plated	Durability:	1000 times
Mating style:	Screw thread	Current rating:	1.5A
Contact resistance:	≤ 30MΩ	Voltage rating:	30V

Notes

- Please refer to Page 4 for the Conversion between American Wire Gauge AWG and Wire Cross-section mm².
- Please refer to Page 5 for part number breakdown.

USB-B Circular Cable Mounted Receptacle to USB-B Plug Cable Assembly

Connector series: USB
Gender: Female to Male
Part No.: IPUSB-*WJBPB-#M

*refers to use version (2.0 or 3.0)
refers to cable length

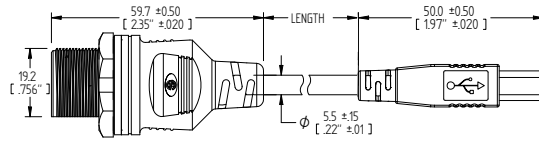

General Information

Connector Type:	USB-B to USB-B	Withstanding voltage:	AC 500V/1 minute
Temperature range:	-20°C ~ +80°C	Salt spray:	48 hr.
Terminal:	Copper alloy, gold plated	Protection class:	IP67 (unmated)
Screw nut:	Zinc alloy, nickel plated	Durability:	1000 times
Mating style:	Screw thread	Current rating:	1.5A
Contact resistance:	≤ 30MΩ	Voltage rating:	30V

USB-B Circular Cable Mounted Receptacle to Circular Cable Mounted USB-A Plug Cable Assembly

Connector series: USB
Gender: Female to Male
Part No.: IPUSB-*WJBWPA-#M

*refers to use version (2.0 or 3.0)
refers to cable length

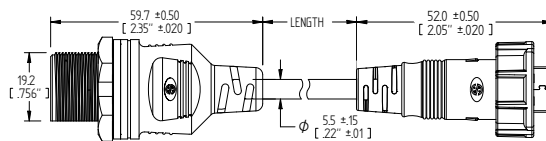

General Information

Connector Type:	USB-B to USB-A	Withstanding voltage:	AC 500V/1 minute
Temperature range:	-20°C ~ +80°C	Salt spray:	48 hr.
Terminal:	Copper alloy, gold plated	Protection class:	IP67 (unmated)
Screw nut:	Zinc alloy, nickel plated	Durability:	1000 times
Mating style:	Screw thread	Current rating:	1.5A
Contact resistance:	≤ 30MΩ	Voltage rating:	30V

Notes

- Please refer to Page 4 for the Conversion between American Wire Gauge AWG and Wire Cross-section mm².
- Please refer to Page 5 for part number breakdown.

USB-B Circular Cable Mounted Receptacle to Circular Cable Mounted USB-B Plug Cable Assembly

Connector series: USB
 Gender: Female to Male
 Part No.: IPUSB-*WJBWPB-#M

*refers to use version (2.0 or 3.0)
 # refers to cable length

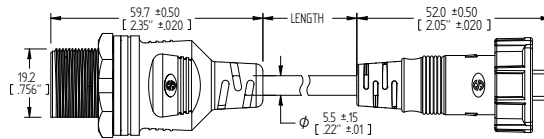

General Information

Connector Type:	USB-B to USB-B	Withstanding voltage:	AC 500V/1 minute
Temperature range:	-20°C ~ +80°C	Salt spray:	48 hr.
Terminal:	Copper alloy, gold plated	Protection class:	IP67 (unmated)
Screw nut:	Zinc alloy, nickel plated	Durability:	1000 times
Mating style:	Screw thread	Current rating:	1.5A
Contact resistance:	$\leq 30M\Omega$	Voltage rating:	30V

Notes

- Please refer to Page 4 for the Conversion between American Wire Gauge AWG and Wire Cross-section mm².
- Please refer to Page 5 for part number breakdown.

USB-A Circular Receptacle Feed Thru

Connector series: USB
Gender: Female
Part No.: IPUSB-*AABHD
*refers to use version (2.0 or 3.0)

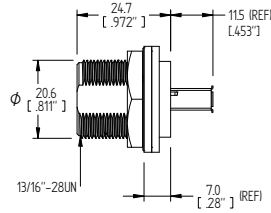
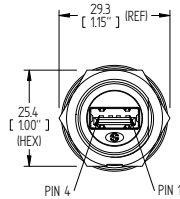

General Information

Connector Type:	USB-A to USB-A
Temperature range:	-20°C ~ +80°C
Terminal:	Copper alloy, gold plated
Screw nut:	Nylon + GF
Mating style:	Screw thread
Contact resistance:	≤ 30MΩ

Withstanding voltage:	AC 500V/1 minute
Salt spray:	48 hr.
Protection class:	IP67 (unmated)
Durability:	1000 times
Current rating:	1.5A
Voltage rating:	30V

USB-A Metal Circular Receptacle Feed Thru

Connector series: USB
Gender: Female
Part No.: IPUSBM-*AABHD
*refers to use version (2.0 or 3.0)

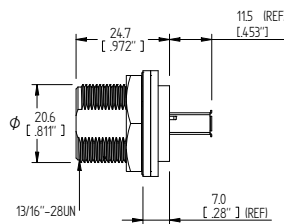
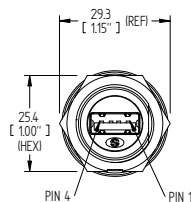

General Information

Connector Type:	USB-A to USB-A
Temperature range:	-20°C ~ +80°C
Terminal:	Copper alloy, gold plated
Screw nut:	Zinc alloy, nickel plated
Mating style:	Screw thread
Contact resistance:	≤ 30MΩ

Withstanding voltage:	AC 500V/1 minute
Salt spray:	48 hr.
Protection class:	IP67 (unmated)
Durability:	1000 times
Current rating:	1.5A
Voltage rating:	30V

Notes

- Please refer to Page 4 for the Conversion between American Wire Gauge AWG and Wire Cross-section mm².
- Please refer to Page 5 for part number breakdown.

USB-A Circular Receptacle to PCB Contacts

Connector series: USB
 Gender: Female
 Part No.: IPUSB-*JAPC
 *refers to use version (2.0 or 3.0)

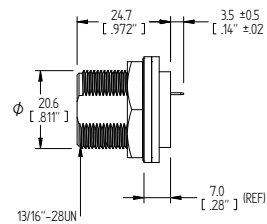
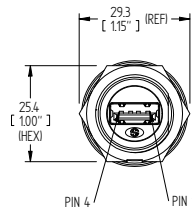

General Information

Connector Type:	USB-A to USB-A	Withstanding voltage:	AC 500V/1 minute
Temperature range:	-20°C ~ +80°C	Salt spray:	48 hr.
Terminal:	Copper alloy, gold plated	Protection class:	IP67 (unmated)
Screw nut:	Nylon + GF	Durability:	1000 times
Mating style:	Screw thread	Current rating:	1.5A
Contact resistance:	≤ 30MΩ	Voltage rating:	30V

USB-A Metal Circular Receptacle to PCB Contacts

Connector series: USB
 Gender: Female
 Part No.: IPUSBM-*JAPC
 *refers to use version (2.0 or 3.0)

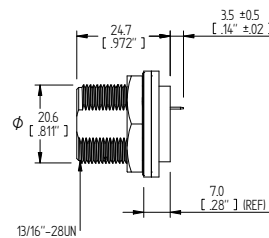
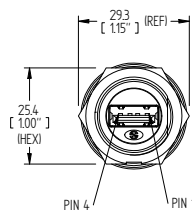

General Information

Connector Type:	USB-A to USB-A	Withstanding voltage:	AC 500V/1 minute
Temperature range:	-20°C ~ +80°C	Salt spray:	48 hr.
Terminal:	Copper alloy, gold plated	Protection class:	IP67 (unmated)
Screw nut:	Zinc alloy, nickel plated	Durability:	1000 times
Mating style:	Screw thread	Current rating:	1.5A
Contact resistance:	≤ 30MΩ	Voltage rating:	30V

Notes

- Please refer to Page 4 for the Conversion between American Wire Gauge AWG and Wire Cross-section mm².
- Please refer to Page 5 for part number breakdown.

USB-A Circular Receptacle to Screw Terminals

Connector series: USB
Gender: Female
Part No.: IPUSB-*ASTB
*refers to use version (2.0 or 3.0)

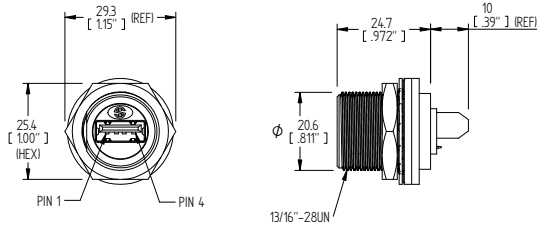

General Information

Connector Type:	USB-A type
Temperature range:	-20°C ~ +80°C
Terminal:	Copper alloy, gold plated
Screw nut:	Nylon + GF
Mating style:	Screw thread
Contact resistance:	≤ 30MΩ

Withstanding voltage:	AC 500V/1 minute
Salt spray:	48 hr.
Protection class:	IP67 (unmated)
Durability:	1000 times
Current rating:	1.5A
Voltage rating:	30V

USB-A Metal Circular Receptacle to Screw Terminals

Connector series: USB
Gender: Female
Part No.: IPUSBM-*ASTB
*refers to use version (2.0 or 3.0)

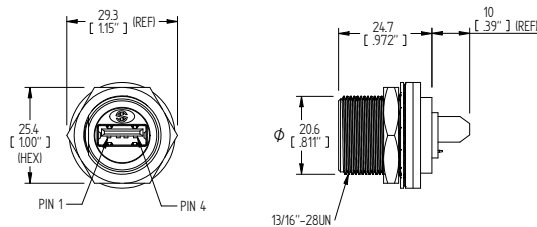

General Information

Connector Type:	USB-A type
Temperature range:	-20°C ~ +80°C
Terminal:	Copper alloy, gold plated
Screw nut:	Zinc alloy, nickel plated
Mating style:	Screw thread
Contact resistance:	≤ 30MΩ

Withstanding voltage:	AC 500V/1 minute
Salt spray:	48 hr.
Protection class:	IP67 (unmated)
Durability:	1000 times
Current rating:	1.5A
Voltage rating:	30V

Notes

- Please refer to Page 4 for the Conversion between American Wire Gauge AWG and Wire Cross-section mm².
- Please refer to Page 5 for part number breakdown.

USB-A Circular Receptacle to Flying Leads

Connector series: USB
 Gender: Female
 Part No.: IPUSB-*JAFL
 *refers to use version (2.0 or 3.0)

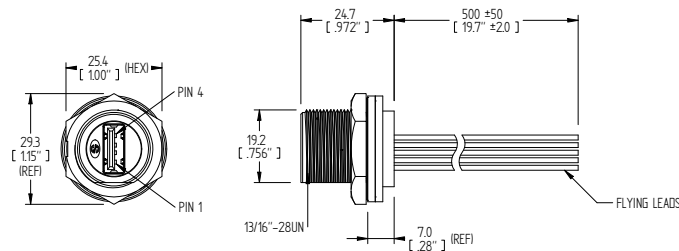

General Information

Connector Type:	USB-A type	Withstanding voltage:	AC 500V/1 minute
Temperature range:	-20°C ~ +80°C	Salt spray:	48 hr.
Terminal:	Copper alloy, gold plated	Protection class:	IP67 (unmated)
Screw nut:	Nylon + GF	Durability:	1000 times
Mating style:	Screw thread	Current rating:	1.5A
Contact resistance:	≤ 30MΩ	Voltage rating:	30V
		Cable length:	500 mm

USB-A Metal Circular Receptacle to Flying Leads

Connector series: USB
 Gender: Female
 Part No.: IPUSBM-*JAFL
 *refers to use version (2.0 or 3.0)

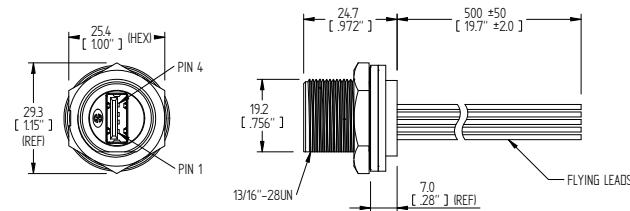

General Information

Connector Type:	USB-A type	Withstanding voltage:	AC 500V/1 minute
Temperature range:	-20°C ~ +80°C	Salt spray:	48 hr.
Terminal:	Copper alloy, gold plated	Protection class:	IP67 (unmated)
Screw nut:	Zinc alloy, nickel plated	Durability:	1000 times
Mating style:	Screw thread	Current rating:	1.5A
Contact resistance:	≤ 30MΩ	Voltage rating:	30V
		Cable length:	500 mm

Notes

- Please refer to Page 4 for the Conversion between American Wire Gauge AWG and Wire Cross-section mm².
- Please refer to Page 5 for part number breakdown.

USB-B Circular Receptacle Feed Thru

Connector series: USB
Gender: Female
Part No.: IPUSB-*BABHD
*refers to use version (2.0 or 3.0)

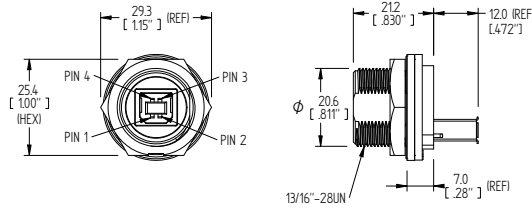

General Information

Connector Type:	USB-B to USB-A	Withstanding voltage:	AC 500V/1 minute
Temperature range:	-20°C ~ +80°C	Salt spray:	48 hr.
Terminal:	Copper alloy, gold plated	Protection class:	IP67 (unmated)
Screw nut:	Nylon + GF	Durability:	1000 times
Mating style:	Screw thread	Current rating:	1.5A
Contact resistance:	≤ 30MΩ	Voltage rating:	30V

USB-B Circular Receptacle to PCB Contacts

Connector series: USB
Gender: Female
Part No.: IPUSB-*JBPC
*refers to use version (2.0 or 3.0)

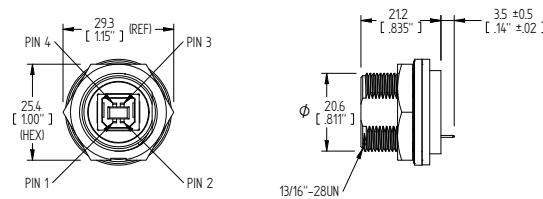

General Information

Connector Type:	USB-B type	Withstanding voltage:	AC 500V/1 minute
Temperature range:	-20°C ~ +80°C	Salt spray:	48 hr.
Terminal:	Copper alloy, gold plated	Protection class:	IP67 (unmated)
Screw nut:	Nylon + GF	Durability:	1000 times
Mating style:	Screw thread	Current rating:	1.5A
Contact resistance:	≤ 30MΩ	Voltage rating:	30V

Notes

- Please refer to Page 4 for the Conversion between American Wire Gauge AWG and Wire Cross-section mm².
- Please refer to Page 5 for part number breakdown.

USB-B Circular Receptacle to Flying Leads

Connector series: USB
 Gender: Female
 Part No.: IPUSB-*JBFL
 *refers to use version (2.0 or 3.0)

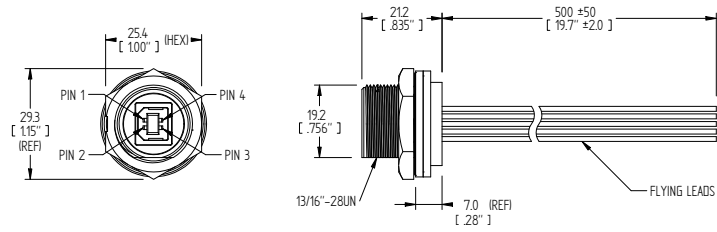

General Information

Connector Type:	USB-B type	Withstanding voltage:	AC 500V/1 minute
Temperature range:	-20°C ~ +80°C	Salt spray:	48 hr.
Terminal:	Copper alloy, gold plated	Protection class:	IP67 (unmated)
Screw nut:	Nylon + GF	Durability:	1000 times
Mating style:	Screw thread	Current rating:	1.5A
Contact resistance:	≤ 30MΩ	Voltage rating:	30V
		Cable length:	500 mm

Notes

- Please refer to Page 4 for the Conversion between American Wire Gauge AWG and Wire Cross-section mm².
- Please refer to Page 5 for part number breakdown.

USB Receptacle Cap

Connector series: USB
Part No.: IPCAP-1316

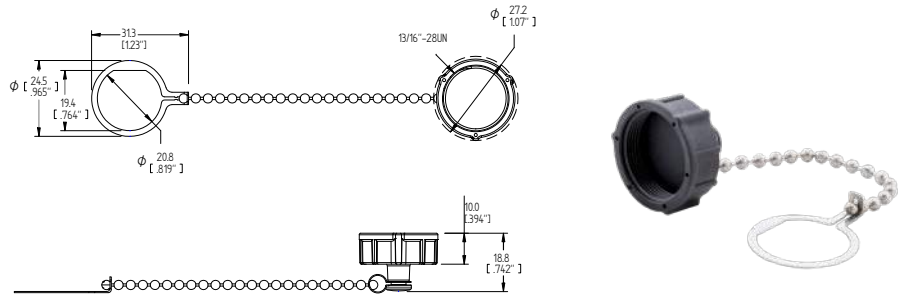

General Information

Temperature range: -40°C ~ +105°C

Material, cap: Nylon, black

Material, holder: Nylon, black

Protection class: IP67

Material, gasket: EPDM, black

Material, chain: Stainless steel

USB Receptacle Metal Cap

Connector series: USB
Part No.: IPCAPM-1316

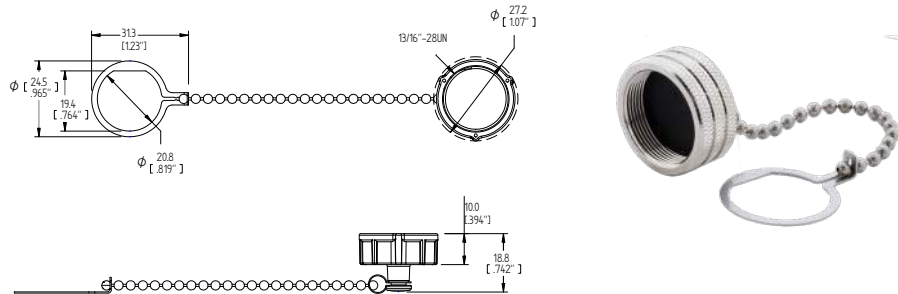

General Information

Temperature range: -40°C ~ +105°C

Material, cap: Copper alloy, nickel plated

Material, holder: Nylon, black

Protection class: IP67

Material, gasket: EPDM, black

Material, chain: Stainless steel

Gasket

Connector series: USB
Part No.: IPGSK-1316

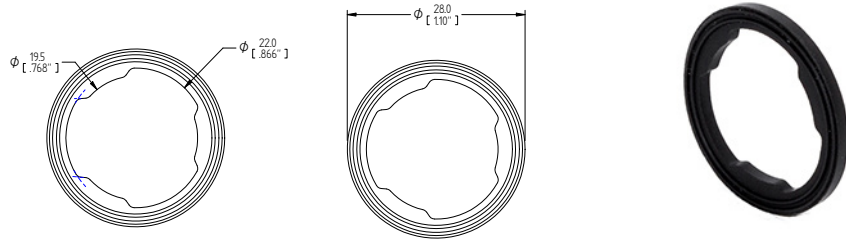

General Information

Material: Silicone (UL94V-0)

Color: Gray

Packaging: Pack of 10

Lock Nut

Connector series: USB
Part No.: IPNT-1316

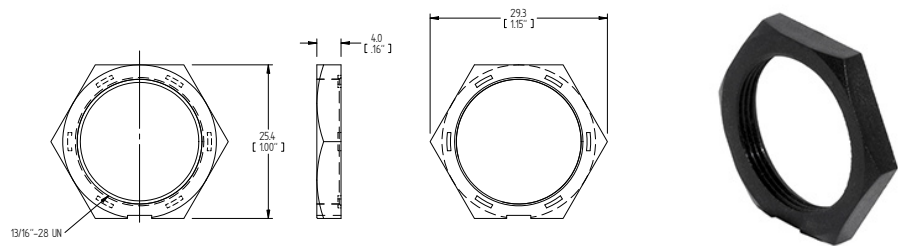

General Information

Material: Nylon

Color: Black

Packaging: Pack of 10

USB PCB Layout

USB-A Type, PCB

USB 2.0

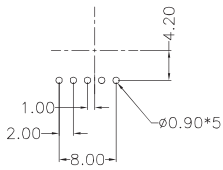

USB 3.0

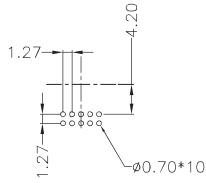

USB 2.0

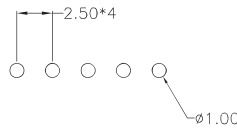

Board In Conn.

USB 3.0

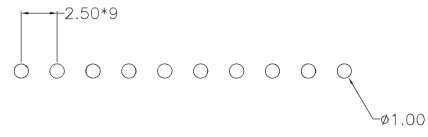

Board In Conn.

USB-B Type, PCB

USB 2.0

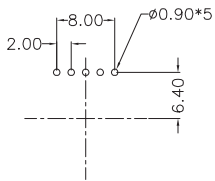

USB 2.0

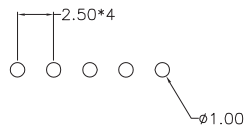

Board In Conn.

Part Numbers

All HDMI Series P/Ns	Catalog Page
IPUSB-2WPAPA-1M	6
IPUSB-2WPAPA-2M	6
IPUSB-2WPAPA-3M	6
IPUSB-3WPAPA-1M	6
IPUSB-3WPAPA-2M	6
IPUSB-3WPAPA-3M	6
IPUSBM-2WPAPA-1M	6
IPUSBM-2WPAPA-2M	6
IPUSBM-2WPAPA-3M	6
IPUSBM-3WPAPA-1M	6
IPUSBM-3WPAPA-2M	6
IPUSBM-3WPAPA-3M	6
IPUSB-2WPAPB-1M	7
IPUSB-2WPAPB-2M	7
IPUSB-2WPAPB-3M	7
IPUSB-3WPAPB-1M	7
IPUSB-3WPAPB-2M	7
IPUSB-3WPAPB-3M	7
IPUSBM-2WPAPB-1M	7
IPUSBM-2WPAPB-2M	7
IPUSBM-2WPAPB-3M	7
IPUSBM-3WPAPB-1M	7
IPUSBM-3WPAPB-2M	7
IPUSBM-3WPAPB-3M	7
IPUSB-2WPAWPA-1M	8
IPUSB-2WPAWPA-2M	8
IPUSB-2WPAWPA-3M	8
IPUSB-3WPAWPA-1M	8
IPUSB-3WPAWPA-2M	8
IPUSB-3WPAWPA-3M	8

All HDMI Series P/Ns	Catalog Page
IPUSBM-2WPAWPA-1M	8
IPUSBM-2WPAWPA-2M	8
IPUSBM-2WPAWPA-3M	8
IPUSBM-3WPAWPA-1M	8
IPUSBM-3WPAWPA-2M	8
IPUSBM-3WPAWPA-3M	8
IPUSB-2WPAWPB-1M	9
IPUSB-2WPAWPB-2M	9
IPUSB-2WPAWPB-3M	9
IPUSB-3WPAWPB-1M	9
IPUSB-3WPAWPB-2M	9
IPUSB-3WPAWPB-3M	9
IPUSB-2WPBWPB-1M	9
IPUSB-2WPBWPB-2M	9
IPUSB-2WPBWPB-3M	9
IPUSB-3WPBWPB-1M	9
IPUSB-3WPBWPB-2M	9
IPUSB-3WPBWPB-3M	9
IPUSBM-2WPBPA-1M	10
IPUSBM-2WPBPA-2M	10
IPUSBM-2WPBPA-3M	10
IPUSBM-3WPBPA-1M	10
IPUSBM-3WPBPA-2M	10
IPUSBM-3WPBPA-3M	10
IPUSBM-2WPBPB-1M	10
IPUSBM-2WPBPB-2M	10
IPUSBM-2WPBPB-3M	10
IPUSBM-3WPBPB-1M	10
IPUSBM-3WPBPB-2M	10
IPUSBM-3WPBPB-3M	10

All HDMI Series P/Ns	Catalog Page
IPUSB-2WJAPA-1M	11
IPUSB-2WJAPA-2M	11
IPUSB-2WJAPA-3M	11
IPUSB-3WJAPA-1M	11
IPUSB-3WJAPA-2M	11
IPUSB-3WJAPA-3M	11
IPUSBM-2WJAPA-1M	11
IPUSBM-2WJAPA-2M	11
IPUSBM-2WJAPA-3M	11
IPUSBM-3WJAPA-1M	11
IPUSBM-3WJAPA-2M	11
IPUSBM-3WJAPA-3M	11
IPUSB-2WJAPB-1M	12
IPUSB-2WJAPB-2M	12
IPUSB-2WJAPB-3M	12
IPUSB-3WJAPB-1M	12
IPUSB-3WJAPB-2M	12
IPUSB-3WJAPB-3M	12
IPUSBM-2WJAPB-1M	12
IPUSBM-2WJAPB-2M	12
IPUSBM-2WJAPB-3M	12
IPUSBM-3WJAPB-1M	12
IPUSBM-3WJAPB-2M	12
IPUSBM-3WJAPB-3M	12
IPUSB-2WJAWPA-1M	13
IPUSB-2WJAWPA-2M	13
IPUSB-2WJAWPA-3M	13
IPUSB-3WJAWPA-1M	13
IPUSB-3WJAWPA-2M	13
IPUSB-3WJAWPA-3M	13

All HDMI Series P/Ns	Catalog Page
IPUSBM-2WJAWPA-1M	13
IPUSBM-2WJAWPA-2M	13
IPUSBM-2WJAWPA-3M	13
IPUSBM-3WJAWPA-1M	13
IPUSBM-3WJAWPA-2M	13
IPUSBM-3WJAWPA-3M	13
IPUSBM-2WJAWPB-1M	14
IPUSBM-2WJAWPB-2M	14
IPUSBM-2WJAWPB-3M	14
IPUSBM-3WJAWPB-1M	14
IPUSBM-3WJAWPB-2M	14
IPUSBM-3WJAWPB-3M	14
IPUSBM-2WJBPA-1M	14
IPUSBM-2WJBPA-2M	14
IPUSBM-2WJBPA-3M	14
IPUSBM-3WJBPA-1M	14
IPUSBM-3WJBPA-2M	14
IPUSBM-3WJBPA-3M	14
IPUSBM-2WJBPB-1M	15
IPUSBM-2WJBPB-2M	15
IPUSBM-2WJBPB-3M	15
IPUSBM-3WJBPB-1M	15
IPUSBM-3WJBPB-2M	15
IPUSBM-3WJBPB-3M	15
IPUSBM-2WJBWPA-1M	15
IPUSBM-2WJBWPA-2M	15
IPUSBM-2WJBWPA-3M	15
IPUSBM-3WJBWPA-1M	15
IPUSBM-3WJBWPA-2M	15
IPUSBM-3WJBWPA-3M	15
IPUSBM-2WJBWPB-1M	16
IPUSBM-2WJBWPB-2M	16

All HDMI Series P/Ns	Catalog Page
IPUSBM-2WJBWPB-3M	16
IPUSBM-3WJBWPB-1M	16
IPUSBM-3WJBWPB-2M	16
IPUSBM-3WJBWPB-3M	16
IPUSB-2AABHD	17
IPUSB-3AABHD	17
IPUSBM-2AABHD	17
IPUSBM-3AABHD	17
IPUSB-2JAPC	18
IPUSB-3JAPC	18
IPUSBM-2JAPC	18
IPUSBM-3JAPC	18
IPUSB-2ASTB	19
IPUSB-3ASTB	19
IPUSBM-2ASTB	19
IPUSBM-3ASTB	19
IPUSB-2JAFL	20
IPUSB-3JAFL	20
IPUSBM-2JAFL	20
IPUSBM-3JAFL	20
IPUSB-2BABHD	21
IPUSB-3BABHD	21
IPUSB-2JBPC	21
IPUSB-3JBPC	21
IPUSB-2JBFL	22
IPUSB-3JBFL	22
IPCAP-1316	23
IPCAPM-1316	23
IPGSK-1316	24
IPNT-1316	24



Corporate Headquarters, Philadelphia, PA



European Headquarters & Production Facility, Southampton, UK



Production Facility, Zhuhai, China



North American Production Facility, South Bend, IN



FilConn, Chandler, AZ



PEI-Genesis has sales offices throughout the Americas, Europe and Asia.
Visit www.peigenesis.com, call +1 800.675.1214 (North America), +44 (0) 23 8062 1260 (Europe),
+86 756 7683 088 (Asia), +1 631.475.5050 (Rest of World), or email: sales@peigenesis.com.

www.peigenesis.com | www.peigenesis.cn

