

SECTION B-B

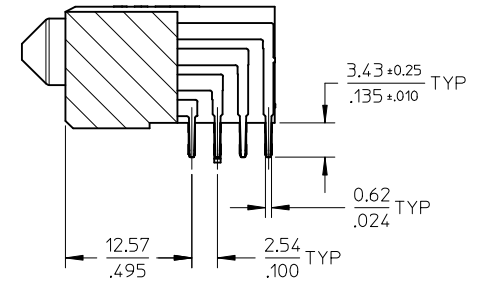
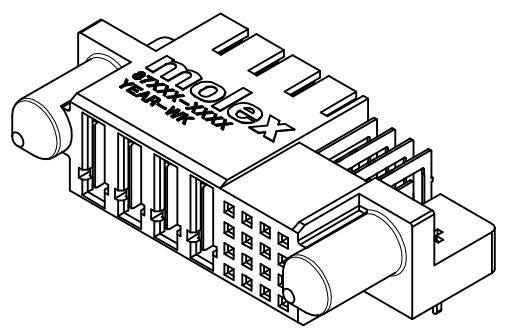
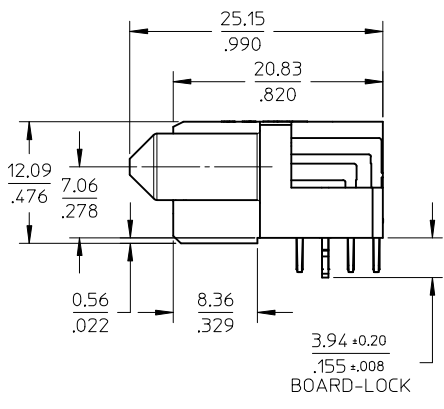

SECTION A-A

REVISED EC NO: S2014-0060 DRWN:SKANG CHKD:MLONG APPR:MLONG 2013/07/22 2013/09/06 2013/09/09	QUALITY SYMBOLS $F_A=0$ $F_G=0$ $F_P=0$	GENERAL TOLERANCES (UNLESS SPECIFIED)		DIMENSION STYLE MM/IN		SCALE NTS	DESIGN UNITS METRIC	THIRD ANGLE PROJECTION		
				DRAWN BY BHLOW	DATE 2003/04/24	TITLE POWER CONN RECEPTACLE 5.08MM VERSION S-P(B), R/A, T/H				
				CHECKED BY PTLIM	DATE 2003/05/06	DOCUMENT NO. SD-87808-001				
				APPROVED BY SKTOH	DATE 2003/05/07	SHEET NO. 1 OF 2				
B1	REV	DRAFT WHERE APPLICABLE MUST REMAIN WITHIN DIMENSIONS		MATERIAL NO. SEE TABLE	THIS DRAWING CONTAINS INFORMATION THAT IS PROPRIETARY TO MOLEX INCORPORATED AND SHOULD NOT BE USED WITHOUT WRITTEN PERMISSION					

ASSEMBLY PART NUMBER	P-S CONFIGURATION		RECESSED POWER CIRCUIT #	DIM A	DIM B	DIM C	DIM D	DIM E	DIM H	DIM H1	DIM F	DIM F1	PACKAGING
	POWER BETA	SIGNAL											
87808-3001	6	16	NIL	58.42 2.300	50.80 2.000	49.53 1.950	27.94 1.100	7.62 .300	6.98 .275	6.35 .250	5.08 .200	5.72 .225	TRAY
87808-3003	6	24	NIL	63.51 2.500	55.81 2.200	54.61 2.150	27.94 1.100	12.70 .500	6.98 .275	6.35 .250	5.08 .200	5.72 .225	TRAY

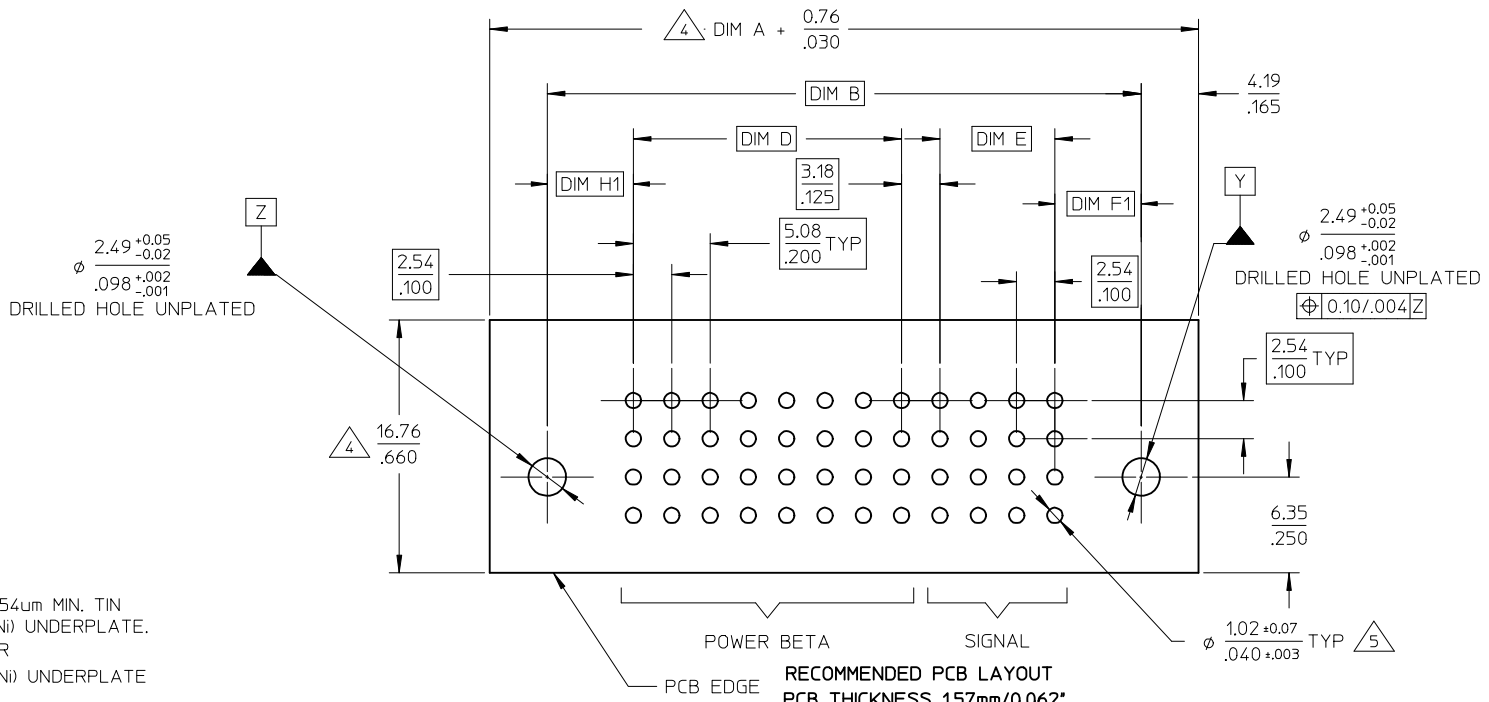

NOTES

- MATERIALS :
HOUSING - LCP, GLASS FILLED, UL94V-0,
COLOR : BLACK,
SIGNAL TERMINAL - COPPER ALLOY
POWER TERMINAL - COPPER ALLOY
BOARD-LOCK - COPPER ALLOY
- FINISH :-
SIGNAL & POWER CONTACTS
0.76um MIN. GOLD (Au) AT CONTACT AREA AND 2.54um MIN. TIN
AT SOLDER TAIL AREA OVER 1.27um MIN. NICKEL (Ni) UNDERPLATE.
BOARD-LOCK - 2.54 MICROMETER MINIMUM TIN OVER
1.27 MICROMETER MINIMUM NICKEL (Ni) UNDERPLATE
- PRODUCT SPECIFICATION : PS-87805-006
 - COMPONENT STAY AWAY ZONE FROM CONNECTOR.
 - PCB NOTE FOR DIAMETER 1.02/.040 PLATED HOLE
 - DRILLED HOLE SIZE IS 1.151/.0453
 - PLATE WITH 0.007/.0003 MINIMUM TIN OVER 0.03/.001 TO 0.08/.003 COPPER PLATING TO ACHIEVE 1.02+0.08/.040+0.003 HOLE.
 - ALL TERMINAL TIPS ARE DESIGNED WITH EXPOSE BASE COPPER.
THIS IS CREATED BY FINAL CUTTING PROCESS.
 - MANUFACTURER LOGO, PART NUMBER AND YEAR-WEEK CODE.
 - 4 POWER BETA - 16 SIGNAL IS SHOWN FOR ILLUSTRATION.
POWER-SIGNAL CONFIGURATION IS AVAILABLE UP TO 203MM/8INCH.
PLEASE CONTACT MOLEX SALES PERSONNEL FOR OTHER CONFIGURATION AND OPTION NEEDED.

REVISED	EC NO: S2014-0060	DRW:SKANG	CHKD:MLONG	APPR:MLONG	REV	DESCRIPTION	QUALITY SYMBOLS	GENERAL TOLERANCES (UNLESS SPECIFIED)		DIMENSION STYLE		SCALE	DESIGN UNITS	THIRD ANGLE PROJECTION			
								mm	INCH	MM/IN	NTS	METRIC	DATE	DATE	DATE	DATE	
B1							$F_A=0$ $F_E=0$ $F_F=0$	4 PLACES ± --- ± --- 3 PLACES ± --- ± .010 2 PLACES ± 0.25 ± --- 1 PLACE ± --- ± --- 0 PLACE ± ±	mm INCH	MM/IN	DATE 2003/04/24	DATE 2003/05/06	DATE 2003/05/07	DATE 2003/05/07	TITLE POWER CONN RECEPTACLE 5.08MM VERSION S-P(B), R/A, T/H molex	DOCUMENT NO. SD-87808-001	SHEET NO. 2 OF 2
DRAFT WHERE APPLICABLE MUST REMAIN WITHIN DIMENSIONS								ANGULAR ± 3 °		SEE TABLE		THIS DRAWING CONTAINS INFORMATION THAT IS PROPRIETARY TO MOLEX INCORPORATED AND SHOULD NOT BE USED WITHOUT WRITTEN PERMISSION					