

PART NUMBER	REV	FIRST USED	TERMINATOR	FEED TYPE	DESCRIPTION
1339690-1	B		BENCH & LEADMAKER	MECH POST FEED	HD-I APPLICATOR
7-1339690-1	B		BENCH & LEADMAKER	MECH POST FEED	-1 AND SPARE PARTS
7-1339690-7	B				SPARE PARTS KIT

CRIMP DATA AMP TERMINAL AMP CRIMP SPECS

TERMINAL NAME: CLIP 8MM (GAMME 2) RECEPTACLE

CRIMP	SIZE	TYPE	RANGE
WIRE	3.99 [.157 IN]	F	3.00mm ² - 6.00mm ²
INSUL	5.49 [.216 IN]	F	3.20-4.40 [.126-.173 IN]
WIRE STRIP LENGTH		APPL INSTRUCTION	
6.00-6.80 [.236-.268 IN]		408-8323	

TERMINAL	C1544141 /	FEED
APPL SPEC	PRONER DRG.10225	29.00 [.1142 IN]

TERMINALS APPLIED

1544141				
-	-	-	-	-
-	-	-	-	-
-	-	-	-	-
-	-	-	-	-
-	-	-	-	-
-	-	-	-	-
-	-	-	-	-
-	-	-	-	-
-	-	-	-	-
-	-	-	-	-

WIRE SIZE	CRIMP HEIGHT	PIN PN AND LENGTH [IN]
5.00mm ²	2.95 ±0.05 [.116 ±.002 IN]	3-354779-2 [.3150]
3.00mm ²	2.60 ±0.05 [.102 ±.002 IN]	6-354779-0 [.3290]

LAYOUT	SET UP GAGE
L1339690	458638-3

- ▲ RECOMMENDED SPARE PARTS.
- 2. GREASE RAM, CAM, CAM FOLLOWER AND FEED ROD LIGHTLY.
- 3. LUBRICATE DAILY PER THE APPLICATOR INSTRUCTION SHEET SUPPLIED WITH THE APPLICATOR.
- ▲ CERTAIN TERMINALS REQUIRE LUBRICATION. REFER TO THE APPLICATOR INSTRUCTION SHEET FOR MORE INFORMATION.
- ▲ WIRE RANGE SHOWN IS THAT OF THE TERMINAL.
- ▲ CUT TO LENGTH AT ASSEMBLY.
- ▲ SEE C1544141 / PRONER DRG. 10225 FOR SPECIFIC WIRE DETAILS.
- ▲ TENSILE VALUES COMPLY WITH IEC 60352-2 AND PSA STANDARD BS217050 AND NOT TO THAT SHOWN ON PRONER DRG. 10225.
- ▲ INSULATION RANGE SHOWN IS THAT OF THE APPLICATOR. INSULATION BARREL CRIMP HEIGHTS MAY NOT MEET WITH SIZES SHOWN ON PRONER DRG. 10225 AND MUST BE < 8.00MM TO FIT HOUSING 8.2MM HIGH.

VIEW B ROTATED 180°

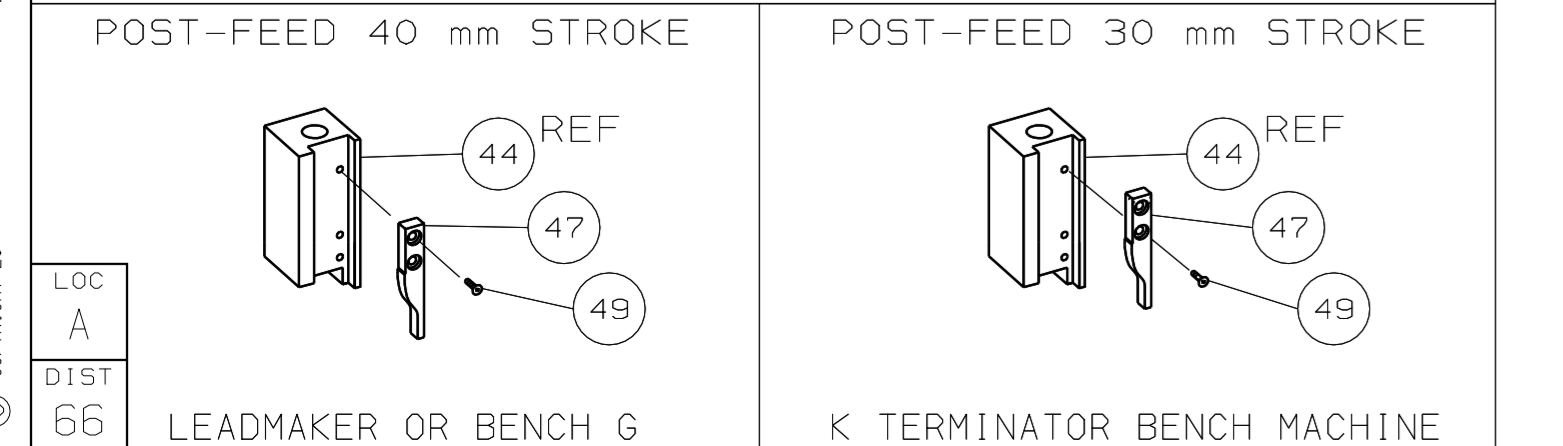

LOC A, DIST 66, LEADMAKER OR BENCH G, K TERMINATOR BENCH MACHINE

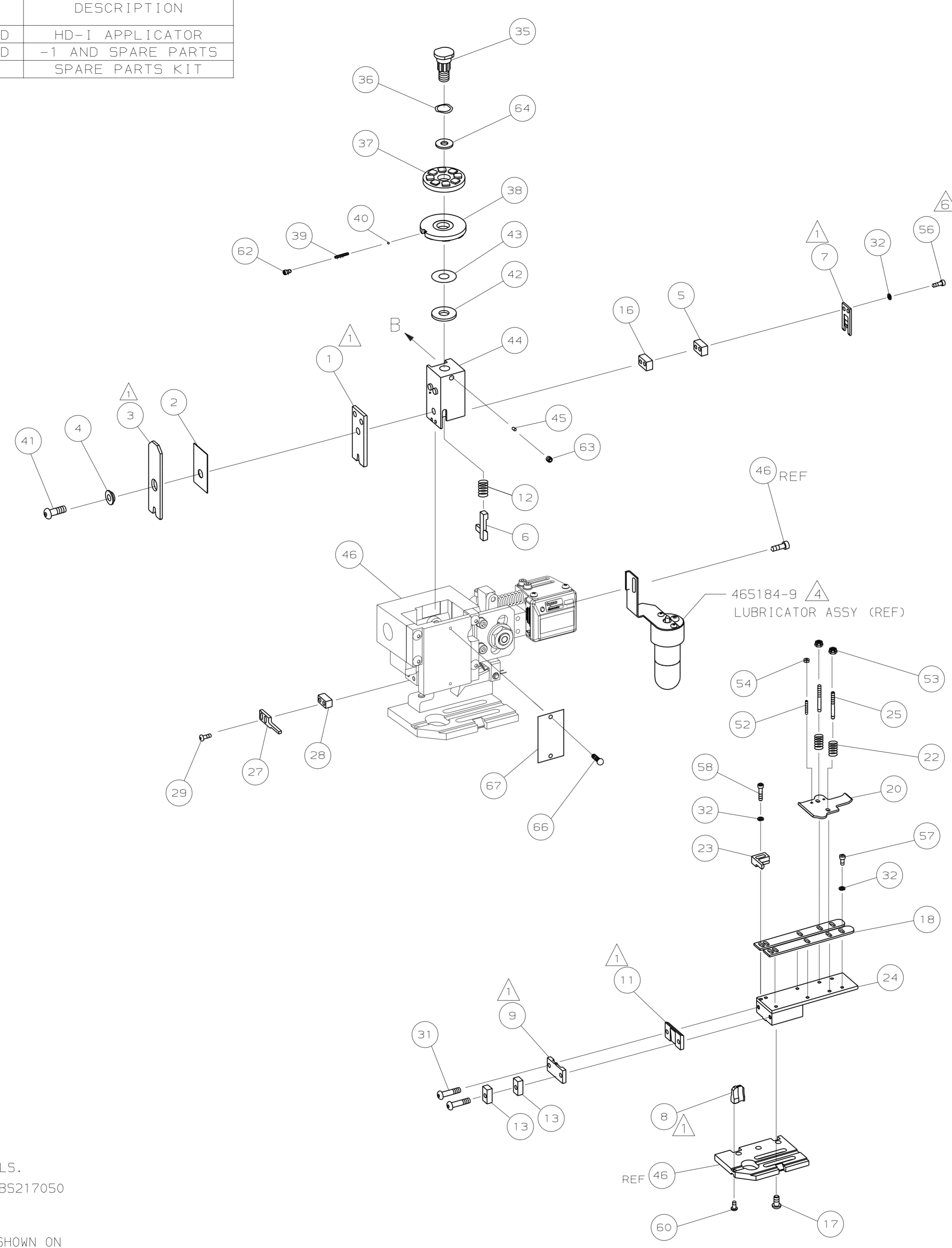

QTY	REV	REV	REV	PART NO	DESCRIPTION	ITEM NO
-	1	1		1339690	PRINT, APPLICATOR LOG SHEET	73
-	1	1		1338705-2	DOCUMENTATION PACKAGE	72
						70
						68
-	1	1		461264-1	PLATE, IDENTIFICATION	67
-	2	2		21017-2	SCR,DRIVE (#2X.19) ID PLATE	66
						65
-	1	1		986950-1	WASHER, FLAT PRECISION	64
-	1	1		3-18031-0	SCR,SKT SET (M6X6) RAM	63
-	1	1		18023-9	SCR,SKT CAP (M4X6) CP DSC	62
						61
-	1	1		18024-7	SCR,BHC (M4X10) ANVIL	60
						59
-	2	2		1-18023-4	SCR,SHC (M4X20) HOLD DOWN	58
-	5	5		1-18023-0	SCR,SHC (M4X8) STRIP GUIDE	57
-	2	2		1-18023-4	SCR,SHC (M4X20) SLUG BLADE	56
						55
-	2	2		18029-1	NUT, HEX (M3) DRAG	54
-	2	2		986965-1	NUT, HEX SL (M4) DRAG STUD	53
-	2	2		2-18032-2	SCR,SKT SET (M3X10) DRAG	52
						51
						50
-	1	1		18024-3	SCR,BHC (M3X10) CAM	49
						48
-	1	1		1338676-1	CAM, POST-FEED 30 & 40 mm ST	47
-	1	1		1338662-2	APPLICATOR, BASIC (SUBASSY)	46
-	1	1		690191-1	PLUG, NYLON	45
-	1	1		1320998-1	RAM	44
-	1	1		690125-1	WASHER, LAMINATED	43
-	1	1		690124-1	WASHER, RAM	42
-	1	1		2-18024-6	SCREW,BHC (M8X25) CRIMPER	41
-	1	1		23241-1	BALL, STEEL	40
-	1	1		2-22278-7	SPRING, COMPRESSION	39
-	1	1		1320922-1	DISC, INSULATION	38
-	1	1		354777-1	WIRE DISC, PLASTIC	37
-	1	1		22480-5	WASHER, SPRING	36
-	1	1		690212-1	POST, RAM	35
						34
						33
-	9	9		18025-2	WASHER, LOCK (M4) SHEAR BL	32
-	2	2		4-18024-7	SCR,BHC (M4X25) SHEAR PL	31
						30
-	2	2		18024-8	SCR,BHC (M4X12) STRIPPER	29
-	1	1		3-690451-7	SPACER, STRIPPER	28
-	1	1		690455-7	STRIPPER	27
						26
-	2	2		1320906-1	DRAG, STUD	25
-	1	1		2-1320995-3	PLATE, STRIP GUIDE	24
-	1	1		240825-5	PLATE, STRIP HOLD DOWN	23
-	2	2		3-22281-6	SPRING, DRAG	22
						21
-	1	1		1338665-1	DRAG, STOCK	20
						19
-	2	2		1338663-8	GUIDE, LOWER STRIP	18
-	4	4		1-18024-8	SCR,BHC (M6X12) STRIP GD PL	17
-	1	1		1338708-1	SPACER, SLUG BLADE	16
						15
						14
-	2	2		2-690481-0	SPACER, HOLD DOWN	13
-	1	1		23846-1	SPRING, HOLD DOWN	12
▲	-	1	1	240833-2	PLATE, REAR SHEAR	11
						10
▲	-	1	1	3-690495-7	PLATE, FRONT SHEAR	9
▲	1	2	1	1-1333226-0	ANVIL	8
▲	-	1	1	3-690474-0	BLADE, SLUG	7
▲	-	1	1	2-455892-9	HOLD DOWN, TERMINAL	6
-	1	1		5-240641-7	SPACER, SLUG BLADE	5
-	1	1		2-238009-9	SPACER, BLOCK CRIMPER	4
▲	1	2	1	1-1633471-0	CRIMPER, INSULATION	3
▲	-	1	1	1-455888-5	SPACER, CRIMPER	2
▲	1	2	1	9-1490019-4	CRIMPER, WIRE	1

QTY REQD PER ASSY	REVISION OF EACH ASSY NO (WHEN BLANK, USE DWG REVISION)
-77	-71

DIMENSIONS: mm [INCHES]		MATL	HT TR	FIN
DO NOT SCALE PRINT.				
TOLERANCES UNLESS OTHERWISE SPECIFIED:				
1	PLC DEC ±			
2	PLC DEC ±			
3	PLC DEC ±			
ANGLES ±				
SURF TEXTURE: ✓				
REMOVE BURRS, BREAK SHARP EDGES RO.38 MAX				
DR L.L.OFTHOUSE		26JAN06	APP M.CLIFFORD	26JAN06
CHK -		REL 25MAY06	L.L.OFTHOUSE	
NAME		END FEED HD-I APPLICATOR		MACHINE REF
SCALE		DWG NO 1339690		HD-I APPL
CAGE CODE 00779		CUSTOMER AND ASSEMBLY DRAWING		SHEET 1 OF 1